

## Accumulator Shift Valve

### 63940-03K

1 Shift Valve  
1 O-Ring  
1 Spring

**Note:** Replaces early or late OEM line-ups in most valve bodies. Some late valve bodies do not have an accumulator shift valve.

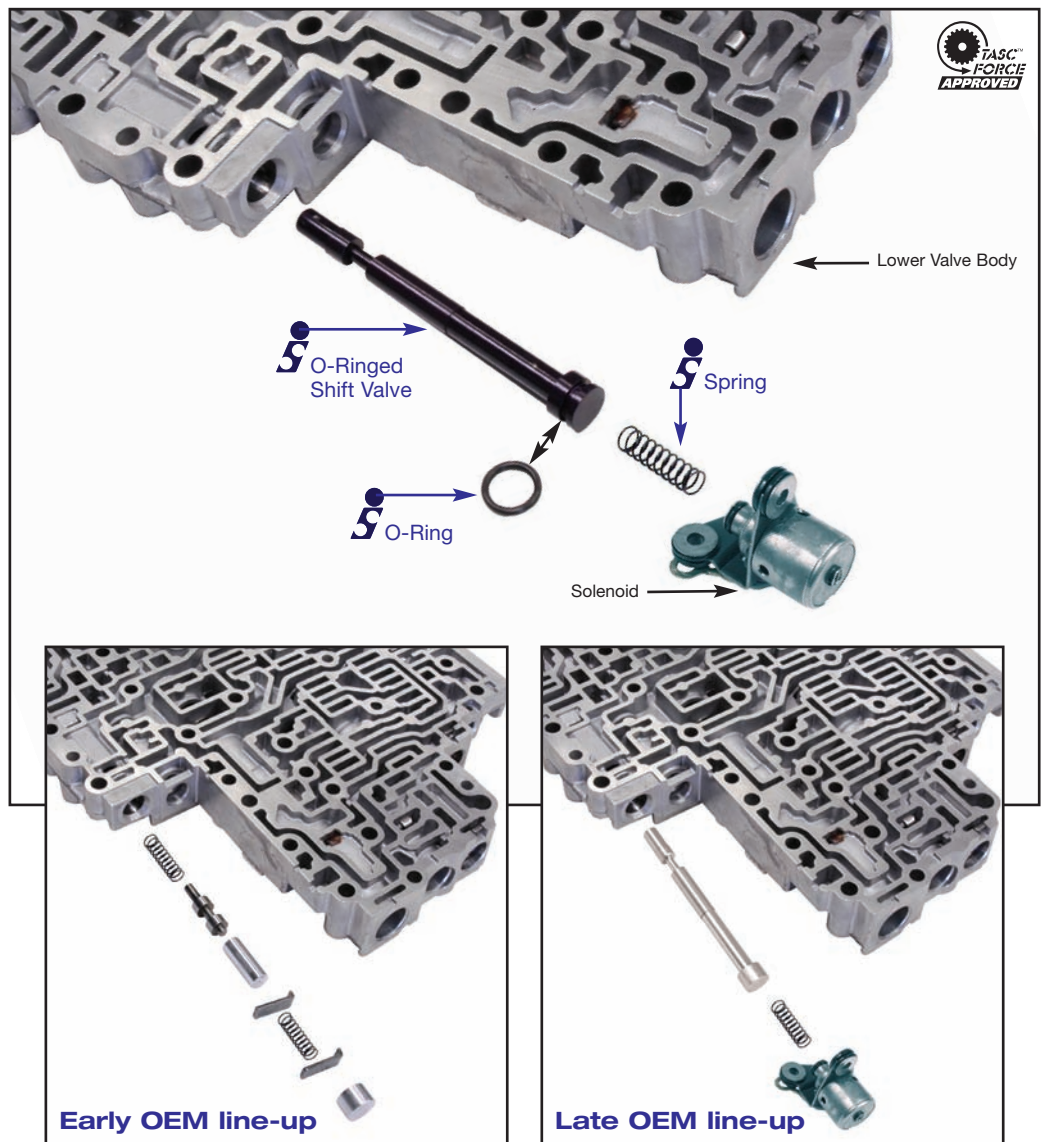

### INSTRUCTIONS

#### Accumulator Shift Valve

1. Remove all components from the bore. Refer to the illustration for details.
2. Keep the solenoid. Discard all other bore components.
3. Insert the o-ring into the valve groove. Lubricate with assembly gel.
4. Push the o-ringed valve into the bore until it bottoms.
5. Reinstall the new spring.