

Chrysler 42RE, 42RH, 44RE, 44RH, 46RE, 46RH, 47RE, 47RH, 48RE, A727, A904

Reverse Servo Piston Plug Kit

Part No.

22912-01K

- Plug
- O-Ring
- Retaining Ring

NOTE: Does not fit '73-earlier.

NOTE: The tip of Sonnax piston plug must be cut off when used in anything other than 47RH/RE (A618) or 48RE applications. Failure to modify the plug will result in incorrect Reverse servo assembly height, resulting in no movement and/or burned Reverse band.

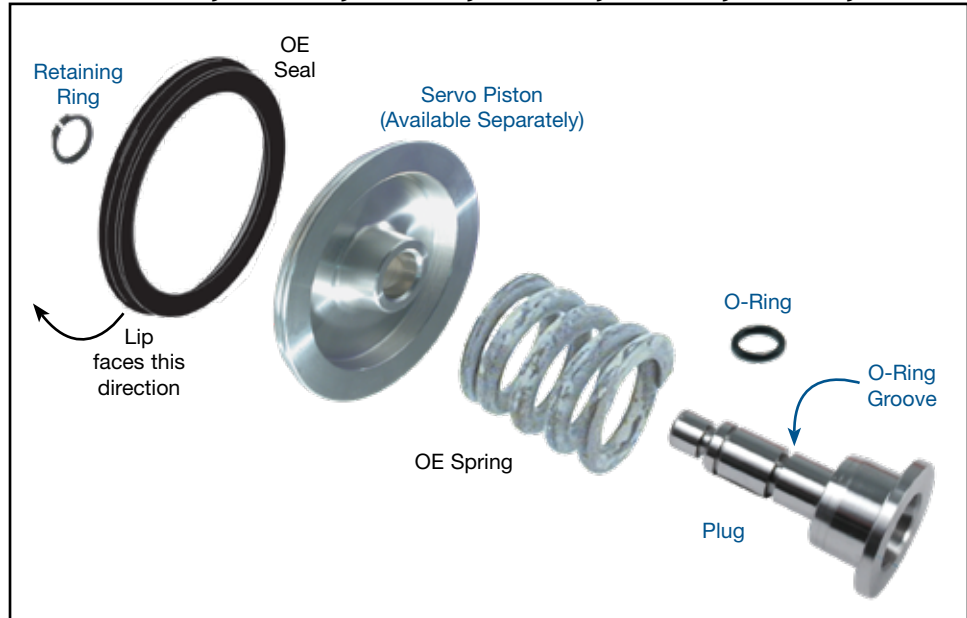

1. Disassembly

- Remove and discard OE plug.
- Examine the servo piston bore for wear and replace if necessary.

2. Installation & Assembly

NOTE: If installing in 47RH/RE (A618) or 48RE application, no modification is necessary. Proceed to "Step C".

If installing in 40RH, 42RH, 42RE, 44RE (A500), 46RH/RE (A518), 36RH, 37RH (A727), or 30RH (A904) applications, the tip of the replacement plug **MUST** be cut off. Proceed to "Step A".

- At the indicated groove, use a band saw or hack saw to cut off the plug tip (**Figures 1, 2 & 3**).
- The small .010" step and any remaining cut-off burrs should be ground off flush to the new plug end to ensure proper travel and setup. Failure to remove burrs and grind flush can lead to contamination problems and difficulty establishing correct servo assembly height (**Figure 1**).
- Install the O-ring in the indicated plug groove and lubricate with assembly lube.
- Reassemble OE spring, piston and O-ringed plug using main photo as orientation guide.
- Use the included heavy-duty retaining ring to secure the O-ringed plug to the piston.
- Band and servo travel should be readjusted to OE specifications.

