

Outer Pressure Regulator Sleeve

Part No.
68942-06



NOTE: Fits bores containing OE pressure regulator valve with .512" dia. spool only.

WARNING: Repairs outer bore only. See Sonnax oversized pressure regulator valve kit **68942-07K** for full bore repair.

Tool Kit

Part No.
F-68942-TL6



- Reamer
- Reamer Jig
- Guide Pin

NOTE: Sonnax "F-Tool" kits designed to service a specific bore require the VB-FIX, a self-aligning valve body reaming fixture. More information and instructions can be found online at www.sonnax.com.

WARNING: Required tool kit **F-68942-TL6** is no longer in production. Check with your distributor for availability.

Mercedes 722.6

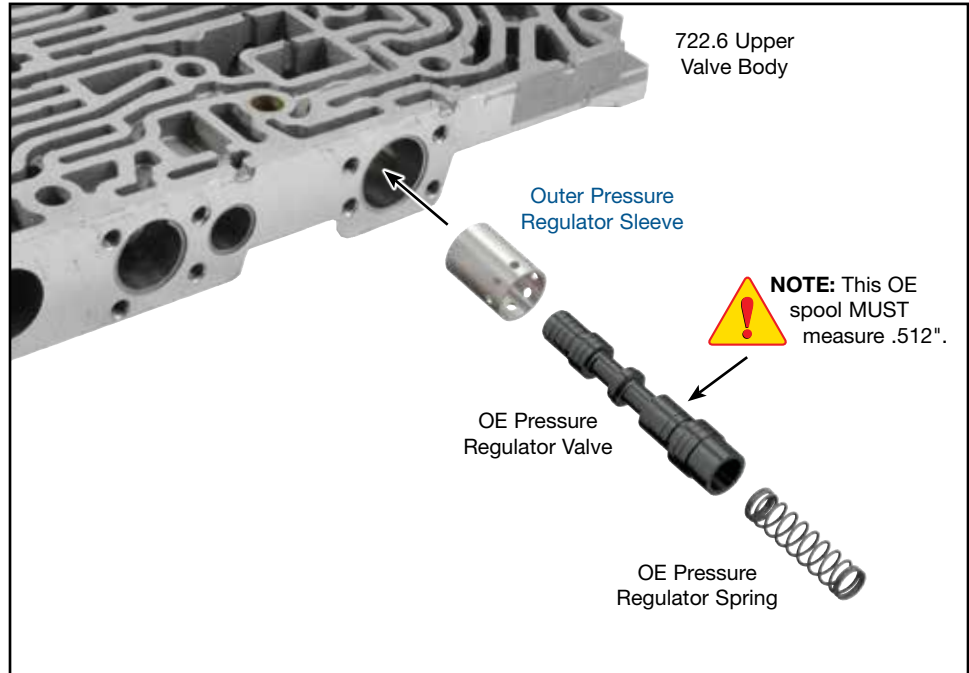

1. Disassembly

Remove OE pressure regulator retainer, spring and valve. Set aside for reuse.

2. Bore Reaming

Ream pressure regulator bore (for reaming instructions/reamer care, please visit www.sonnax.com). Sonnax reaming tool kit **F-68942-TL6** and **VB-FIX** are required for this operation.

3. Installation & Assembly

- Be certain all debris has been removed from the valve bore and valve body.
- Install Sonnax sleeve until it is flush with outer bore surface.
- Reinstall OE pressure regulator valve.
- Reinstall OE spring and secure with OE retainer plate.

4. Final Testing

Vacuum testing at the port(s) indicated holds the recommended minimum 18 in.-Hg.

