



# CHRYSLER 46RE, 46RH, 47RE, 47RH ZIP KIT®

PART NUMBER 46-47RHE-ZIP

QUICK GUIDE

Parts are labeled here in order of installation. See other side of sheet for details on kit contents.

## INSTALLATION DIAGRAM

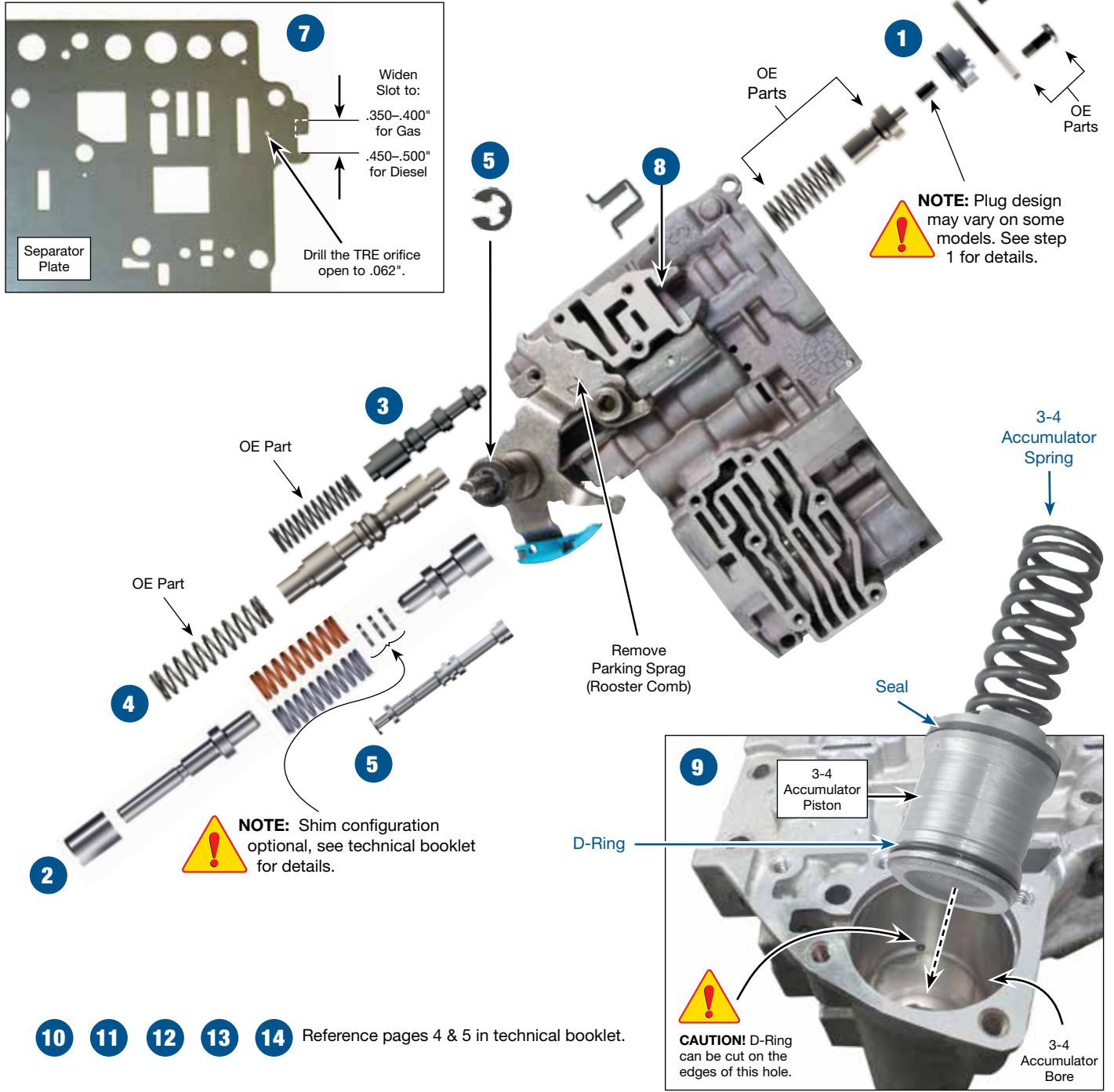
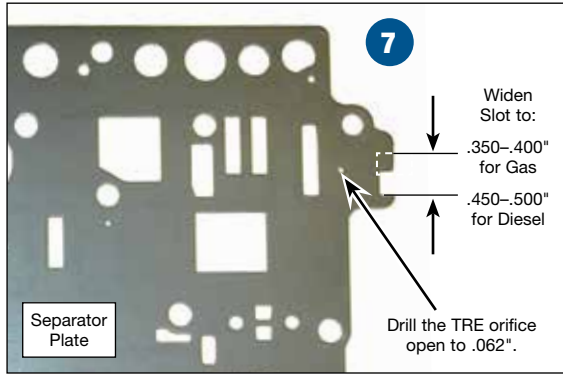

In addition to general rebuilding tips and technical information, the technical booklet included in this kit contains vacuum testing and additional repair options for higher mileage units or for repairing specific complaints which are beyond the scope of this kit.

## Kit Contents & Installation Steps

### Step 1 Replace Line Pressure Plug & Sleeve

Components provided are designed to replace an OE 3-piece line pressure plug and sleeve arrangement. If an OE 2-piece design is found during disassembly, alternative components (not included) may be required.

Place O-ring into sleeve groove. Lubricate with Sonnax Slippery Stick **O-LUBE** and roll on bench to size. Push Sonnax sleeve into bore, O-ringed end first. Insert plug into sleeve. Reinstall OE end plate, tightening screws to 35 in-lbs.

#### Packaging Pocket 1

- Plug • Sleeve • O-Rings (2) 1 Extra

### Step 2 Remove Parking Sprag & Throttle Pressure Adjusting Screw Bracket & Install Throttle Valve Lineup



**NOTE:** For helpful hints and details on this step, reference page 2 in technical booklet.

#### Packaging Pocket 2

- Throttle Valve • Throttle Plunger • Sleeve • Shims (3) • Spring

### Step 3 Replace 4-Spooled Switch Valve



**NOTE:** Part will only fit units with 4-spool switch valve. Reference page 2 of technical booklet for identification.

#### Packaging Pocket 3

- Switch Valve

### Step 4 Replace Pressure Regulator Valve



**NOTE:** Sonnax pressure regulator valve allows converter charge in Park. **CAUTION:** Verify casting wall at pressure regulator valve has not been drilled with line-to-lube hole. See pages 2 and 3 of technical booklet.

#### Packaging Pocket 4

- Pressure Regulator Valve

### Step 5 Replace Manual Valve, Reinstall Throttle Pressure Adjusting Screw Bracket & Parking Sprag



**NOTE:** Reference page 3 of technical booklet for helpful hints on OE parking sprag, bracket and spring reinstallation.

#### Packaging Pocket 5

- Manual Valve • E-Ring

### Step 6 Adjust Pressure Regulator Spring & Set Throttle Lever Stop



**NOTE:** Reference page 3 of technical booklet for details.

### Step 7 Separator Plate Modifications

Drill 'TRE' orifice to .062". Using Dremel®, open exhaust port/slot to .350–.400" for gas or .450"–.500" for diesel. The wider the slot, the faster the release oil exhausts and a firmer apply is felt.

#### Packaging Pocket 6

- Drill Bit, .062" dia. (*not shown*)

### Step 8 Replace Boost Valve Retainer

#### Packaging Pocket 7

- Retainer

### Step 9 Replace 3-4 Accumulator Spring & Seals

Remove and discard OE accumulator spring and seals. Install Sonnax scarf-cut seal in groove at open end of OE piston. Install Sonnax D-Ring in groove at closed end of OE piston. Reinstall piston, closed end first into casting bore. Install Sonnax spring and return cover plate and screws, torquing to 35 in-lbs.



**CAUTION:** D-Ring can be easily cut on sharp casting bore opening.

#### Packaging Pocket 8

- Spring • Seal • D-Ring

### Step 10 Replace Checkballs

Reference page 4 in technical booklet for proper checkball locations.

#### Packaging Pocket 9

- 3/16" Checkball • 1/4" Checkballs (8) • 11/32" Checkball

### Step 11 Replace Intermediate Shaft Pilot & End Plug

Reference pages 4 and 5 in technical booklet for installations tips.

#### Packaging Pocket 10

- End Plug • Shaft Pilot

### Step 12 Install Output Pilot Bushing

Reference pages 4 and 5 in technical booklet for installation tips.

#### Packaging Pocket 11

- Bushing

### Step 13 Install Rear Planet End Play Shim(s)

Reference page 5 in technical booklet for proper installation tips.

#### Packaged Separately

- Shims (2)

### Step 14 Replace Turbine Shaft Seals

Reference page 5 in technical booklet for installation tips.

#### Packaging Pocket 12

- Seals (2)

The parts listed here may be protected by patent number 6,689,007.



# CHRYSLER 46RE, 46RH, 47RE, 47RH ZIP KIT®

PART NUMBER 46-47RHE-ZIP

INSTALLATION & TESTING BOOKLET

## Unit Assembly Specifications, Apply Chart & Electrical Checks

Electronic Checks		
Solenoid	Terminals	OHM Value
OD Solenoid	6 & 1	20-40
TCC Solenoid	7 & 1	20-40
Governor Solenoid	5 & 1	4-6

Technical Specifications		
Pump-to-Stator Bolts 15 ft-lb	Valve Body-to-Case Bolts 106 in-lb	Pump-to-Case Bolts 15 ft-lb
OE Endplay .034-.084"	Valve Body Assembly Bolts 35 in-lb	

Component Application Chart								
Gear	Front Clutch	Rear Clutch	Front Band	Rear Band	Low Roller Clutch	Overdrive Clutch	Overdrive Direct Clutch	Overdrive Roller Clutch
P								
R	ON			ON			ON	Holding
OD-1st		ON			ON		ON	Holding
OD-2nd		ON	ON				ON	Holding
OD-3rd	ON	ON					ON	Holding
OD-4th	ON	ON				ON		
M2		ON	ON				ON	Holding
M1		ON		ON	ON		ON	Holding

8-Pin Terminal Location & Function	
Pin	Terminal Function
1	12-Volt Power Supply from Relay/TCM
2	5-Volt Power Supply to Governor Pressure Sensor
3	Governor Pressure Sensor Ground
4	Governor Pressure Sensor Signal out to PCM
5	Governor Pressure Solenoid Ground Control from PCM
6	PCM Ground Control to OD Solenoid
7	PCM Ground Control to TCC Solenoid
8	Transmission Oil Temperature Sensor Signal to PCM

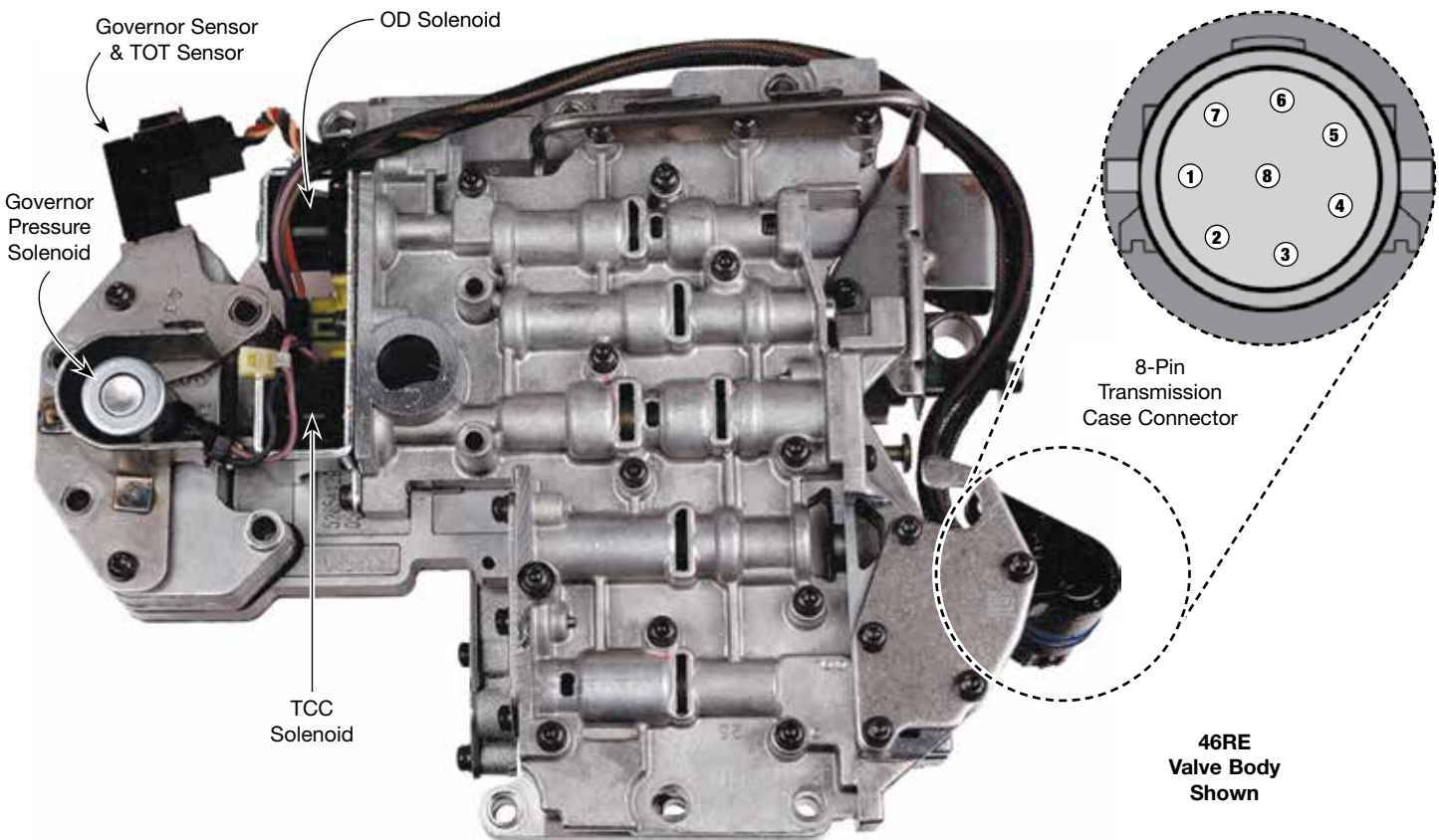

# Valve Body & Unit Rebuild Tips & Techniques

**Bore-by-bore tips for removal, installation, options and checks of components. The detailed instructions below correlate to the quick guide steps.**

## 1. Replace Line Pressure Plug & Sleeve

Reference quick guide for details.

## 2. Remove Parking Sprag & Throttle Pressure Adjusting Screw Bracket & Install Throttle Valve Lineup

- a. For ease in removing and installing parking sprag, use small woodworker's type gouge or awl tool to compress detent ball and spring (Figure 1).
- b. Remove and discard OE E-Ring.
- c. Remove parking sprag, detent ball and spring, setting aside for reuse.
- d. Remove throttle pressure adjusting screw bracket and set aside for reuse.



**NOTE:** A new Sonnax E-Ring is included in this kit for reassembly (see Step 5).

- e. Remove OE throttle valve lineup. Discard sleeve, plunger and spring.
- f. Inspect OE throttle valve for etching between spools, which indicates poor ground circuit. Add additional ground between transmission and chassis ground if necessary. Discard OE throttle valve.
- g. Reference chart to determine shim usage for any desired change in TV pressure.
- h. Install any desired shims over spring stem of Sonnax throttle valve, install in valve body spring stem outboard (Figure 2).
- i. Install Sonnax spring (Figure 2).
- j. Install Sonnax throttle plunger and sleeve (Figure 2).

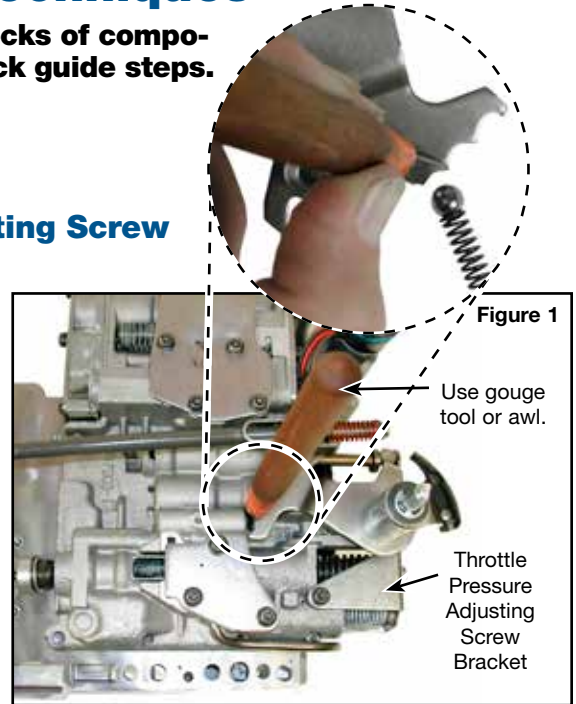

**Figure 1**

## 3. Replace 4-Spooled Switch Valve



**NOTE:** This Sonnax part (Figure 3) will only fit units with four-spool switch valves. These valve bodies can be easily identified by the tube that supplies oil to the boost valve (Figure 4).

## 4. Replace Pressure Regulator Valve

- a. Remove OE pressure regulator valve spring and save for reuse.
- b. Remove and discard OE pressure regulator valve.
- c. Install Sonnax lube regulated pressure regulator valve (Figure 5).
- d. Return OE spring to bore, ensuring coils slide over stem of Sonnax valve.

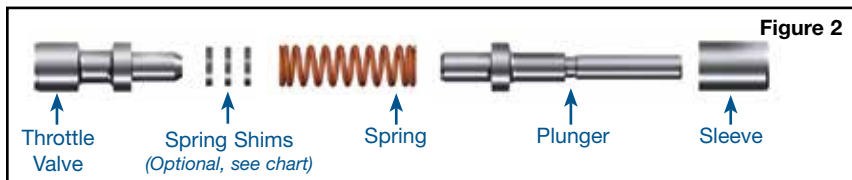

**Figure 2**

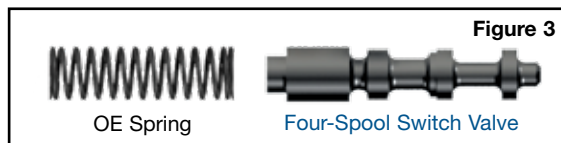

**Figure 3**

Spring & Shim Usage for Desired Change in TV Pressure			
	Spring	No. of Shims	Approx. Change to TV psi
Higher Upshifts	Sonnax	2	+ 14 psi
	Sonnax	1	+ 7 psi
	Sonnax	0	0 psi

OE Specifications	Pressure Regulator Spring
Free Length	2.57"
Wire Diameter	.061"
Approximate No. of Coils	11.5

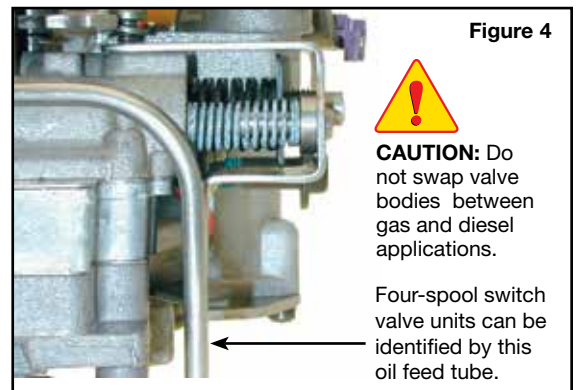

**Figure 4**

Lube Regulated Pressure Regulator Valve **Figure 5**



**NOTE:** Sonnax pressure regulator valve allows converter to be charged in Park.



**CAUTION:** Do NOT drill line-to-lube hole. If there already is a hole drilled, it should be plugged. A hole here will cause converter drainback (**Figure 6**).

**Figure 6**

Do **not** drill line-to-lube hole. If there is a hole, it should be plugged.

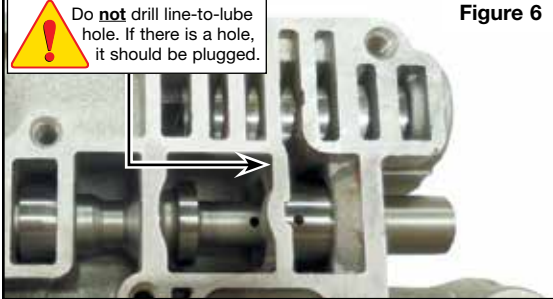

## 5. Replace Manual Valve, Reinstall Throttle Pressure Adjusting Screw Bracket, Reinstall Parking Sprag

- a. Replace manual valve (**Figure 7**).
- b. Reinstall throttle pressure adjusting screw bracket.
  1. Ensure OE springs are returned to appropriate bores (**Figure 7**).
  2. Torque screws to 35 in-lbs.
- c. Reinstall parking sprag (**Figure 1**)
  1. Reinstall OE spring and detent ball into detent casting bore.
  2. Reinstall OE parking sprag on casting boss. Reference **Figure 1** and use gouge tool or awl for compressing detent ball during assembly.
  3. Install Sonnax E-Ring, ensuring it is installed in proper orientation (**Figure 1**).
  4. Ensure leg on parking sprag engages manual valve.

**Figure 7**

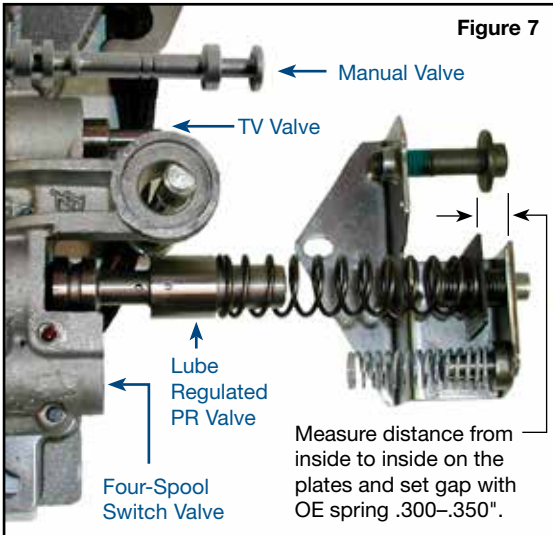

Measure distance from inside to inside on the plates and set gap with OE spring .300-.350".

## 6. Adjust Pressure Regulator Spring & Set Throttle Lever Stop

- a. Adjust pressure regulator spring.
  1. Line pressure must be between 60–65 psi at idle in drive with minimum TV pressure. This is accomplished by setting distance to .300–.350" between inside of spring retaining plates (**Figure 7**).
  2. Each full clockwise turn of the adjuster will move the plate by approximately .050". Adjust gap between plates to .300–.350".
3. Verify line pressure after assembly with a gauge hooked into the line pressure tap located on passenger side, middle of case, between the accumulators. Line pressure will be boosted at TCC apply and 4th Gear. Line pressure must be between 60–65 psi at idle in Drive with minimum TV pressure.



**NOTE:** This adjustment can only be made with an OE spring. Aftermarket springs will require pressure gauge reading and subsequent readjustment of the distance setting to obtain correct line pressure.



**CAUTION:** Use caution adjusting the spring or high pressure will create bind-ups from cross leaks and increase throttle sensitivity.

- b. Set throttle lever stop.
  1. With throttle valve fully bottomed in bore, measurement between cam and plunger valve must be .627" (**Figure 8**).
  2. Adjust throttle adjusting screw as needed to meet .627" measurement specification.

**Figure 8**

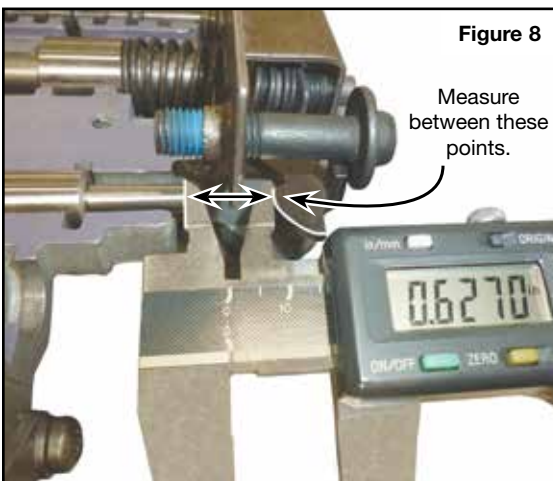

Measure between these points.

## 7. Make Separator Plate Modifications

Reference quick guide for details.

## 8. Replace Boost Valve Retainer

## 9. Replace 3-4 Accumulator Spring & Seals

Reference quick guide for details.

### 10. Replace Checkballs

- Install the 3/16" checkball as shown (Figure 9).
- On other side of the channel plate, install two 1/4" checkballs as shown (Figure 10).
- Install six 1/4" checkballs and one 11/32" checkball in the lower valve body locations (Figure 11).



**NOTE:** Forward clutch failure will occur if the ball seat for the TV ball in the spacer plate leaks.

### Helpful Hint for Valve Body Alignment

It can be helpful to use two 1/8" drill bits, in locations shown, to keep the valve body sections and separator plates in alignment during assembly (Figure 12).

### 11. Replace Intermediate Shaft Pilot & End Plug (Figure 13)

- Using a sheet metal screw, remove the OE cup plug from the OE intermediate shaft (Figure 14) and discard plug.
- Using a steel rod (3/16" x 1"), drive the OE shaft pilot out from the cup plug end of the OE intermediate shaft (Figure 15) and discard pilot.
- Clean the OE intermediate shaft bore thoroughly.
- Install the Sonnax cup plug into place by driving it into the OE intermediate shaft (an AXOD servo pin works well for this).
- Install the Sonnax shaft pilot into position by driving it in the front of the intermediate shaft. If the OE intermediate shaft does not have an internal stop to locate the pilot, position it so that .230-.280" of the pilot protrudes from the shaft.

### 12. Replace Output Pilot Bushing

- Drive out OE pilot bushing from overdrive output shaft.
- Drive the Sonnax output pilot bushing into the OE overdrive output shaft (Figure 16).

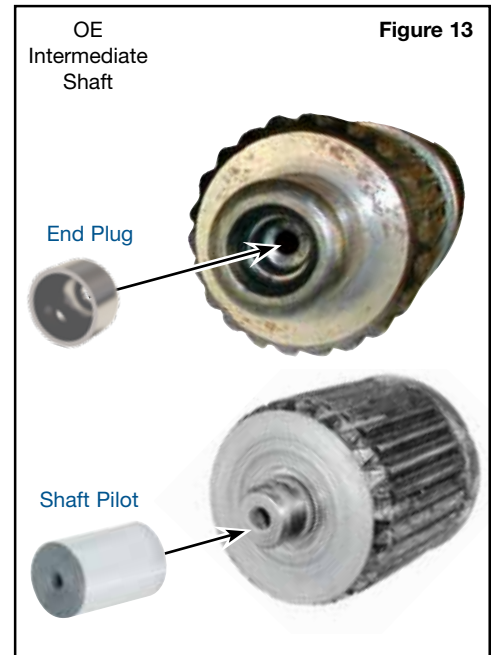
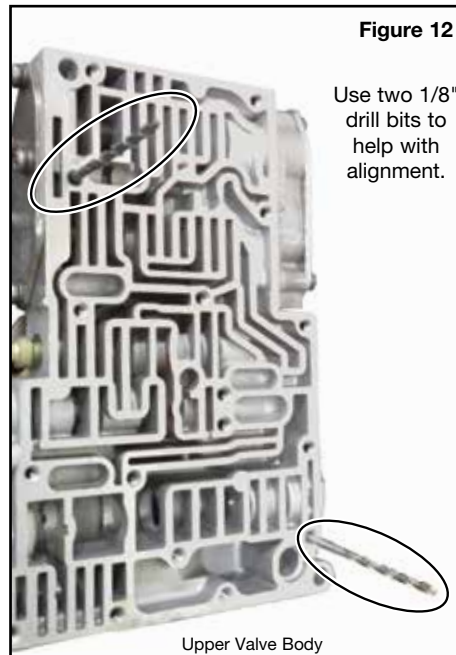
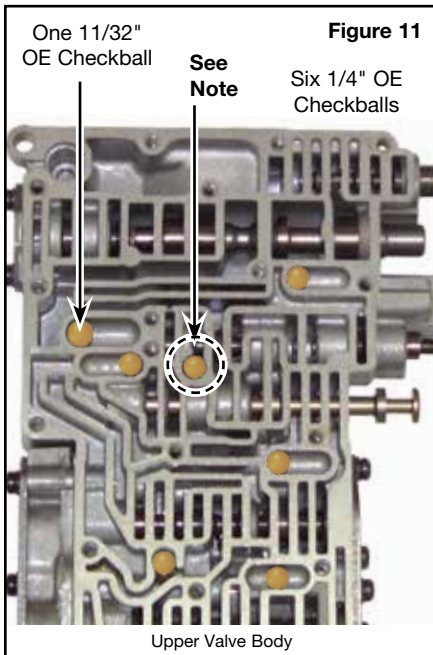
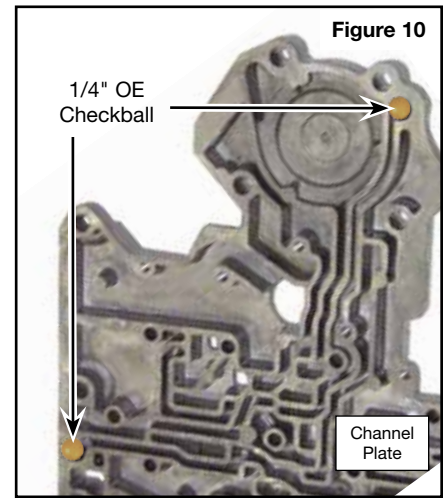
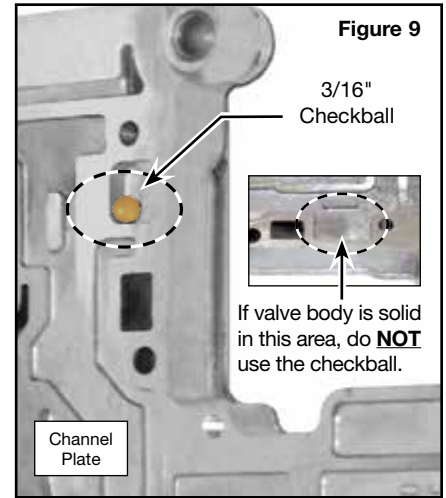

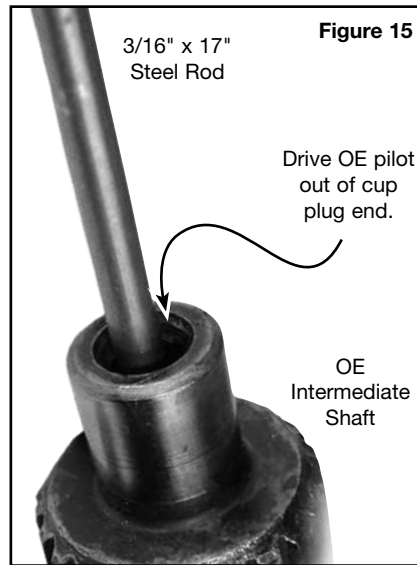
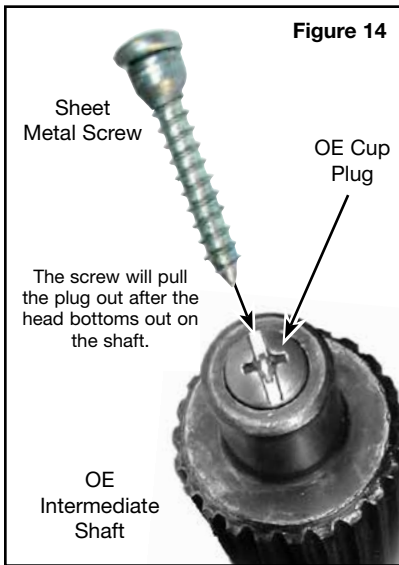

### 13. Install Rear Planet Endplay Shims (Figure 17)

If inspection of rear annulus gear or intermediate shaft indicates visible wear, the Sonnax endplay shim is generally required to reduce geartrain endplay. To verify:

- Measure the endplay of rear planetary gear, rear annulus gear and driving shell as an assembled unit as illustrated (Figure 18).
- Stand the assembly upright, with the snap ring installed, on a flat surface. Pull upward on the intermediate shaft and measure the clearance.
- Insert a feeler gauge between the rear annulus gear support hub and the intermediate shaft shoulder. The factory specification for the clearance should be between .005" and .048". A minimum of .005" to .010" endplay is preferred. If the clearance exceeds these specifications, Sonnax endplay shim(s) should be inserted between the OE tabbed thrust washer and rear planetary assembly.

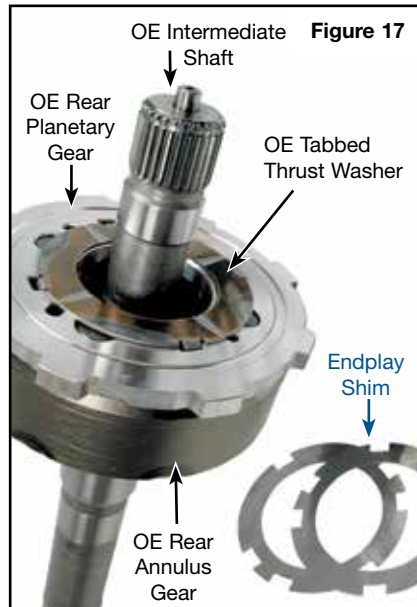
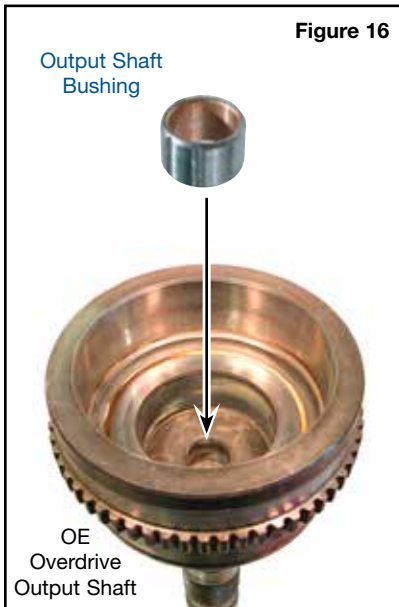

### 14. Replace Turbine Shaft Seals

- Remove and discard OE shaft seals.
- Install the two PTFE Sonnax turbine shaft seals on the turbine input shaft.

**NOTE:** Measure sealing ring lands. These seals will NOT work on seal lands measuring 1.170". Only install these seals on landings measuring 1.245" (Figure 19 & 20).

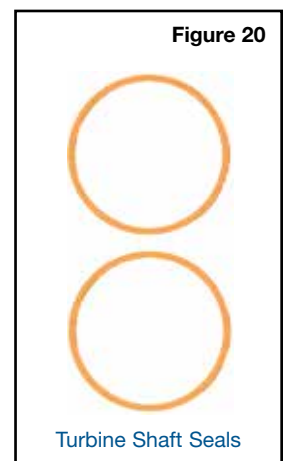
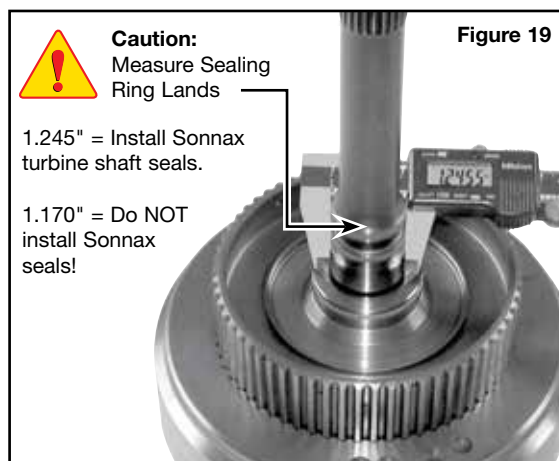
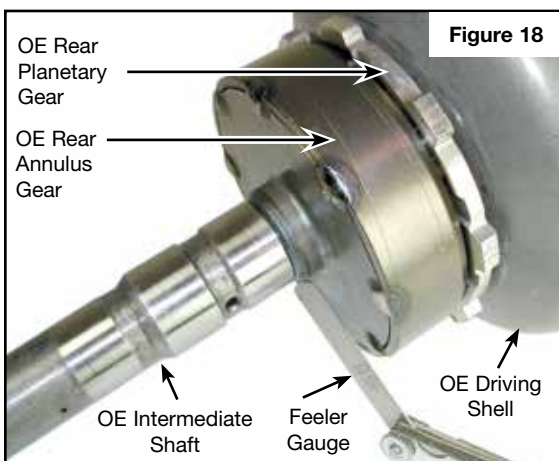

**Critical Wear Areas & Vacuum Test Locations**



**NOTE:** OE valves are shown in rest position and should be tested in rest position unless otherwise indicated. Test locations are pointed to with an arrow. Springs are not shown for visual clarity. Low vacuum reading indicates wear and Sonnax parts are noted for replacement.

**Upper Valve Body • 46RE Shown**



For specific vacuum test information, refer to individual part instructions included in kits and available at [www.sonnax.com](http://www.sonnax.com).

**4-Spool Switch Valve**

- Lockup shudder
- Overheated converter
- Low cooler flow
- Soft TCC apply
- Build up of release pressure during lockup

**Replace with Sonnax Part Nos. 22771A-01\* or 22771A-13** Requires 22771A-TL13

**Pressure Regulator Valve**

- Delayed engagement
- Pressure regulator buzz
- Lube failures
- Converter bushing failure

**Replace with Sonnax Part Nos. 22771A-02K\* or 22771A-07K** Requires F-22771A-TL7 & VB-FIX

**Line Pressure Plug & Sleeve**

- Reverse slip
- Poor Forward & Reverse engagement
- Poor line pressure control
- Poor cooler charge at idle

**Replace with Sonnax Part Nos. 22229-01K\* (.200" Dia.) or 22229-04K (.264" Dia.)**

**Throttle Valve**

- Shift timing concerns
- Throttle buzz
- Poor kickdown

**Replace with Sonnax Part No. 22771-03K\* or 22771-04K** Requires F-22771-TL & VB-FIX

**Manual Valve**

- Delayed engagement
- No cooler flow in Park
- Converter bushing failure
- Overheated converter

**Replace with Sonnax Part No. 22771-09\***

**1-2 & 2-3 Governor Plugs**

- 1-2 Shuttle
- Early upshifts
- 2-3, 3-2 Oversensitive
- Difficulty in adjusting shift timing with TV linkage

**Replace with Sonnax Part No. 22771-14K**

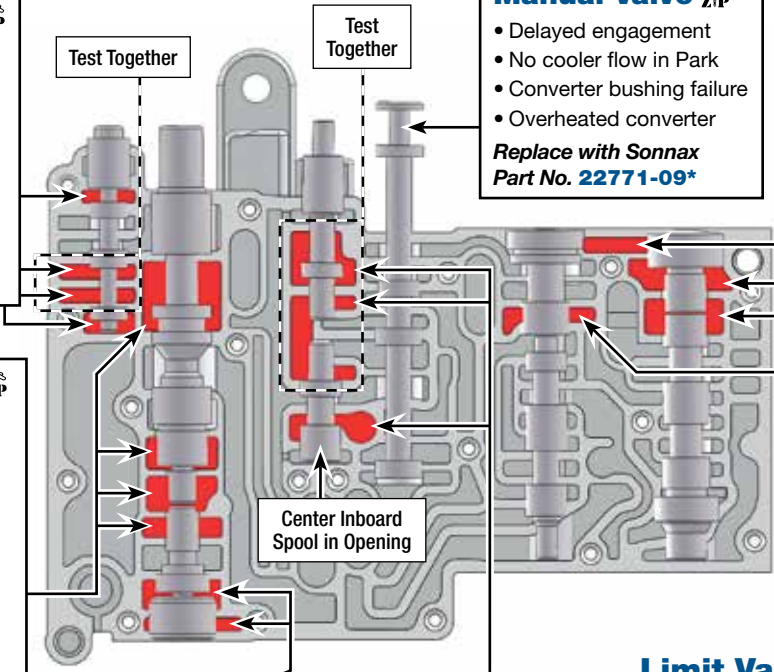

**Limit Valve Housing**

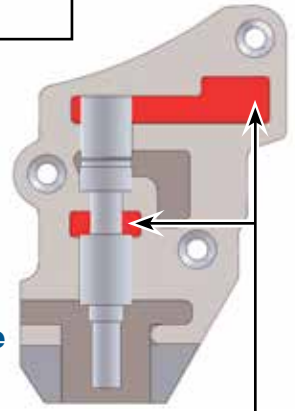

**Lockup Boost Valve**

- TCC slip under load
- No line rise during TCC apply in 4th
- High line pressure with no indication of boost
- Loss of lube oil
- TCC cycling
- No lockup

**Replace with Sonnax Part No. 22771-19K** Requires F-22771-TL19 & VB-FIX

**Lower Valve Body • 46RE Shown**

**3-4 Quick Fill Valve**

- OD clutch burned
- No 4th
- Gear ratio codes

**3-4 Timing Valve**

- No 4th
- Gear ratio codes

**TCC Apply Valve**

- No lockup
- Solenoid codes
- TCC codes

**TCC Timing Valve**

- TCC failure
- TCC engagement issues
- TCC slip codes

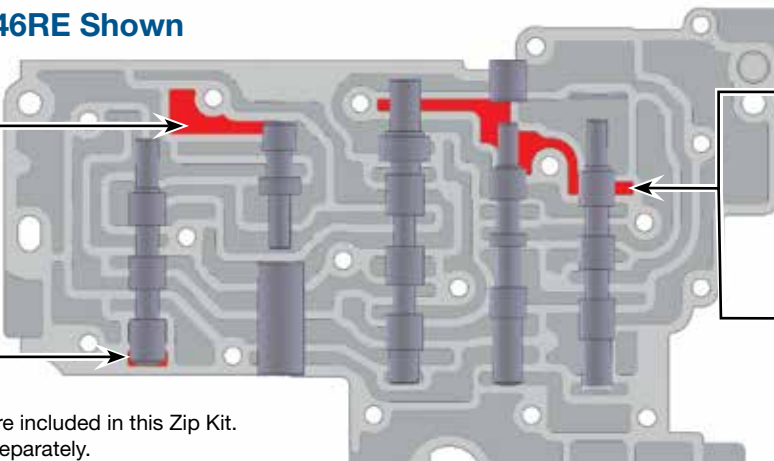

\*Part numbers with an asterisk (\*) are included in this Zip Kit. Other part numbers are available separately.



## OE Exploded View

### Upper Valve Body • 46RE Shown

#### Upper Valve Body Descriptions

I.D. No.	Description
101	2-3 Shift Valve
102	2-3 Throttle Valve Plug
103	Limit Valve
104	1-2 Shift Valve
105	1-2 Shift Control Valve
106	Lockup Boost Valve
107	Throttle Pressure Valve (inboard), Line Pressure Plug & Sleeve (outboard)
108	4-Spool Switch Valve
109	Pressure Regulator Valve
110	Throttle Valve (inboard), Kickdown Valve and Sleeve (outboard)
111	Manual Valve
112	1-2 Governor Plug
113	Shuttle Valve
114	2-3 Governor Plug

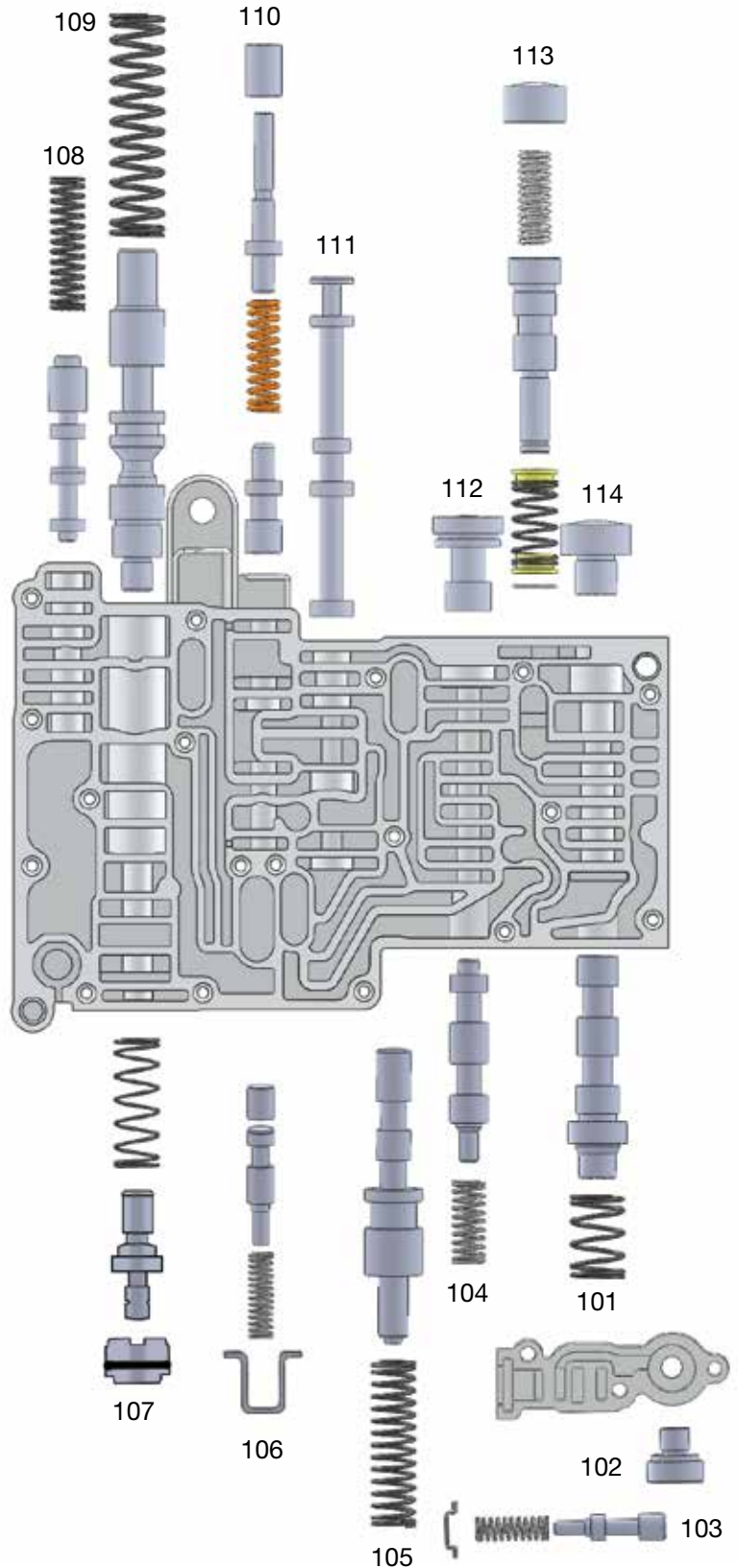

# OE Exploded View

## Lower Valve Body • 46RE Shown

### Lower Valve Body Descriptions

I.D. No.	Description
201	3-4 Quick Fill Valve
202	3-4 Timing Valve
203	3-4 Shift Valve
204	Torque Converter Clutch Apply Valve
205	Torque Converter Clutch Timing Valve

