

Reaction Plate & Bolt-On Anchor Plate Service Kit

Part No.

72960-12SVC

- Lip Seal
- UD/OD Reaction Plate
- Anchor Plate Shims (2)
- Bolt-On Anchor Plate
- Screws (12)

Chrysler 68RFE

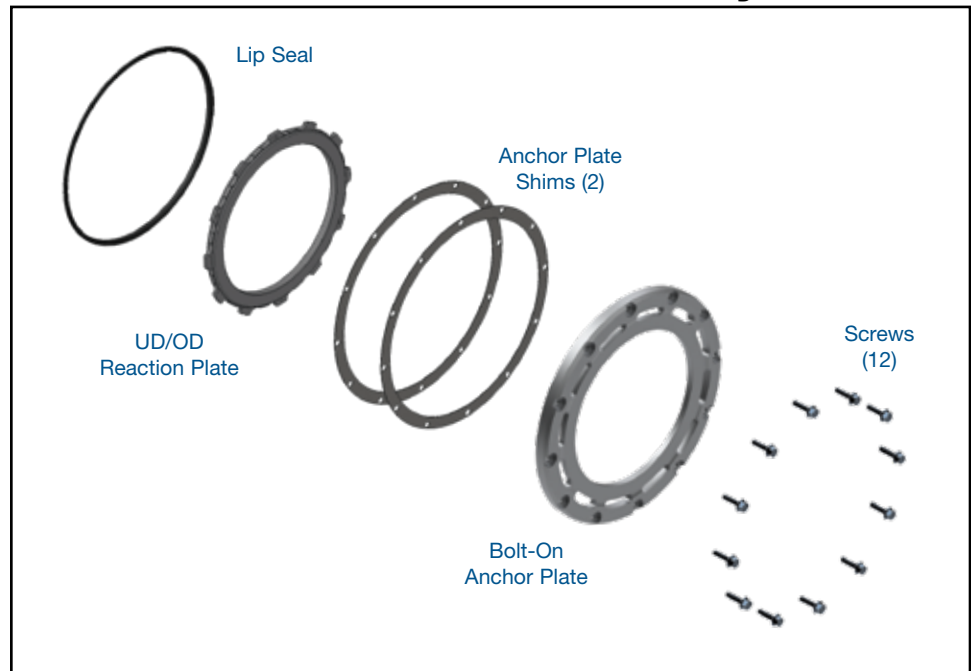

1. Remove all residual thread-locking compound from screw and bolt-on anchor plate mounting surfaces. Measure overdrive clutch clearance, mount a dial indicator to the assembly and zero the indicator against the Sonnax bolt-on anchor plate. Apply 20 psi of air pressure to the overdrive clutch and record the indicator reading. OE specification is 0.75–1.61mm (.030–.063").
2. Clutch clearance is adjusted with bolt-on anchor plate shims.
3. Fasten bolt-on anchor plate to Sonnax overdrive/reverse housing with 12 screws. Prior to assembly clean screw threads and threaded holes in housing with brake wash cleaner so all threads are clean and dry. Apply a drop of high strength red Loctite® Threadlocker 262 or equivalent to the threads of each socket head cap screw and a small amount to each threaded hole in housing. Install 12 Sonnax screws through the bolt-on anchor plate into the threaded holes in the housing and lightly tighten each screw.
4. Torque spec is 51 in-lb. Tighten all screws to lower 40 in-lb value by working around the housing in a crisscross (star) pattern to ensure even pressure on the bolt-on anchor plate. Before the threadlocker cures, retorque to 51 in-lb specification.

NOTE: For additional kit information and detailed instructions for **72960-16K** Smart-Tech® Overdrive Clutch Housing Kit, visit www.sonnax.com.