

GM 4L80-E

Case Saver Retainer

Part No.

34762-20

NOTE: Fits all 4L80-E '99-later.

Also Available

Case Saver Retainer

34762-10

NOTE: Fits all TH400 and '98-earlier 4L80-E.



1. Verify Year and Case Version

The distance between the front band anchor pin inside the case and the intermediate clutch backing plate retainer ring varies depending on year of the case (**Figure 1**). All TH400 and 4L80-E '98-earlier are the same and '99-later 4L80-E is different. Other changes in 1999 are, wider (1.250") front band, .041" shim under rear sun gear bearing and 'flat' .275" thick intermediate backing plate.

- TH400/4L80-E to '98-earlier uses Sonnax **34762-10** (Black)
- 4L80-E '99-later uses Sonnax **34762-20** (Zinc)

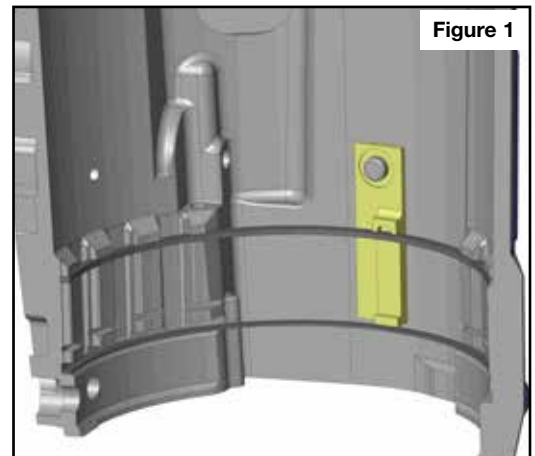

Figure 1

2. Modify Backing Plate with Additional Notch (Figure 2)

- a. Apply machinist layout fluid, a black marking pen or other marking material to both sides of intermediate backing plate in area shown (**Figure 3**).

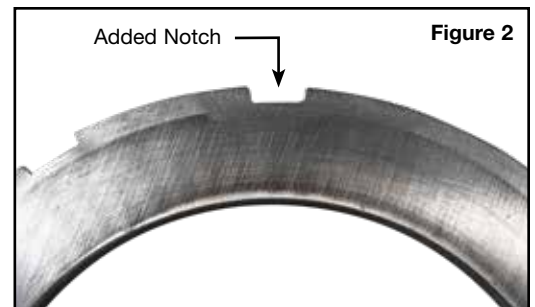

Figure 2

2. Modify Backing Plate with Additional Notch (continued)

- b. Lay an intermediate steel plate over the friction face of the backing plate and align the lugs as accurately as possible.
- c. Scribe the new lug notch in the area shown (Figure 3).
- d. Repeat on other side of backing plate.
- e. With a fine tooth hack saw, cut up to the scribed lines on the pressure plate with a series of cuts (Figure 4).
- f. Break out the sections between cuts.
- g. Use a file to clean up the notch. Recheck with steel plate, filing as necessary (Figure 2).

3. Case Saver Installation (Figure 5)

- a. Before installing the beveled center support retaining ring, place the Sonnax case saver over front band anchor pin and between exposed center support lugs.
- b. Install the beveled center support retaining ring with the opening at the 9:00 position and so one end of the retaining ring holds the case saver against the inside of the case.
- c. Install intermediate clutches and modified backing plate.
- d. Install the backing plate retaining ring with open end at 12:00 position.

4. Check Intermediate Band-to-Drum Clearance

- a. Install intermediate band
- b. Install direct drum.
- c. Partially apply and release band by inserting screwdriver through band servo pin hole in case.
- d. Check band anchor end to ensure there is some clearance between band friction lining and drum. Ensure band is not dragging on direct drum (Figure 6).
- e. If additional band-to-drum clearance is needed, a small amount of material can be removed from back of band anchor lug (Figure 7).

