

HP Miscellaneous

Conversion Spacer

Part No.

GMBW-WS-40

NOTE: Standard quantity 10/bag.

Application

Conversion for BW 310mm LU (A618),
GM TH400 (3L80), AT-540 & Buick 350

Associated Parts

GM-R-15 Outer Stator Race

GM-S-11 Accordion Spring

GM-RO-572 Roller

GM-HR-1 Inner Stator Race,
BW 310mm LU (A618),
GM TH400 (3L80), AT-540 & Buick 350

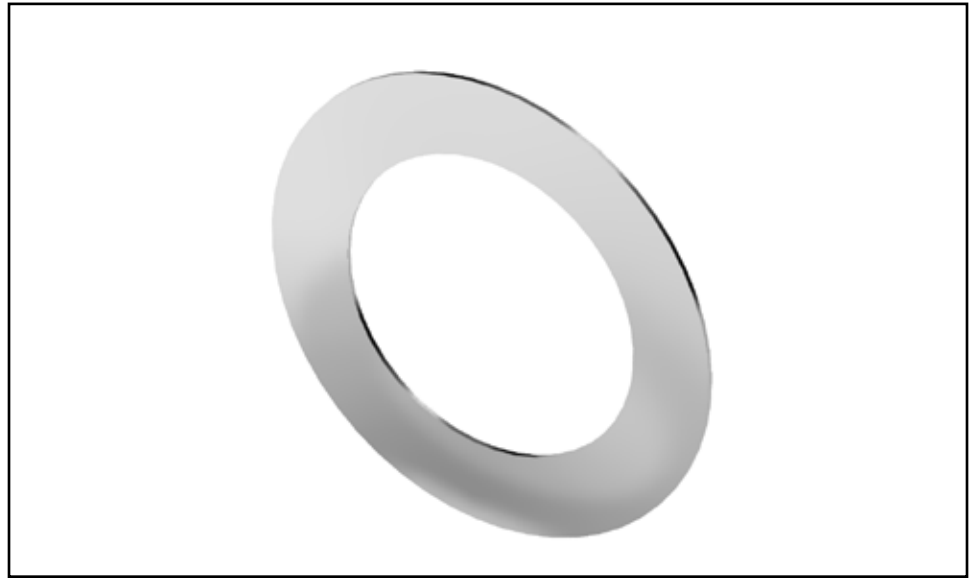

Sonnax conversion spacer **GMBW-WS-40** and outer stator race **GM-R-15** (Figure 1) are used with the GM 300mm outer stator race, springs and rollers for a cost-effective upgrade to BW 310mm LU (A618), GM TH400 (3L80), AT-540 and Buick 350 stator clutch assemblies. The upgrade repairs and improves the performance of OE stator cams with problematic roller clutch design.

Converter Instructions

- Remove the outer stator race, spring retainer, springs, rolls and inner stator race from the stator. The spring retainer is no longer used with the conversion.
- Modify the stator by milling five slots into the stator using a 3/8" end mill (Figure 2).
- Drop the **GMBW-WS-40** conversion spacer into stator (Figure 3).
- Drop-in GM 300mm outer stator race **GM-R-15** and MIG-weld in place at the end of the slots (Figure 4).
- Reassemble the stator clutch using the springs **GM-S-11** and rollers **GM-RO-572** from the GM 300mm unit and the inner stator race **GM-HR-1** from the original stator.

