



TORQUE CONVERTER PARTS GM-MD-3, -RK

MECHANICAL DIODE AND REFRESHER KIT

INSTALLATION INSTRUCTIONS

Application: GM 8" Opel

1. Place the part of the **GM-MD-3** with the internal splines on a suitable work area with the spring and strut cavities facing up.

NOTE: Proper positioning of the spring and strut are critical for correctly assembling the unit.

2. The spring and strut cavities have two levels (see *Figure 1*). The spring rests in the lower level and the strut rests on the upper level. The lower level of the cavity is a square with rounded corners, with a dimple machined into the right sidewall. The dimple area provides clearance for the center leg of the spring and is used as a guide for orienting the spring.

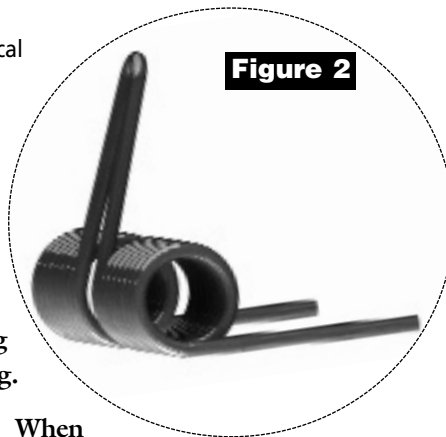

3. Orient the spring as shown in *Figure 2*. When installed correctly, the spring will look like the one shown in *Figure 3*.

4. The strut is a piece of metal shaped like a fat "T" (see *Figure 4*). Note that one end of the "T" is more rounded than the opposite end: the rounded end faces the inside of the cavity. The top of the "T" rests against the left sidewall of the upper level of the spring and strut cavity.

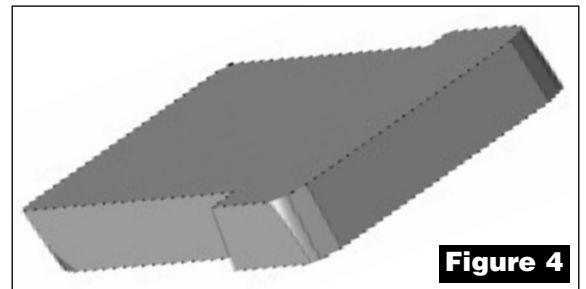

5. The top of the "T" has an angle machined onto it, and it must be oriented to provide a mating surface with the left sidewall of the upper level of the cavity. When the strut is positioned correctly it will look like the one shown in *Figure 5*. *Figure 6* shows improper positioning of the strut.

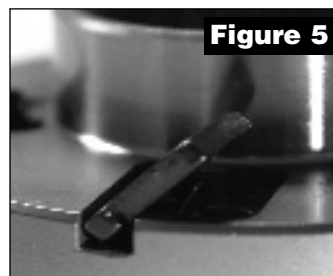

6. Place the part of the **GM-MD-3** with the spiral ring groove (ring groove facing down) onto the part with the internal splines. You will begin to feel spring tension as the part comes into contact with the struts. Continue pushing the part down until the springs are fully compressed. Hold the two parts firmly together and turn the assembly over to expose the spiral ring groove. If the ring groove is not visible, the springs and struts are not installed correctly.

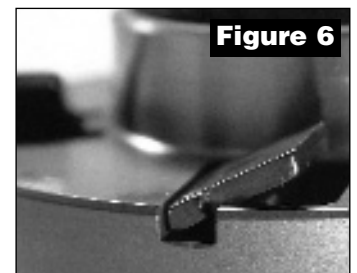

7. Continue holding the parts together and install the spiral snap ring.

