



Impeller Hub

Part No.

HO-90-4G

Associated Parts

- HO-O-1V O-Ring
- HO-O-2V O-Ring
- JA-N-13 Enclosed Bearing

Illustration Reference

HO-90-4G is item number 3 below.
For detailed illustration, visit
www.sonnax.com.

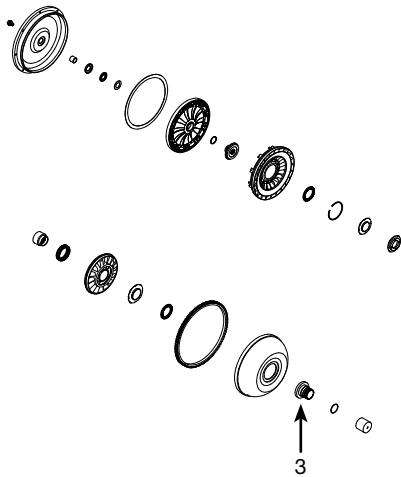

Honda B7TA/B7VA/B7YA



To modify the stator bore to accept JA-N-13 enclosed bearing:

1. Measure the JA-N-13 bearing O.D.
2. Add .002" to that measurement.
3. Bore out the opening on the stator to the calculated dimension (Figure 1) to allow the bearing to fit into the pocket of the stator (Figure 2).
4. Be sure to continue the machining process to the bottom of the bore to provide plenty of lube oil for good bearing life.

NOTE: Stator bore modification is required when installing impeller hub **HO-90-4G** and using the recommended enclosed thrust bearing **JA-N-13** in place of the open bearing.



Figure 1



Figure 2