

Click on part numbers for product details or visit www.sonnax.com to see all products for the unit(s) shown here.

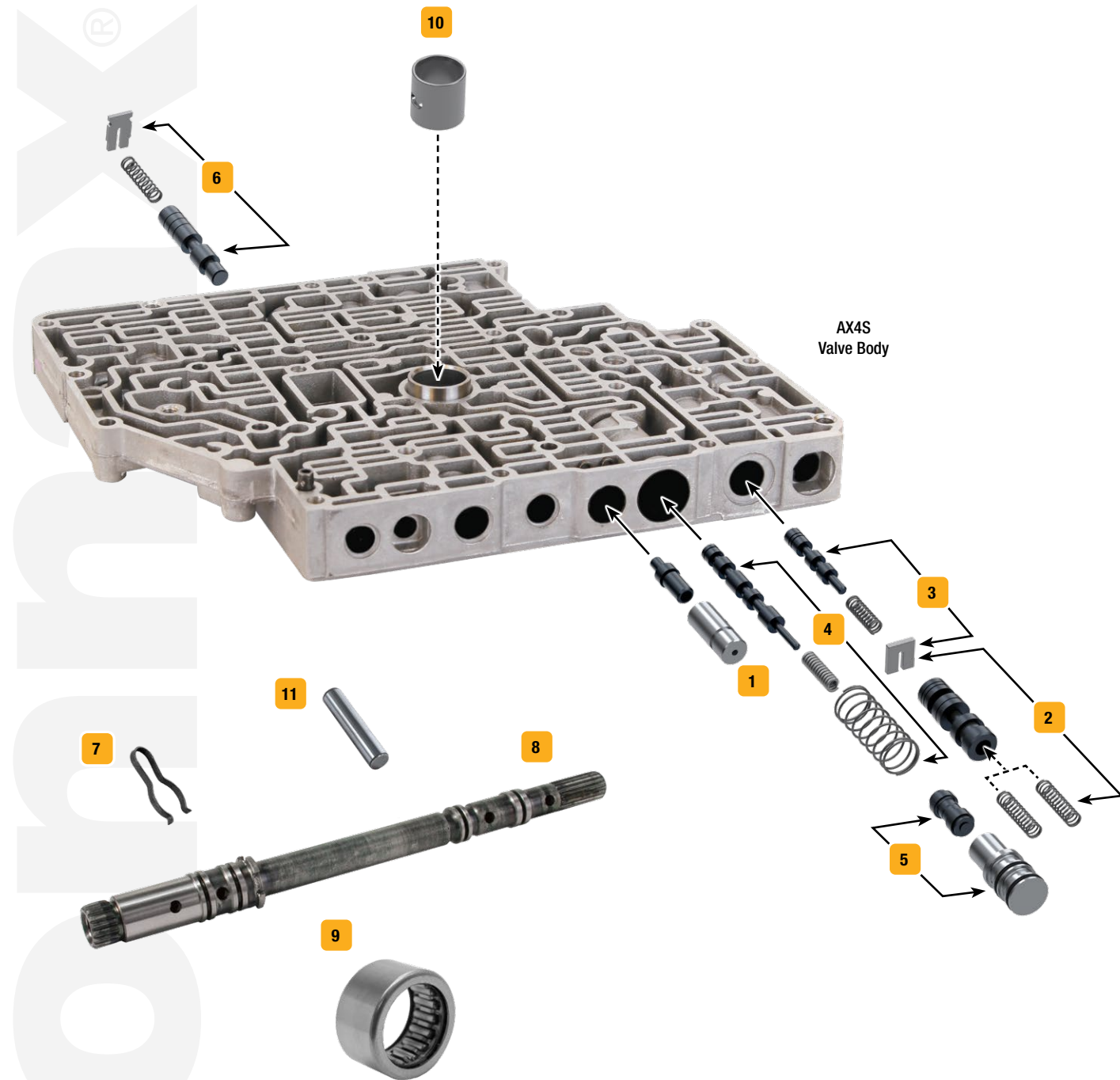

Symptoms/Benefits	Product Name	Part No.	Details	ZIP Drop-In Zip Valve™ Parts	Tooling
TCC/Lockup Symptoms					
Code 628, TCC slip, No lockup, Soft TCC apply, No TCC release during coast	Bypass TCC Control Plunger Valve Kit	1 96206-01K	ZIP AX4S, AXODE only		
Code 628, 741, 744, TCC cycling, Overheating & reduced lube feed, Delayed engagement, No 4th	Oversized Converter Regulator Valve Kit	2 96201-23K	AX4S, AXODE only, works in 2- or 4-spoiled OE applications		F-96201-TL23*‡
Code 1741, 1744, TCC cycling, No lockup, TCC surge	Oversized Solenoid Regulator Valve Kit	3 96201-21K	AX4S, AXODE only		96201-TL2‡
Pressure Problems					
Erratic line pressure, Delayed engagement, Pump noise, Pump rotor & cover damage	Oversized Pressure Regulator Valve Kit	4 96206-10K	AX4S, AXODE only, late-style		96206-TL2
Shift/Engagement Concerns					
1-2 Flare, 2-3 Flare, 2-1 Clunk, Harsh Reverse, Clutch failure, Band failure	Boost Valve Kit	5 96201-08K	ZIP Fits all except 3.0 liter 12 valve, .491" dia. valve, factory-style sleeve		
	Boost Valve Kit	5 96201-01K	ZIP Fits all except 3.0 liter 12 valve, .491" dia. valve, includes O-rings		
	Boost Valve Kit	5 96201-12K	ZIP Fits 3.0 liter 12 valve, .475" dia. valve, includes O-rings		
No Forward, 1-2-3-2 Shifts, No 4th Slips in Forward & Reverse, No Reverse	Forward Control Valve Kit	6 96201-16K	AX4S, AXODE only		96201-BST †‡
Component Damage/Failure					
Lost or damaged component	Backout Valve Clip	7 96201-11	10/Bag		
Scored shaft	Oil Pump Shaft	8 96855-02K	Patented design increases oil flow		
Bearing noise, Bearing failure	Pump Bearing	9 96855-01K	With integral seal		
Lost or damaged component	Pump Shaft Sleeve	10 96201-18			
	Pump Slide Pin	11 96200-02	5/Bag		

* VB-FIX Required

† Recommended Tool

‡ No longer in production. Check with your distributor for availability.