

Ford AX4S, AXOD, AXODE

sonnax®

Click on part numbers for product details or visit www.sonnax.com to see all products for the unit(s) shown here.

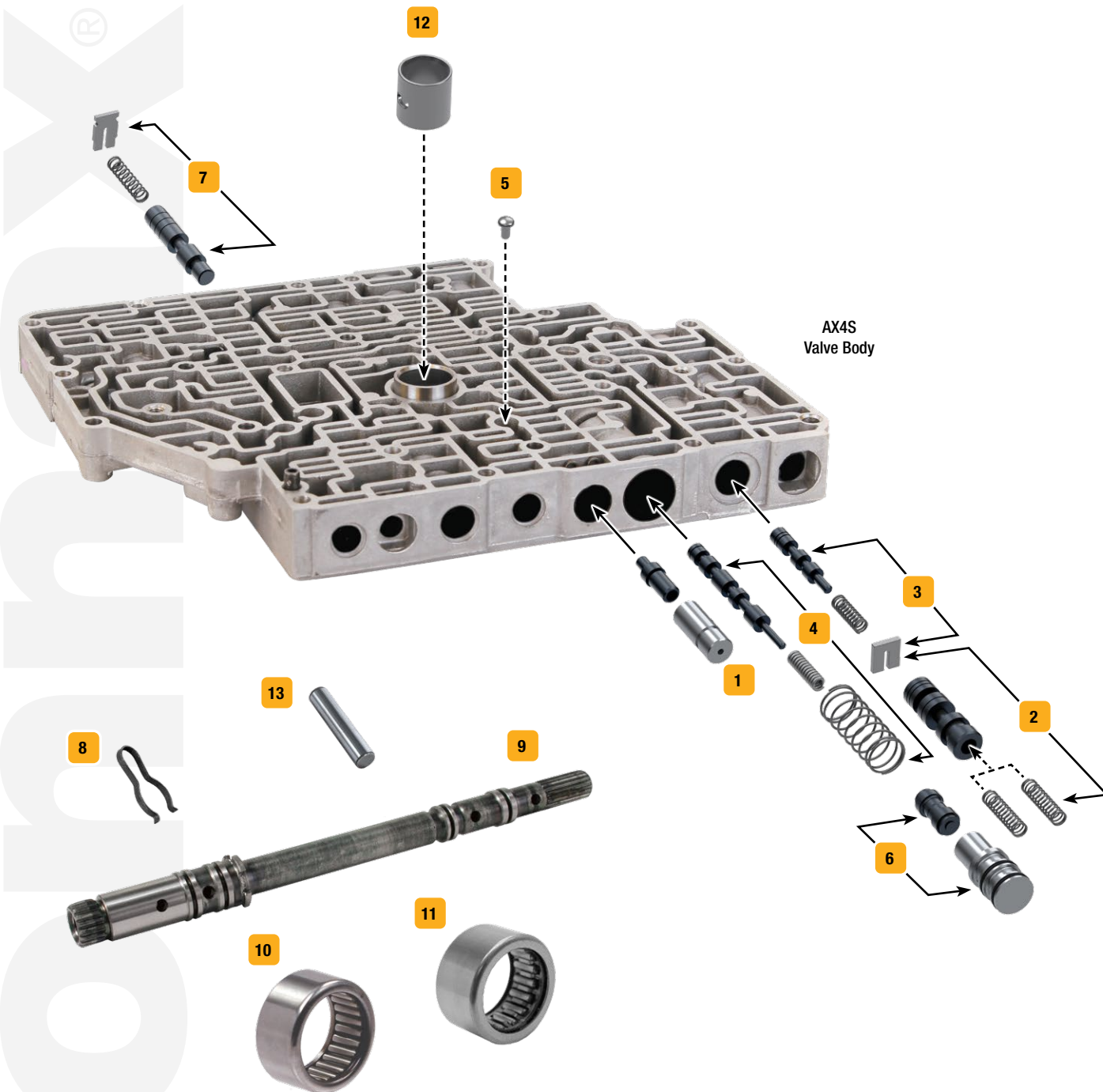

| Symptoms/Benefits | Product Name | Part No. | Details | ZIP Drop-In Zip Valve™ Parts | Tooling |
|--|---|--------------|--|------------------------------|---------------|
| TCC/Lockup Symptoms | | | | | |
| Code 628, TCC slip, No lockup, Soft TCC apply, No TCC release during coast | Bypass TCC Control Plunger Valve Kit | 1 96206-01K | ZIP AX4S, AXODE only | | |
| Code 628, 741, 744, TCC cycling, Overheating & reduced lube feed, Delayed engagement, No 4th | Oversized Converter Regulator Valve Kit | 2 96201-23K | AX4S, AXODE only, works in 2- or 4-spoiled OE applications | | F-96201-TL23* |
| Code 1741, 1744, TCC cycling, No lockup, TCC surge | Oversized Solenoid Regulator Valve Kit | 3 96201-21K | AX4S, AXODE only | | 96201-TL2‡ |
| Pressure Problems | | | | | |
| Erratic line pressure, Delayed engagement, Pump noise, Pump rotor & cover damage | Oversized Pressure Regulator Valve Kit | 4 96206-10K | AX4S, AXODE only, late-style | | 96206-TL2 |
| Pressure loss, Converter drain back | Relief Valve | 5 10000-01K | Low radius, 10/bag | | |
| Shift/Engagement Concerns | | | | | |
| 1-2 Flare, 2-3 Flare, 2-1 Clunk, Harsh Reverse, Clutch failure, Band failure | Boost Valve Kit | 6 96201-13K | ZIP Fits 3.0 liter 12 valve, .475" dia. valve, factory-style sleeve | | |
| | Boost Valve Kit | 6 96201-08K | ZIP Fits all except 3.0 liter 12 valve, .491" dia. valve, factory-style sleeve | | |
| | Boost Valve Kit | 6 96201-01K | ZIP Fits all except 3.0 liter 12 valve, .491" dia. valve, includes O-rings | | |
| | Boost Valve Kit | 6 96201-12K | ZIP Fits 3.0 liter 12 valve, .475" dia. valve, includes O-rings | | |
| No Forward, 1-2-3-2 Shifts, Slips in Forward & Reverse, No Reverse, No 4th | Forward Control Valve Kit | 7 96201-16K | AX4S, AXODE only | | 96201-BST †† |
| Component Damage/Failure | | | | | |
| Lost or damaged component | Backout Valve Clip | 8 96201-11 | 10/Bag | | |
| Scored shaft | Oil Pump Shaft | 8 96855-02K | Patented design increases oil flow | | |
| Bearing noise, Bearing failure | Pump Bearing | 10 96077-01 | Without integral seal | | |
| | Pump Bearing | 11 96855-01K | With integral seal | | |
| Lost or damaged component | Pump Shaft Sleeve | 12 96201-18 | | | |
| | Pump Slide Pin | 13 96200-02 | 5/Bag | | |

* VB-FIX Required

† Recommended Tool

‡ No longer in production. Check with your distributor for availability.