

GM 4T60, 4T60-E

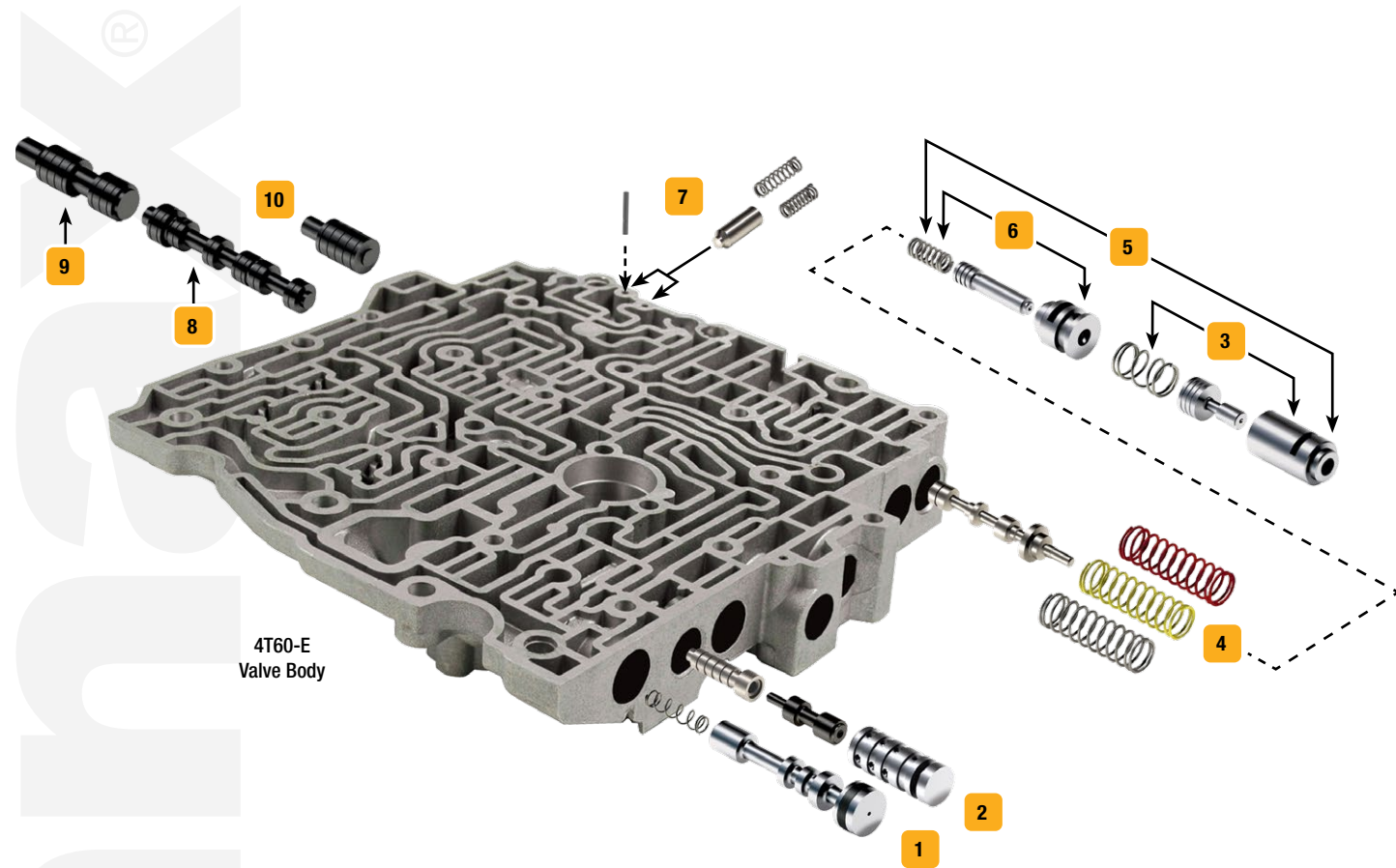

Click on part numbers for product details or visit www.sonnax.com to see all products for the unit(s) shown here.



4T60-E Valve Body



See kit components at www.sonnax.com.

Symptoms/Part Type	Product Name	Part No.	Details	ZIP Drop-In Zip Valve™ Parts	Tooling
Multiple Symptoms					
Comprehensive kit for big problems you don't want back	The Sure Cure® Kit	SC-4T60E	4T60-E, '93-'96 only		84754-TL5
	The Sure Cure® Kit	SC-4T60E-1	4T60-E, '97-later only		84754-TL5
TCC/Lockup Symptoms					
Code 39, 740, 1870, Falls out of lockup when hot, Overheated converter, Shudder	Oversized TCC Apply Valve Kit	1 84754-16K	'96-Earlier, large spool less than 15mm		84754-TL5
	Oversized TCC Apply Valve Kit	1 84754-97K	4T60-E, '97-later only, large spool more than 15mm		84754-TL5
	TCC Apply Valve Kit	1 84754-22K	ZIP '96-Earlier, large spool less than 15mm		
Code 39, 740, 1870, Overheated converter, Falls out of lockup when hot, Converter shudder	TCC Regulator & Isolator Valve Kit	2 84754-01K	ZIP 4T60-E, '93-later only		
Pressure Problems					
Low line rise, Soft shifts, 2nd Clutch distress, 3rd Clutch distress	Modulated Line Boost Valve Kit	3 84754-12K	ZIP Low ratio, .276" dia. small spool		
	Modulated Line Boost Valve Kit	3 84754-17K	ZIP High ratio, .199" dia. small spool		
Erratic line pressure, Burnt clutches, Poor shift quality, Overheating	Oversized Pressure Regulator Valve Kit	4 84754-46K			84754-TL46
Low line rise, Low Reverse boost, Soft shifts, 2nd Clutch distress, 3rd Clutch distress	Reverse & Modulated Line Boost Valve Kit	5 84754-24K	ZIP Low ratio		
	Reverse & Modulated Line Boost Valve Kit	5 84754-25K	ZIP High ratio		
Low Reverse boost	Reverse Boost Valve Kit	6 84754-14K	ZIP Low ratio, .273" dia. small spool		
	Reverse Boost Valve Kit	6 84754-19K	ZIP High ratio, .293" dia. small spool		
Shift/Engagement Concerns					
1-2 Flare, Delayed engagement, Low Reverse pressure, 1-2 Band burned	Oversized 1-2 & Reverse Servo Boost Valve Kit	7 84754-40K	Fits either of two locations, 4T60 requires 84754-TL4, 4T60-E requires 84754-TL2		84754-TL2, 84754-TL4
Erratic shifts, 2-3 Shuttle, No 3rd, Temperature-sensitive shifts, No 4th, 2nd Gear starts	2-3 Shift Valve	8 84754-36K	ZIP 4T60-E, '94-later only		
Erratic shifts, 2-3 Shuttle, No 3rd, No 4th, 2nd Gear starts, Temperature-sensitive shifts	3-2 Manual Downshift Valve	9 84754-37K	ZIP 4T60-E, '94-later only		
Erratic shifts, 2-3 Shuttle, Temperature-sensitive shifts, No 3rd, No 4th, 2nd Gear starts	4-3 Manual Downshift Valve	10 84754-39K	ZIP 4T60-E only		