

# GM 4T60, 4T60-E

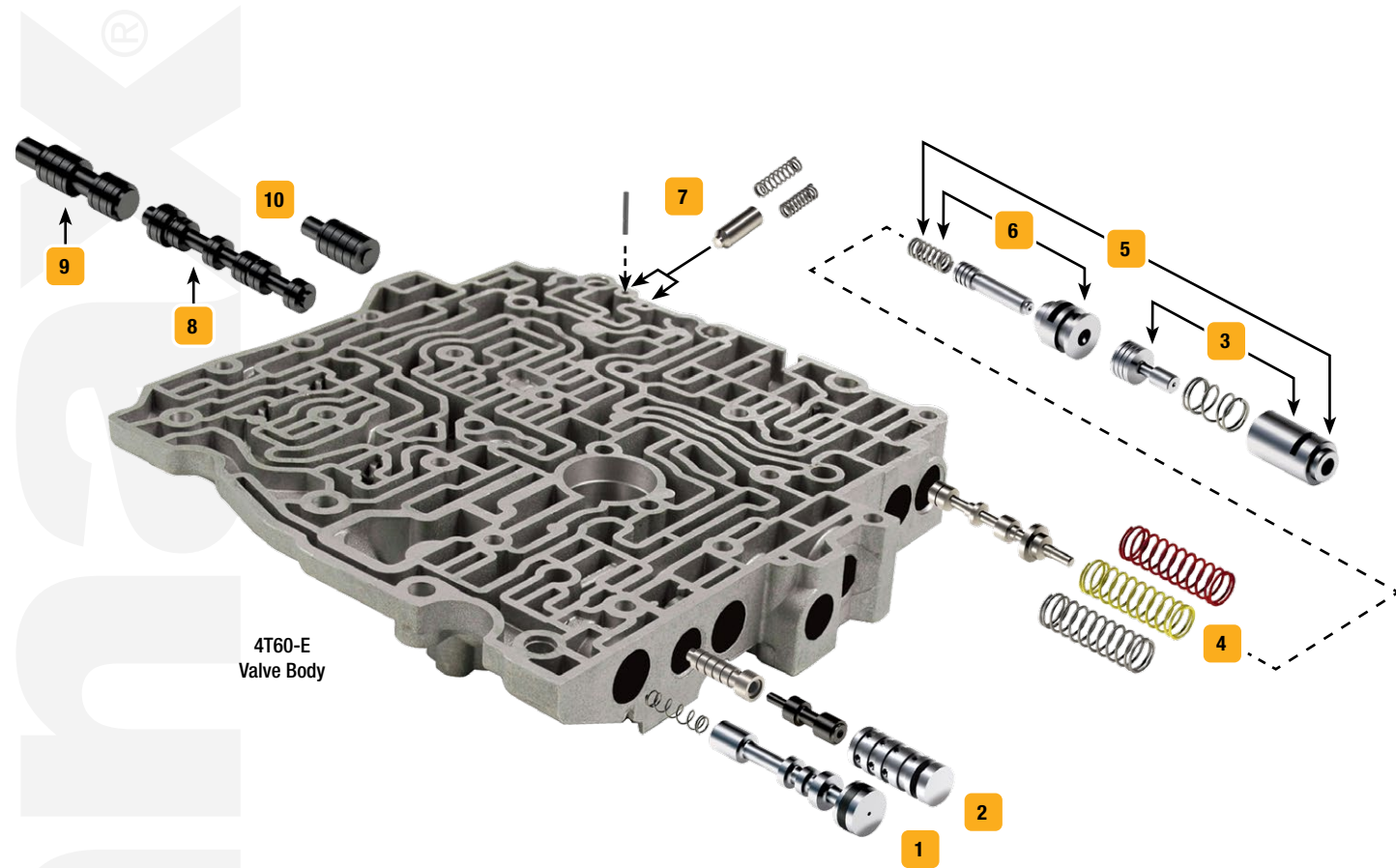

Click on part numbers for product details or visit [www.sonnax.com](http://www.sonnax.com) to see all products for the unit(s) shown here.



4T60-E  
Valve Body



Symptoms/Benefits	Product Name	Part No.	Details	Tooling
<b>TCC/Lockup Symptoms</b>				
Code 39, 740, 1870, Falls out of lockup when hot, Overheated converter, Shudder	Oversized TCC Apply Valve Kit	1 84754-16K	'96-Earlier, large spool less than 15mm	84754-TL5‡
	TCC Apply Valve Kit	1 84754-22K	ZIP '96-Earlier, large spool less than 15mm	
Code 39, 740, 1870, Overheated converter, Falls out of lockup when hot, Converter shudder	TCC Regulator & Isolator Valve Kit	2 84754-01K	ZIP 4T60-E, '93-later only	
<b>Pressure Problems</b>				
Low line rise, Soft shifts, 2nd Clutch distress, 3rd Clutch distress	Modulated Line Boost Valve Kit	3 84754-17K	ZIP High ratio, .199" dia. small spool	
Erratic line pressure, Burnt clutches, Poor shift quality, Overheating	Oversized Pressure Regulator Valve Kit	4 84754-46K	Includes selective springs	84754-TL46
Low line rise, Low Reverse boost, Soft shifts, 2nd Clutch distress, 3rd Clutch distress	Reverse & Modulated Line Boost Valve Kit	5 84754-25K	ZIP High ratio	
	Reverse Boost Valve Kit	6 84754-14K	ZIP Low ratio, .273" dia. small spool	
Low Reverse boost	Reverse Boost Valve Kit	6 84754-19K	ZIP High ratio, .293" dia. small spool	
<b>Shift/Engagement Concerns</b>				
1-2 Flare, Delayed engagement, Low Reverse pressure, 1-2 Band burned	Oversized 1-2 & Reverse Servo Boost Valve Kit	7 84754-40K	Fits either of 2 locations, 4 T60 requires 84754-TL4, 4T60-E requires 84754-TL2	84754-TL2, 84754-TL4‡
Erratic shifts, 2-3 Shuttle, No 3rd, Temperature-sensitive shifts, No 4th, 2nd Gear starts	2-3 Shift Valve	8 84754-36K	ZIP 4T60-E '94-later only	
Erratic shifts, 2-3 Shuttle, No 3rd, No 4th, 2nd Gear starts, Temperature-sensitive shifts	3-2 Manual Downshift Valve	9 84754-37K	ZIP 4T60-E '94-later only	
Erratic shifts, 2-3 Shuttle, Temperature-sensitive shifts, No 3rd, No 4th, 2nd Gear starts	4-3 Manual Downshift Valve	10 84754-39K	ZIP 4T60-E only	

‡ No longer in production. Check with your distributor for availability.



See kit components at [www.sonnax.com](http://www.sonnax.com).