

Click on part numbers for product details or visit www.sonnax.com to see all products for the unit(s) shown here.

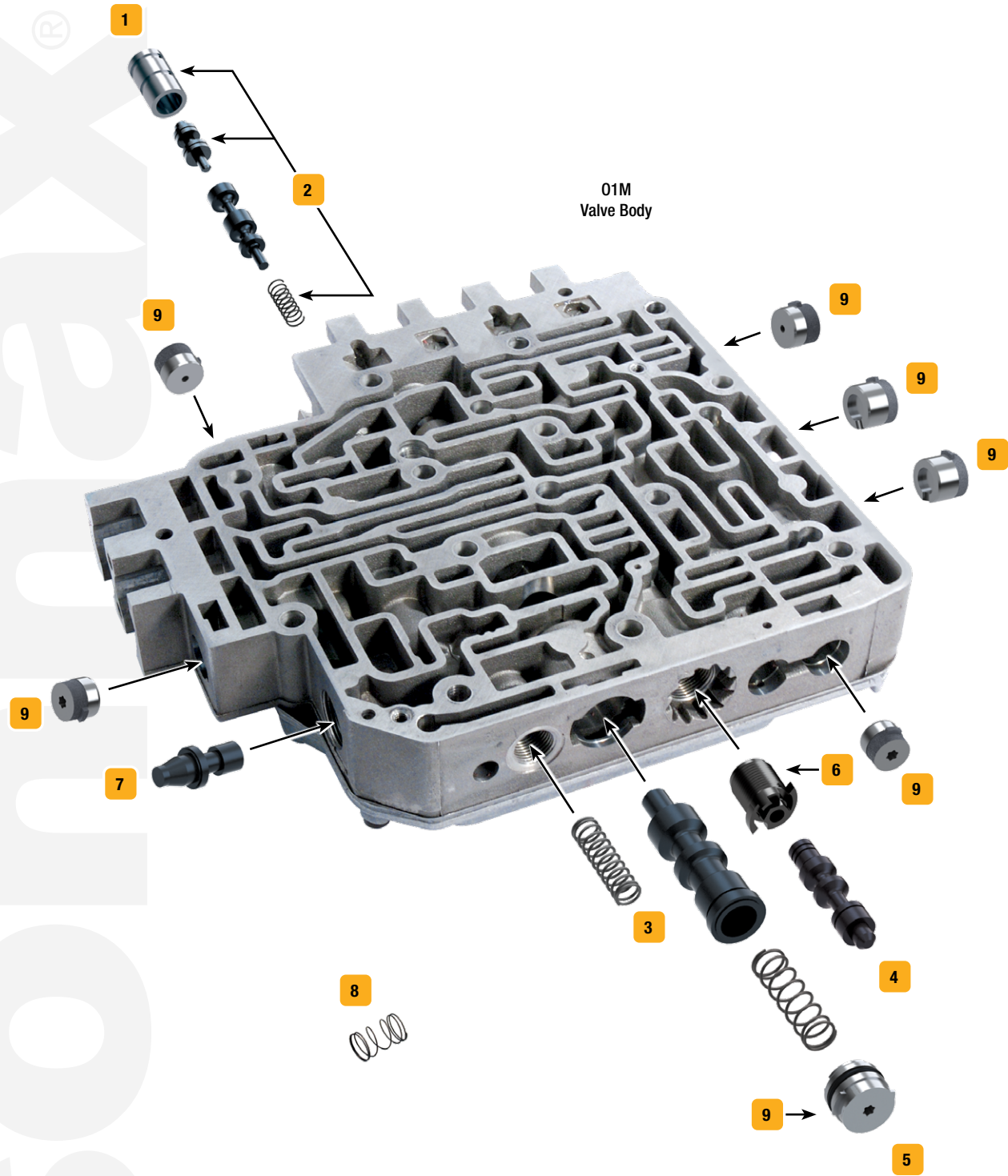

| Symptoms/Benefits | Product Name | Part No. | Details | ZIP Drop-In Zip Valve™ Parts | Tooling |
|--|---|----------------|------------------------------------|------------------------------|---|
| Multiple Symptoms | | | | | |
| Comprehensive kit for big problems you don't want back | The Sure Cure® Kit | SC-01M/01N/01P | 01M, 01N, 01P only | | F-119940-TL3*, 119940-TL4‡, F-119940-TL5*‡, F-119940-TL6* |
| TCC/Lockup Symptoms | | | | | |
| No lockup, Falls out of lockup, Code 1582, Engine stall on engagement | Oversized TCC Apply Valve Kit | 1 119940-04K | 01M, 01N, 01P only | | 119940-TL4‡, 119940-BST † |
| Engine stall on stop, Engine stall on N-D engagement, Overheated converter | TCC Boost Valve Kit | 2 119940-01K | Z!P 01M, 01N, 01P only | | |
| High TCC apply pressure, TCC slip codes, Converter hub & stator damage | TCC Regulator Valve Spring | 3 119940-19 | 01M, 01N, 01P only, 5/bag | | |
| Pressure Problems | | | | | |
| Harsh Reverse, Delayed engagement, Low pressure, Engine stall at idle, No line rise | Oversized Boost Regulator Valve Kit | 4 119940-05K | 01M, 01N, 01P only | | F-119940-TL5*‡ |
| Delayed engagement, Engine stall at idle, High line pressure in Reverse, No line rise | Oversized Main Pressure Regulator Valve Kit | 5 119940-03K | 01M, 01N, 01P only | | F-119940-TL3* |
| Broken end plugs, Line pressure cannot be adjusted | Ratcheting End Plug | 6 119940-22 | Z!P | | 119940-TL9 †‡ |
| 2-3 Late, No 3-4, Wrong gear starts, No line rise, No 2-3, 3-4 Late, 2-3 Bind-up, Loss of gear | Oversized Solenoid Regulator Valve | 7 119940-06K | | | F-119940-TL6* |
| Shift/Engagement Concerns | | | | | |
| 2-3 Concerns, 3-2 Concerns, Soft shifts, Erratic buzz, Uncontrolled pressure in Reverse | Checkball Springs | 8 119940-20 | 01M, 01N, 01P phase 2 only, 10/bag | | |
| Broken end plugs, No shift, Uncontrolled shifts | Shift Cup Kit | 9 119940K | Z!P 01M, 01N, 01P only | | |

* VB-FIX Required

† Recommended Tool

‡ No longer in production. Check with your distributor for availability.