

GM 4L60-E, 4L65-E, 4L70-E

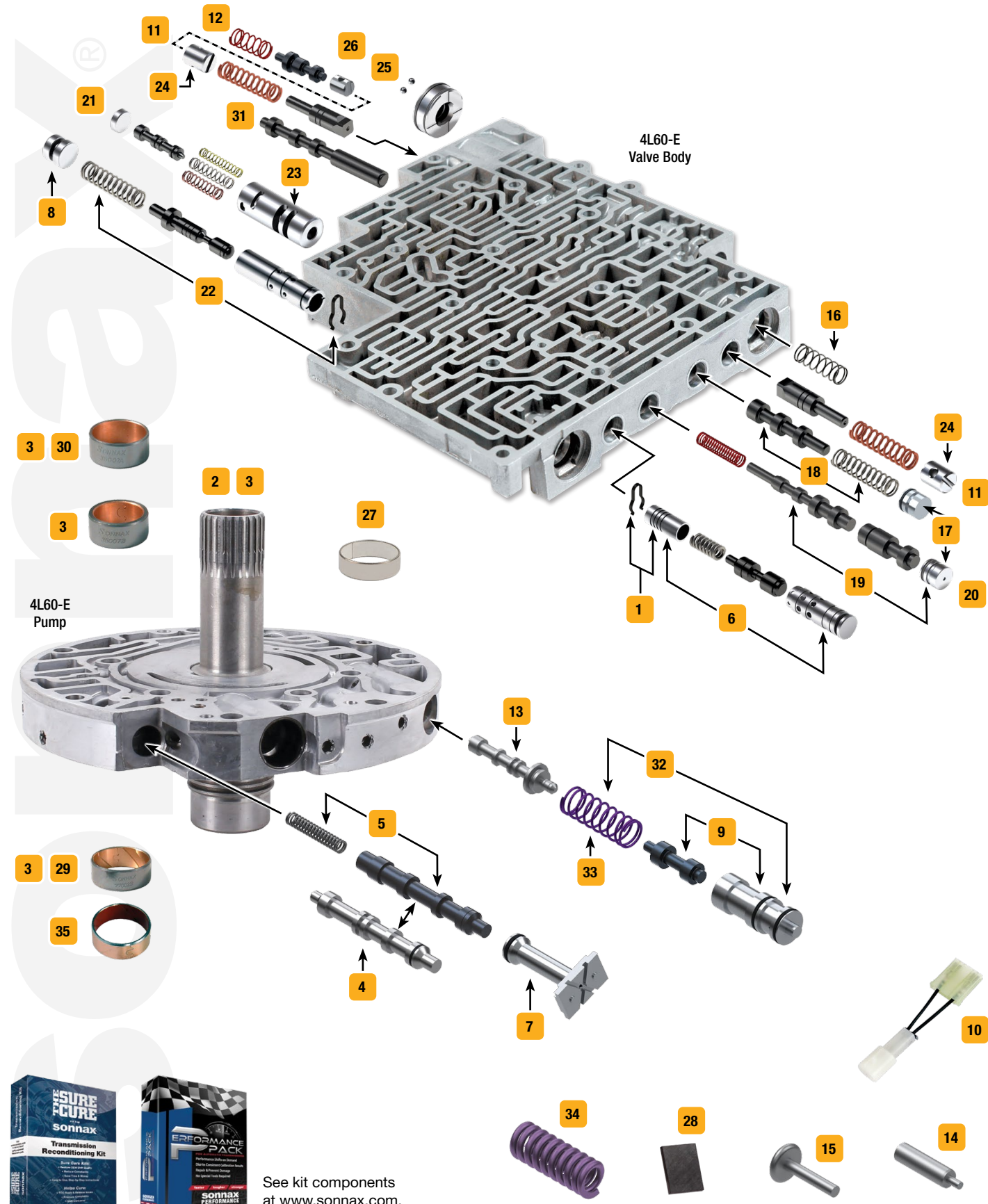

Click on part numbers for product details or visit www.sonnax.com to see all products for the unit(s) shown here.



See kit components at www.sonnax.com.

| Symptoms/Benefits | Product Name | Part No. | Details | Tooling |
|--|---|--------------|--|---|
| Multiple Symptoms | | | | |
| Comprehensive kit for big problems you don't want back | The Sure Cure® Kit | SC-4L60E | '95-Later with PWM/EC3 control | 77754-R2, 77754-TL, 77917-TL |
| TCC/Lockup Symptoms | | | | |
| Code 894, 1870, TCC cycling, TCC slip, 3-4 Clutch failure | Isolator Sleeve Kit | 1 77754-ISO | For worn isolator bore in unserviced valve body or for any factory-remanufactured valve body | F-77754-TL4*, 77754-RM5, 77754-R2, 77754-SERV |
| 3-4 Clutch failure, Code 894, 1870, Overheated converter, No 3rd, Delayed Reverse | Stator Support Shaft Assembly | 2 77918S-1K | 280mm or 300mm Converter, non-reluctor style, bushing installed | |
| | Stator Support Shaft Assembly | 2 77918S-08K | 298mm Converter, reluctor style, bushing installed | |
| | Stator Support Shaft Assembly | 2 77918S-09K | 280mm or 300mm Converter, reluctor style, bushing installed | |
| Overheated converter, Worn splines, TCC apply & release concerns | Stator Support Shaft Kit | 3 77918S-K | 4L60-E '83-'04 only, 6.830" long, includes 3 bushings | |
| No lockup, Falls out of lockup when hot, Fluid blown out fill tube | TCC Apply Valve Kit | 4 77805-K | ZIP 4L60-E only, non-PWM steel with PTFE seal | |
| No lockup, Code 894, 1870, Falls out of lockup when hot, Fluid blown out fill tube | TCC Apply Valve Kit | 5 77805E-K | ZIP PWM, aluminum with PTFE seal | |
| Code 894, 1870, Overheated converter, Low TCC apply pressure, 3-4 Clutch burned, 1-2 Harsh | TCC Regulator & Isolator Valve Kit | 6 77754-04K | Fits all years & '98-later EC3 units | F-77754-TL4*, F-77754-SERV*‡, 77754-R2, 77754-SERV, 77754-RM5 |
| | TCC Regulator & Isolator Valve Kit | 6 77754-03K | 4L60-E '97-earlier only, non-EC3 | F-77754-TL4*, F-77754-SERV*‡, 77754-R2, 77754-SERV, 77754-RM5 |
| TCC apply concerns, Overheated converter, Loss of lube oil | TCC Solenoid Snout Kit | 7 77942-01K | 4L60-E '96-earlier only | |
| | TCC Solenoid Snout Kit | 7 77942-02K | '97-Later PWM, anti-drainback valve | |
| Pressure Problems | | | | |
| Lost or damaged component | AFL Valve End Plug | 8 77754-39 | 5/Bag | |
| 3-4 Clutch failure, 2-4 Band failure, Low line rise, Poor shift quality | Boost Valve Kit | 9 77898E-6K | ZIP Early style, .470" dia., OE ratio, factory style | |
| | Boost Valve Kit | 9 77898E-4K | ZIP Early style, .470" dia., OE ratio, O-ring style | |
| | Boost Valve Kit | 9 77898E-3K | ZIP Early style, .490" dia., increased ratio, factory style | |
| | Boost Valve Kit | 9 77898E-K | ZIP Early style, .490" dia., increased ratio, O-ring style | |
| | Boost Valve Kit | 9 77898E-16K | ZIP Late style, .472" dia., OE ratio, O-ring style | |
| | Boost Valve Kit | 9 77898E-14K | ZIP Late style, .421" dia. OE ratio, O-ring style | |
| Line pressure instability | EPC Solenoid Harness Adapter | 10 34435-01K | For use with early-style ('92-'02) EPC solenoid in late-style ('03-later) units, solenoid not included | |
| Delayed Forward, Delayed Reverse, Forward or Low/Reverse clutch distress | Forward & Reverse Abuse Valve Kit | 11 77754-35K | ZIP Fits either of 2 locations | |
| | Oversized Forward & Reverse Abuse Valve Kit | 11 77754-58K | Fits either of 2 locations | F-77754-TL58* |
| Burnt Reverse clutch, Burnt Low/Reverse clutch, No Reverse, No Manual 1st | Oversized Low Overrun Valve Kit | 12 77754-62K | | F-77754-TL62* |
| Erratic line pressure, Low line rise, 3-4 Clutch failure, Excess pump noise, Reverse chatter | Oversized Pressure Regulator Valve | 13 77917-07 | | 77917-TL, 77917-TLC |
| Low line pressure, High line pressure | Pump Slide Pivot Pin | 14 65797 | 5/Bag | |
| Erratic line pressure | Pump Spring Spacer | 15 77917-RV | 10/Bag | |

GM 4L60-E, 4L65-E, 4L70-E



Click on part numbers for product details or visit www.sonnax.com to see all products for the unit(s) shown here.

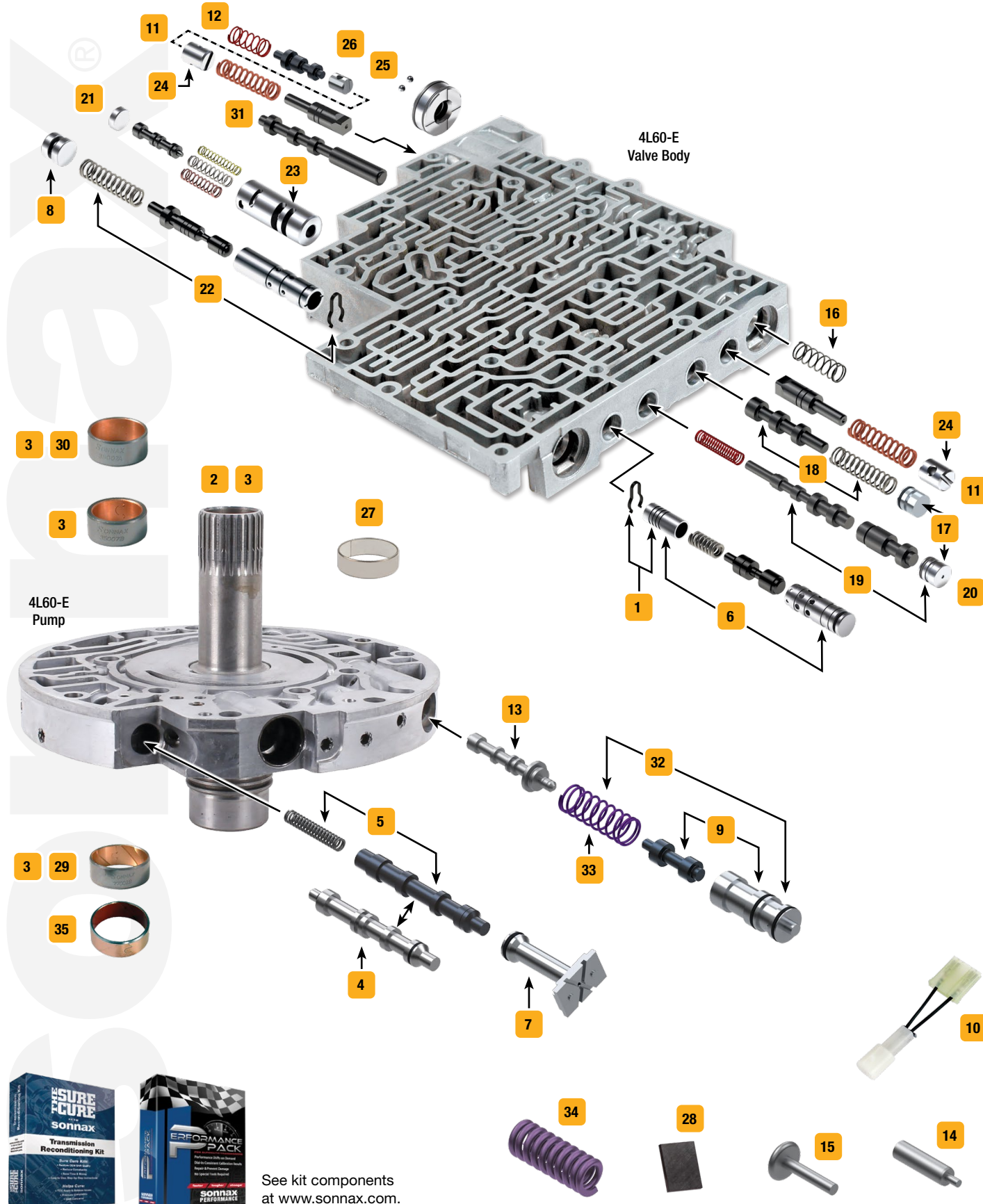

See kit components at www.sonnax.com.

| Symptoms/Benefits | Product Name | Part No. | Details | Drop-In Zip Valve™ Parts | Tooling |
|--|--|---------------|---|--------------------------|---------------|
| Shift/Engagement Concerns | | | | | |
| Broken 3-2 control valve spring, 3-2 Bind-up, Overheated 2-4 band | 3-2 Control Valve Spring | 16 77754-23 | '96-Later on/off style 3-2 control | | |
| Loss of D3 oil, Loss of 4th signal oil, No 4th, Drops out of 4th | 3-4 Relay O-Ringed End Plug Kit | 17 77964-08K | Fits 2 locations, includes 5 end plugs | | |
| 2nd Gear starts, Low AFL pressure, 3rd Clutch failure, 3-4 Concerns | Oversized 3-4 Shift Valve Kit | 18 77754-42K | | | F-77754-TL42* |
| No 4th, 2-4 Band burned, Low 4th Gear pressure | Oversized 4-3 Sequence Valve Kit | 19 77964-04K | Does not address wear at inboard 2 spools | | 77964-RM2 |
| 2-4 Band burned, Low 4th Gear pressure, No 4th, 2nd Quality poor | Oversized 4-3 Sequence Valve Kit | 20 77964-14K | Use with OE valve/bore only, addresses wear at inboard 2 spools & other locations | | F-77964-TL14* |
| 1-2 Bang at light throttle, Reduced 2-4 band life | Accumulator Valve Train Kit | 21 77777L-K | ZIP 4L60-E only, "L" version valve train in light/medium vehicles, .330" dia. | | |
| | Accumulator Valve Train Kit | 21 77777M-K | ZIP 4L60-E only, "M" version valve train in heavy vehicles, .341" dia. | | |
| | Accumulator Valve Train Kit | 21 77754-10K | ZIP For valve trains with sleeve stamp codes CX, DX or YZ only | | |
| Wrong gear starts, Erratic line pressure, Solenoid performance codes, Clutch failure, No 4th | Actuator Feed Limit Valve Kit | 22 77754-09K | | | 77754-TL |
| 3-4 Bump, Bang shifts, Harsh shifts, Reduced 2-4 band life, Soft shifts | AX Code Accumulator Valve Sleeve | 23 77754-61 | ZIP "AX" code, sleeve only | | |
| Delayed Reverse, 3-4 Clutch burned, Burnt Low/Reverse clutch, 2-4 Band burned, 3-2 Bind-up | Forward & Reverse Abuse Bore Plug | 24 77754-21 | ZIP Fits either of 2 locations | | |
| Cracked pistons, Burnt clutches & bands, Forward slip, Delayed engagement | Forward Accumulator Piston | 25 74927-AP | ZIP OE 8686017, 24200126 | | |
| Aluminum pistons wear at the pin bore, Cracked pistons, Delayed engagement, Forward slip | Pinless Forward Accumulator Piston Kit | 26 77987-01K | ZIP Dual-seal design | | |
| Component Damage/Failure | | | | | |
| Worn pump bushing | Bushing | 27 77005T | Precision, PTFE-lined | | |
| Lost or damaged component | Pump Vane | 28 1280 | Koyo® (OE), 100/bag | | |
| Bushing wear, Bushing failure | Rear Stator Support Bushing | 29 77002B | Precision, wider than OE | | |
| | Stator Support Bushing | 30 35007A | '84-Later, 1.004" I.D., precision | | |
| High Performance/Heavy Duty Upgrades | | | | | |
| Improves input sprag & FWD clutch life | Heavy Duty 2-3 Shift Valve | 31 77754-41 | ZIP | | |
| The best parts for performance & heavy-duty recalibration | Performance Pack | HP-4L60E-01 | '94-Later | | |
| Classic, large-ratio boost valve for crisp, clean shifts without harshness | Line Pressure Booster Kit | 32 4L60E-LB1 | ZIP 4L60-E, 4L65-E only, early style | | |
| | Line Pressure Booster Kit | 32 4L60E-LB2 | ZIP Late style | | |
| Increased line pressure & firmer shifts | High Performance Pressure Regulator Spring | 33 77917-10 | | | |
| Maintains high volume slide position at high RPM | Pump Slide Spring | 34 77722-01K | Replaces 2 OE springs, 5/bag | | |
| Wider, improved fit & longer lasting | Rear Stator Support Bushing | 35 77002BT-01 | Precision, PTFE-lined | | |
| Tools | | | | | |
| | Vacuum Test Plate Kit | 77754-VTP | | | VACTEST-01K |