



Critical Wear Areas & Vacuum Test Locations

NOTE: OE valves are shown in rest position and should be tested in rest position unless otherwise indicated. Test locations are pointed to with an arrow. Springs are not shown for visual clarity. Low vacuum reading indicates wear and Sonnax parts are noted for replacement.

PBC (Park by Cable) Valve Bodies • 948TE Shown



For specific vacuum test information, refer to individual part instructions included in kits and available at www.sonnax.com.
 Click on Sonnax part numbers to see more information.

F Dog Clutch Plunger Valve 

- Loss of higher gears
- Damaged F dog clutch

Replace with Sonnax Part Nos.
85740-05K (.227 dia.) or
85740-22K (.196 dia.)

E Clutch Valve (CV-E)

- No 3-4
- Gear ratio errors
- Loss of higher gears

Lockup Clutch Valve (LC-V)

- TCC slip codes
- Overheating
- TCC lining failure

System Pressure Valve (SP-V)

- Low line pressure
- High line pressure
- Harsh shifts/downshifts

Replace with Sonnax Part No.
85740-15K Requires F-85740-TL15 & VB-FIX

Limp Home Valve

- 4th Gear starts
- Stuck in limp mode

B Clutch Valve (CV-B)

- No Reverse • 2-3 Flare
- No 5th • Gear ratio errors

Solenoid Pressure Regulator Valve (PR-V) 

- Solenoid performance codes
- Low solenoid feed pressure

Replace with Sonnax Part Nos.
85740-09K or
85740-11K Requires F-68942-TL14 & VB-FIX

Upper Valve Body

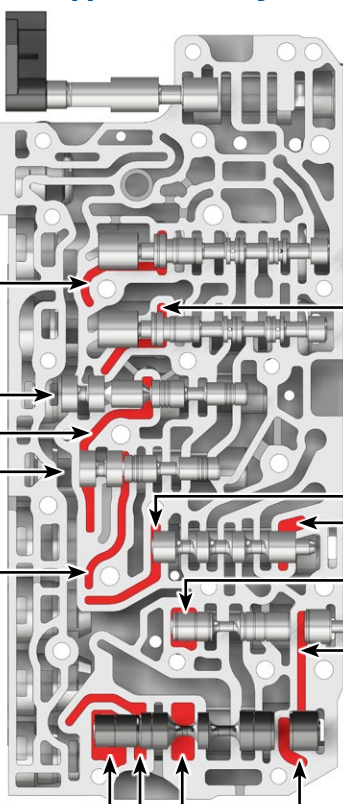

A Dog Clutch Plunger Valve 

- Loss of higher gears
- Damaged A dog clutch

Replace with Sonnax Part Nos.
85740-05K (.227 dia.) or
85740-22K (.196 dia.)

Converter Switch Valve (SP-V)

- TCC slip codes • TCC lining failure
- TCC apply & release codes

Lubrication Valve (LU-V)

- Low cooler flow
- Overheating
- Low converter & lube flow

End Plugs 

- Soft shifts • Flare shifts • Harsh shifts
- Burnt Clutches
- Pressure Loss

Replace with Sonnax Part No.
85740-01K
 End Plugs (4) = ⊙
 Internal End Plugs (2) = ◇

C Clutch Valve (CV-C)

- 1-2 Flare
- No 6th
- Gear ratio errors

D Clutch Valve (CV-D)

- No Forward • No Reverse
- Loss of higher gears
- Reverse slip • Forward slip

Shift Valve System Pressure (SV-SP) 

- Poor line pressure control
- Poor shift quality
- Gear ratio errors

Replace with Sonnax Part No.
85740-07K

Lower Valve Body

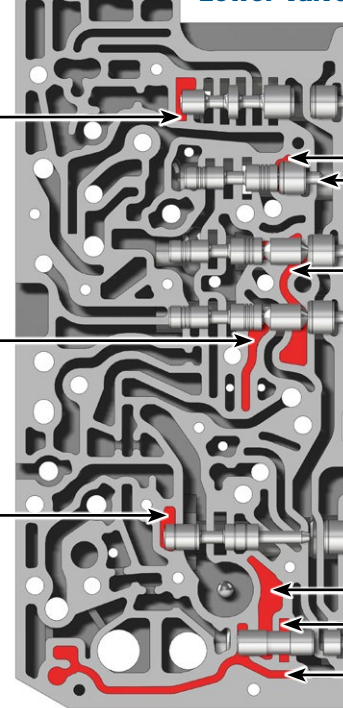

Critical Wear Areas & Vacuum Test Locations

NOTE: OE valves are shown in rest position and should be tested in rest position unless otherwise indicated. Test locations are pointed to with an arrow. Springs are not shown for visual clarity. Low vacuum reading indicates wear and Sonnax parts are noted for replacement.

PBW (Park by Wire) Valve Bodies

• 948TE Shown



For specific vacuum test information, refer to individual part instructions included in kits and available at www.sonnax.com.

Click on Sonnax part numbers to see more information.

Upper Valve Body

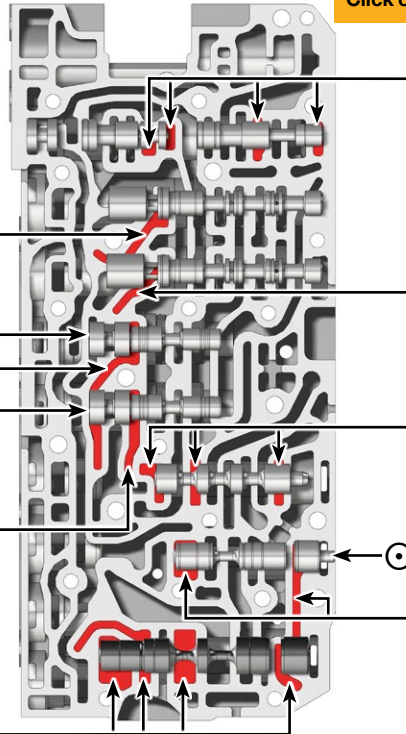

F Dog Clutch Plunger Valve

- Loss of higher gears
- Damaged F dog clutch

Replace with Sonnax Part No. **85740-05K**

Park Cylinder Valves 1 (PCV-1) & 2 (PCV-2)

- Park position release & apply concerns

A Dog Clutch Plunger Valve

- Loss of higher gears
- Damaged A dog clutch

Replace with Sonnax Part No. **85740-05K**

E Clutch Valve (CV-E)

- No 3-4
- Gear ratio errors
- Loss of higher gears

Converter Switch Valve (SP-V)

- TCC slip codes • TCC lining failure
- TCC apply & release codes

B Clutch Valve (CV-B)

- No Reverse
- 2-3 Flare
- No 5th

Lubrication Valve (LU-V)

- Low cooler flow
- Overheating
- Low converter & lube flow

System Pressure Valve (SP-V)

- Low line pressure
- High line pressure
- Harsh shifts/downshifts

Replace with Sonnax Part No. **85740-15K** Requires F-85740-TL15 & VB-FIX

Lower Valve Body

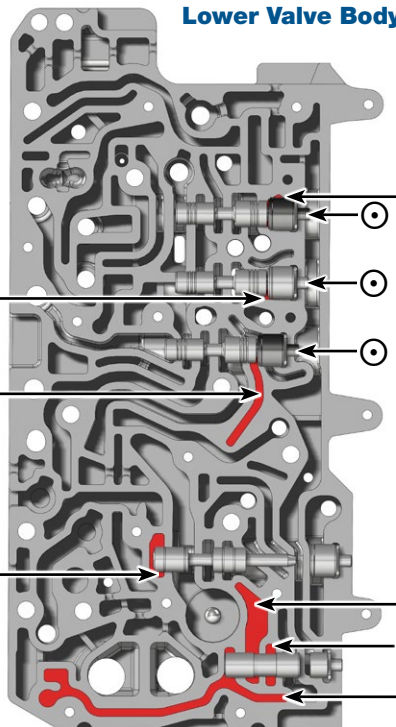

End Plugs

- Soft shifts • Flare shifts • Harsh shifts
- Burnt Clutches
- Pressure Loss

Replace with Sonnax Part No. **85740-01K**

End Plugs (4) = ⊙
 Internal End Plugs (2) = ◇

D Clutch Valve (CV-D)

- No Engagement
- Slips in Reverse & 1st
- Loss of higher gears

C Clutch Valve (CV-C)

- 1-2 Flare
- No 6th
- Gear ratio errors

Lockup Clutch Valve (LC-V)

- TCC slip codes
- Overheating
- TCC lining failure

Solenoid Pressure Regulator Valve (PR-V)

- Solenoid performance codes
- Low solenoid feed pressure

Replace with Sonnax Part Nos. **85740-09K** or **85740-11K** Requires F-68942-TL14 & VB-FIX

Shift Valve System Pressure (SV-SP)

- Poor line pressure control
- Poor shift quality
- Gear ratio errors

Replace with Sonnax Part No. **85740-07K**

OE Exploded View

Upper Valve Body • 948TE, PBC Shown

NOTE: Depending upon vehicle application, the OE springs shown may not be present.

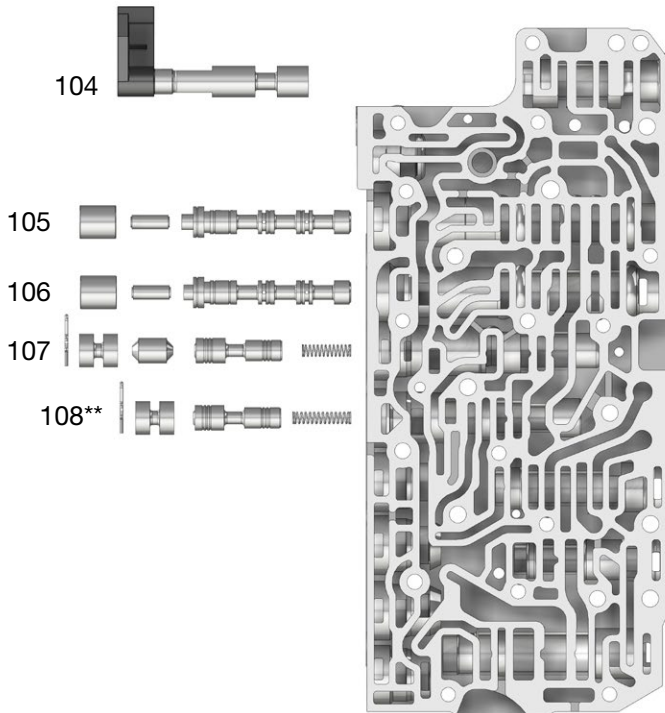

Upper Valve Body Descriptions

I.D. No.	Description
101	Converter Switch Valve (SP-V)
102	Lubrication Valve (LU-V)
103	System Pressure Valve (SP-V)
104	Manual Valve
105	F Dog Clutch Valve (CV-F)
106	A Dog Clutch Valve (CV-A)
107	E Clutch Valve (CV-E)
108	Lockup Clutch Valve (LC-V)**

** Valve location is different between PBC and PBW

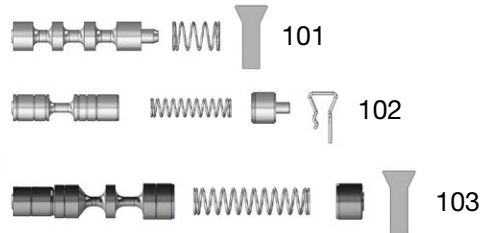

Lower Valve Body • 948TE, PBC Shown

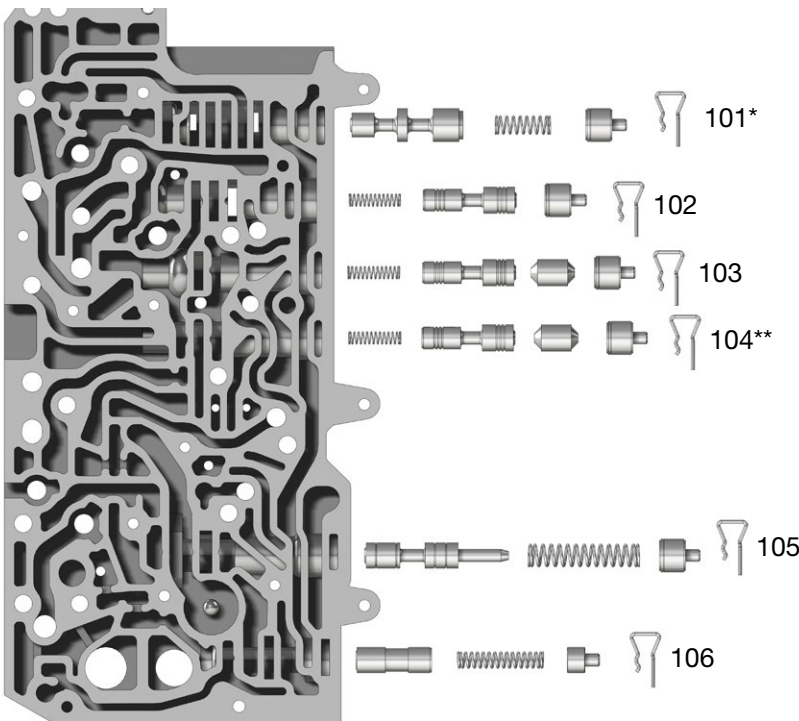

Upper Valve Body Descriptions

I.D. No.	Description
101	Limp Home Valve*
102	C Clutch Valve (CV-C)
103	D Clutch Valve (CV-D)
104	B Clutch Valve (CV-B)**
105	Solenoid Pressure Regulator Valve (PR-V)
106	Shift Valve System Pressure (SV-SP)

* PBW does not have this valve.

** Valve location is different between PBC and PBW

OE Exploded View

Upper Valve Body • 948TE, PBW Shown

NOTE: Depending on vehicle application, the OE springs shown may not be present.

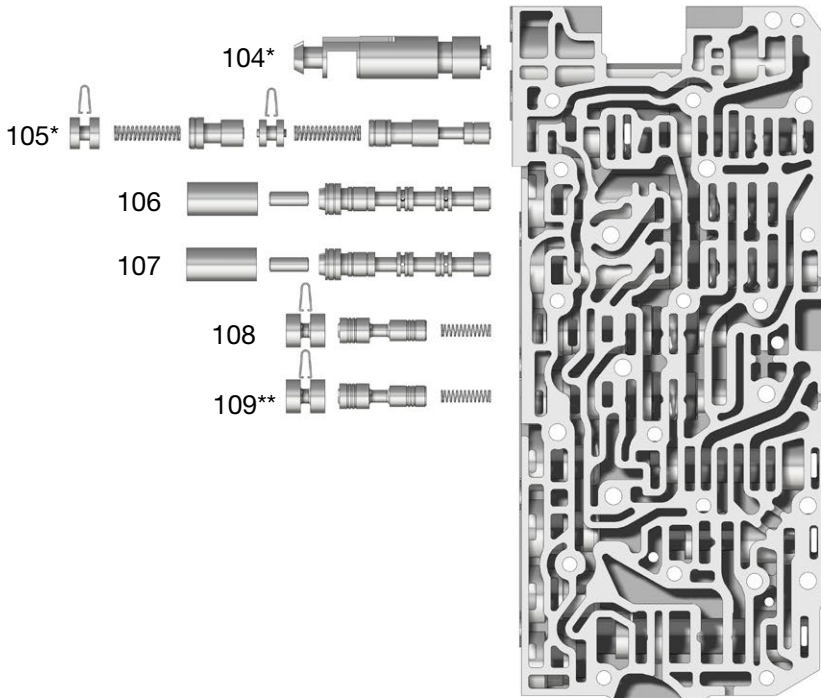

Upper Valve Body Descriptions

I.D. No.	Description
101	Converter Switch Valve (SP-V)
102	Lubrication Valve (LU-V)
103	System Pressure Valve (SP-V)
104	Park Cylinder (PCYL)*
105	Park Cylinder Valve (PCV-1, -2)*
106	F Dog Clutch Valve (CV-F)
107	A Dog Clutch Valve (CV-A)
108	E Clutch Valve (CV-E)
109	B Clutch Valve (CV-B)**

* PBC does not have this valve.

** Valve location is different between PBC and PBW

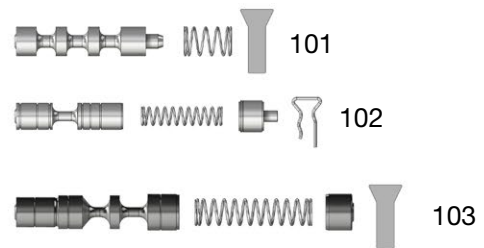

Lower Valve Body • 948TE, PBW Shown

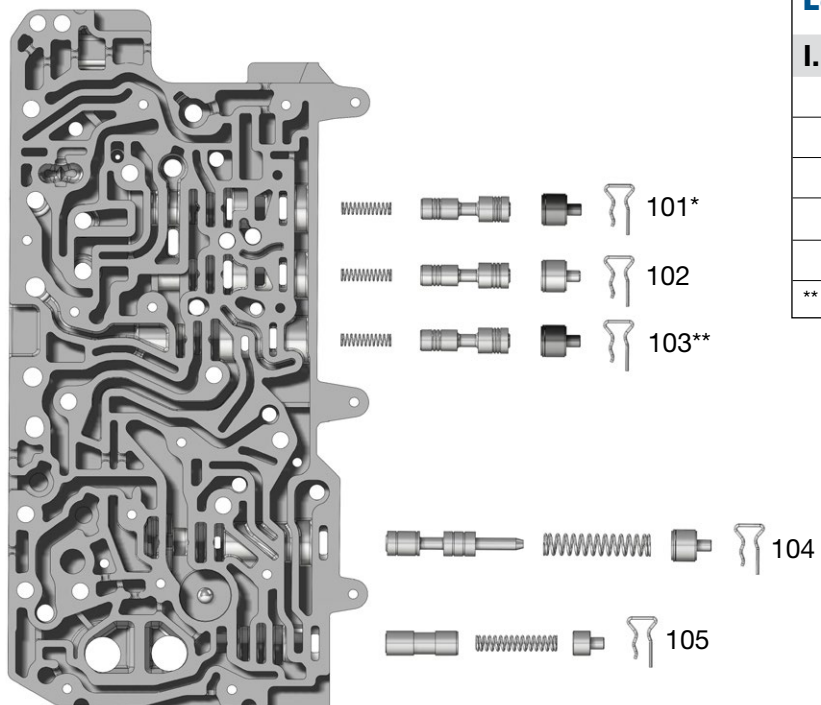

Lower Valve Body Descriptions

I.D. No.	Description
101	C Clutch Valve (CV-C)
102	D Clutch Valve (CV-D)
103	Lockup Clutch Valve (LC-V)**
104	Solenoid Pressure Regulator Valve (PR-V)
105	Shift Valve System Pressure (SV-SP)

** Valve location is different between PBC and PBW