

Critical Wear Areas & Vacuum Test Locations

Drop-In Zip Valve™
Parts Available

NOTE: OE valves are shown in rest position and should be tested in rest position unless otherwise indicated. Test locations are pointed to with an arrow. Springs are not shown for visual clarity. Low vacuum reading indicates wear and Sonnax parts are noted for replacement.

Upper Valve Body • AS69RC Shown



For specific vacuum test information, refer to individual part instructions included in kits and available at www.sonnax.com.

Click on Sonnax part numbers to see more information.

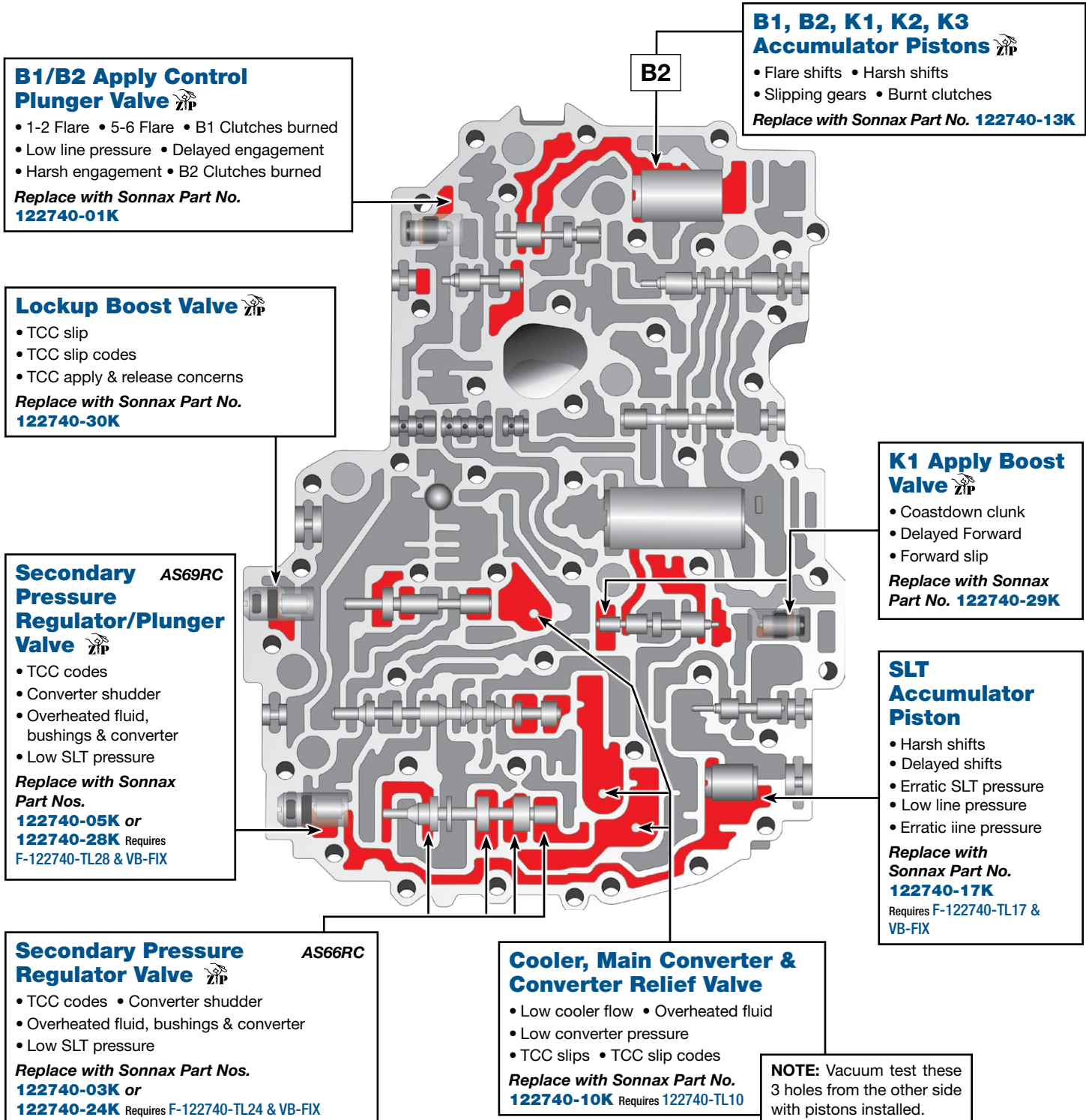

B1, B2, K1, K2, K3 Accumulator Pistons
 • Flare shifts • Harsh shifts
 • Slipping gears • Burnt clutches
 Replace with Sonnax Part No. **122740-13K**

B1/B2 Apply Control Plunger Valve
 • 1-2 Flare • 5-6 Flare • B1 Clutches burned
 • Low line pressure • Delayed engagement
 • Harsh engagement • B2 Clutches burned
 Replace with Sonnax Part No. **122740-01K**

Lockup Boost Valve
 • TCC slip
 • TCC slip codes
 • TCC apply & release concerns
 Replace with Sonnax Part No. **122740-30K**

Secondary Pressure Regulator/Plunger Valve AS69RC
 • TCC codes
 • Converter shudder
 • Overheated fluid, bushings & converter
 • Low SLT pressure
 Replace with Sonnax Part Nos. **122740-05K** or **122740-28K** Requires F-122740-TL28 & VB-FIX

K1 Apply Boost Valve
 • Coastdown clunk
 • Delayed Forward
 • Forward slip
 Replace with Sonnax Part No. **122740-29K**

SLT Accumulator Piston
 • Harsh shifts
 • Delayed shifts
 • Erratic SLT pressure
 • Low line pressure
 • Erratic line pressure
 Replace with Sonnax Part No. **122740-17K** Requires F-122740-TL17 & VB-FIX

Secondary Pressure Regulator Valve AS66RC
 • TCC codes • Converter shudder
 • Overheated fluid, bushings & converter
 • Low SLT pressure
 Replace with Sonnax Part Nos. **122740-03K** or **122740-24K** Requires F-122740-TL24 & VB-FIX

Cooler, Main Converter & Converter Relief Valve
 • Low cooler flow • Overheated fluid
 • Low converter pressure
 • TCC slips • TCC slip codes
 Replace with Sonnax Part No. **122740-10K** Requires 122740-TL10

NOTE: Vacuum test these 3 holes from the other side with pistons installed.

Critical Wear Areas & Vacuum Test Locations

ZIP Drop-In Zip Valve™
Parts Available

NOTE: OE valves are shown in rest position and should be tested in rest position unless otherwise indicated. Test locations are pointed to with an arrow. Springs are not shown for visual clarity. Low vacuum reading indicates wear and Sonnax parts are noted for replacement.

Lower Valve Body • AS69RC Shown



For specific vacuum test information, refer to individual part instructions included in kits and available at www.sonnax.com.

Click on Sonnax part numbers to see more information.

B1, B2, K1, K2, K3 Accumulator Pistons

- Flare shifts
- Harsh shifts
- Slipping gears
- Burnt clutches

Replace with Sonnax Part Nos. **122740-13K**

B1/B2 Apply Control Plunger Valve

- 1-2 Flare
- 5-6 Flare
- B1 Clutches burned
- Low line pressure
- Delayed engagement
- Harsh engagement
- B2 Clutches burned

Replace with Sonnax Part No. **122740-01K**

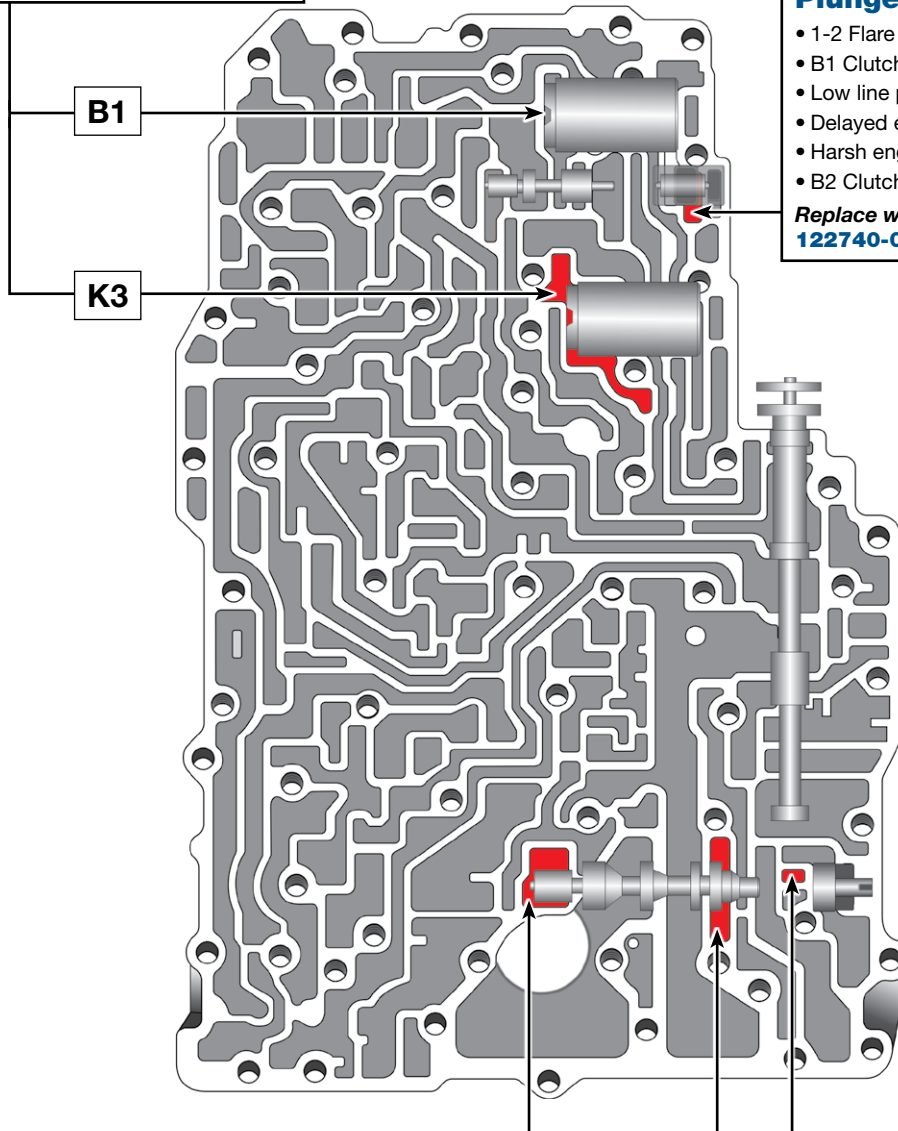

Main Pressure Regulator Valve

- High line pressure
- Low line pressure
- Poor shift quality
- Burnt clutches

Replace with Sonnax Part Nos. **122740-07K** Requires F-122740-TL7 & VB-FIX

OE Exploded View

Upper Valve Body • AS69RC Shown

NOTE: Depending upon vehicle application, the OE springs shown may not be present.

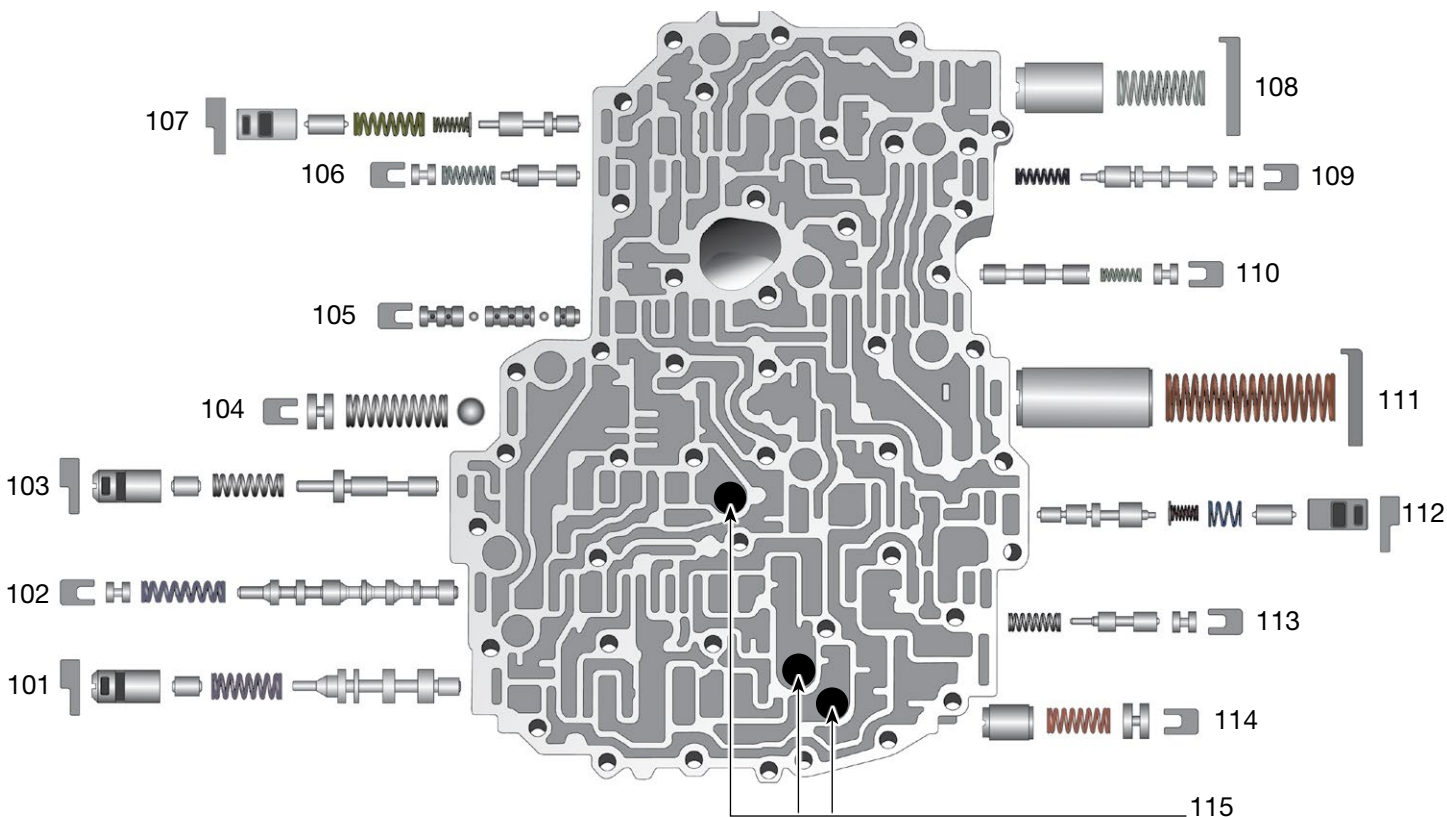

Upper Valve Body Descriptions

I.D. No.	Description
101	Secondary Pressure Regulator Valve
102	TCC Relay Valve
103	Lockup Boost Valve
104	Line Pressure Blow Off Ball & Spring
105	Signal Check Valve
106	B2 Relay Valve
107	B2 Apply Control Plunger Valve
108	B2 Apply Piston
109	Clutch Apply Relay Valve No. 1
110	Clutch Apply Relay Valve No. 2
111	K1 Accumulator Piston
112	K1 Apply Boost Valve
113	Solenoid Modulator Valve
114	SLT Accumulator Piston
115	Cooler, Main Converter & Converter Relief Valve

OE Exploded View

Lower Valve Body • AS69RC Shown

NOTE: Depending upon vehicle application, the OE springs shown may not be present.

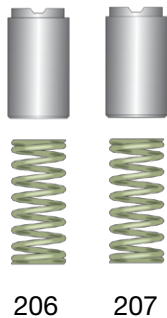
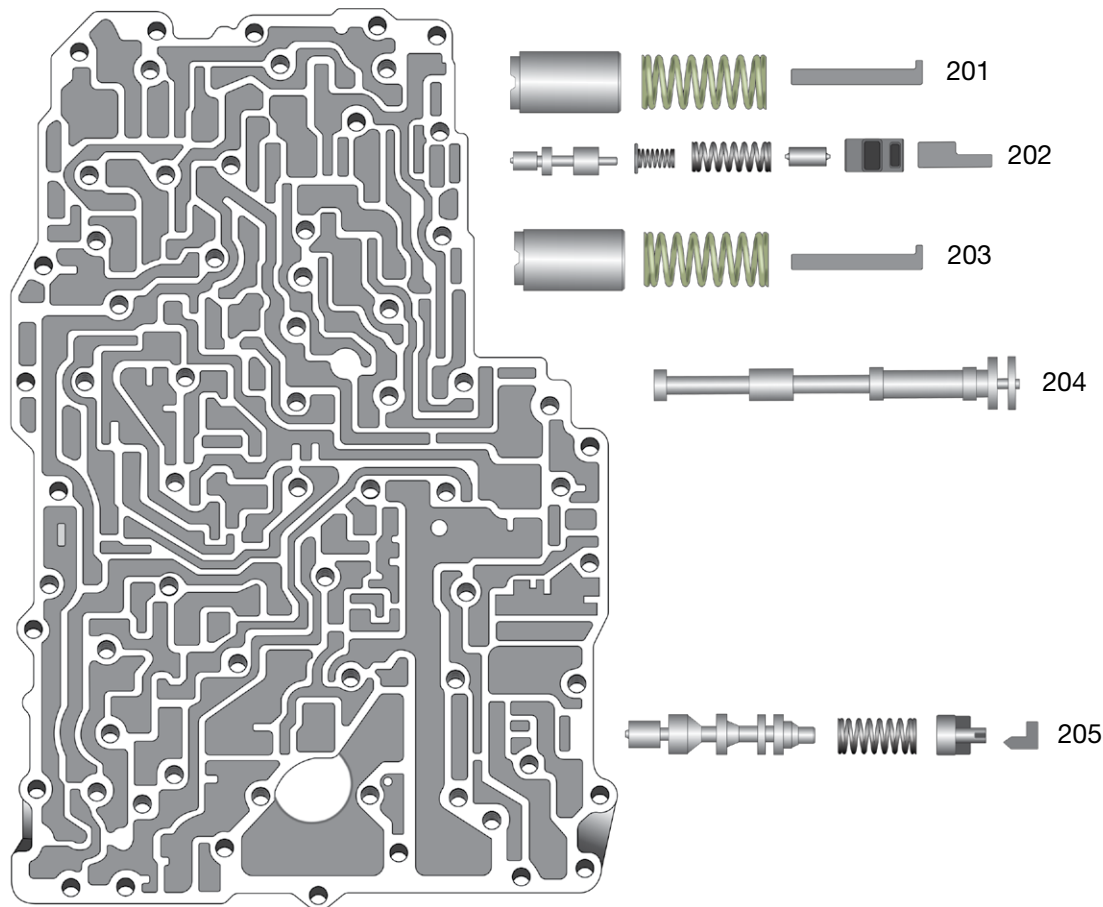

NOTE: K1 & K2 piston kits are installed on underside.

Lower Valve Body Descriptions

I.D. No.	Description
201	B1 Accumulator Piston
202	B1 Apply Control Plunger Valve
203	K3 Accumulator Piston
204	Manual Valve
205	Main Pressure Regulator Valve
206	K1 Accumulator Piston
207	K2 Accumulator Piston