

# Critical Wear Areas & Vacuum Test Locations



**NOTE:** OE valves are shown in rest position and should be tested in rest position unless otherwise indicated. Test locations are pointed to with an arrow. Springs are not shown for visual clarity. Low vacuum reading indicates wear and Sonnax parts are noted for replacement.

## Front Control Valve Body - Top Side (Bottom Side Inset) Shown



For specific vacuum test information, refer to individual part instructions included in kits and available at [www.sonnax.com](http://www.sonnax.com).

**Neutral Relay Valve**

- Delayed engagement
- Loss of Neutral control feature

**NOTE:** Prop valve in outboard position with checkball and seal port on opposite side of casting.

Seal for Neutral relay valve vacuum test.

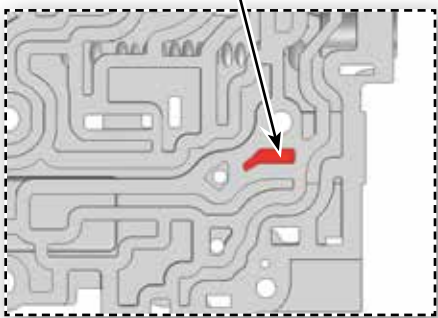

Front Control Valve Body  
Bottom Side

**Solenoid B-1 Modulator Valve No. 2**

Shift concerns in 2nd & 4th

**NOTE:** Invert valve (as shown) to test.

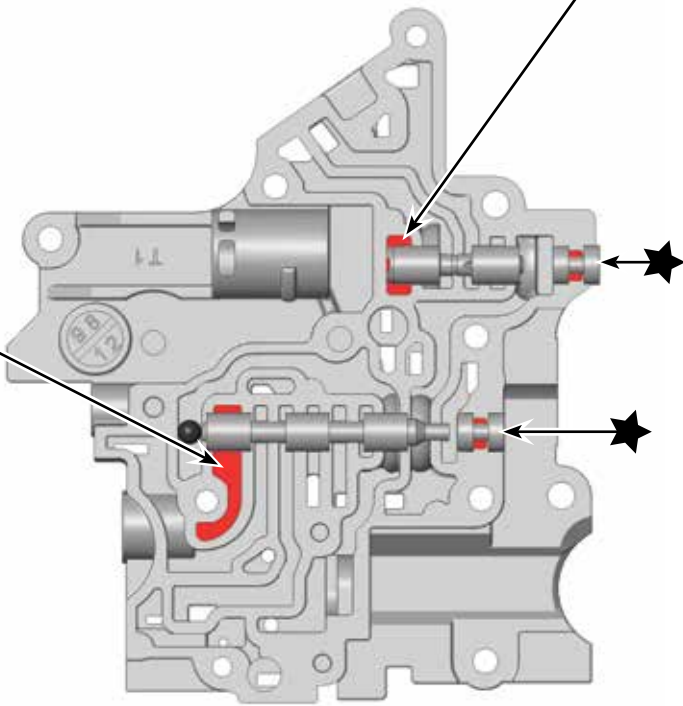

Front Control Valve Body  
Top Side

**End Plugs**

- Various shift concerns
- Pressure loss
- Burnt clutches
- TCC apply concerns

**Replace with Sonnax Part No. 19741-15K**

**NOTE:** Several Locations = ★

# Critical Wear Areas & Vacuum Test Locations



**NOTE:** OE valves are shown in rest position and should be tested in rest position unless otherwise indicated. Test locations are pointed to with an arrow. Springs are not shown for visual clarity. Low vacuum reading indicates wear and Sonnax parts are noted for replacement.

## Middle Control Valve Body - Top & Bottom Sides Shown

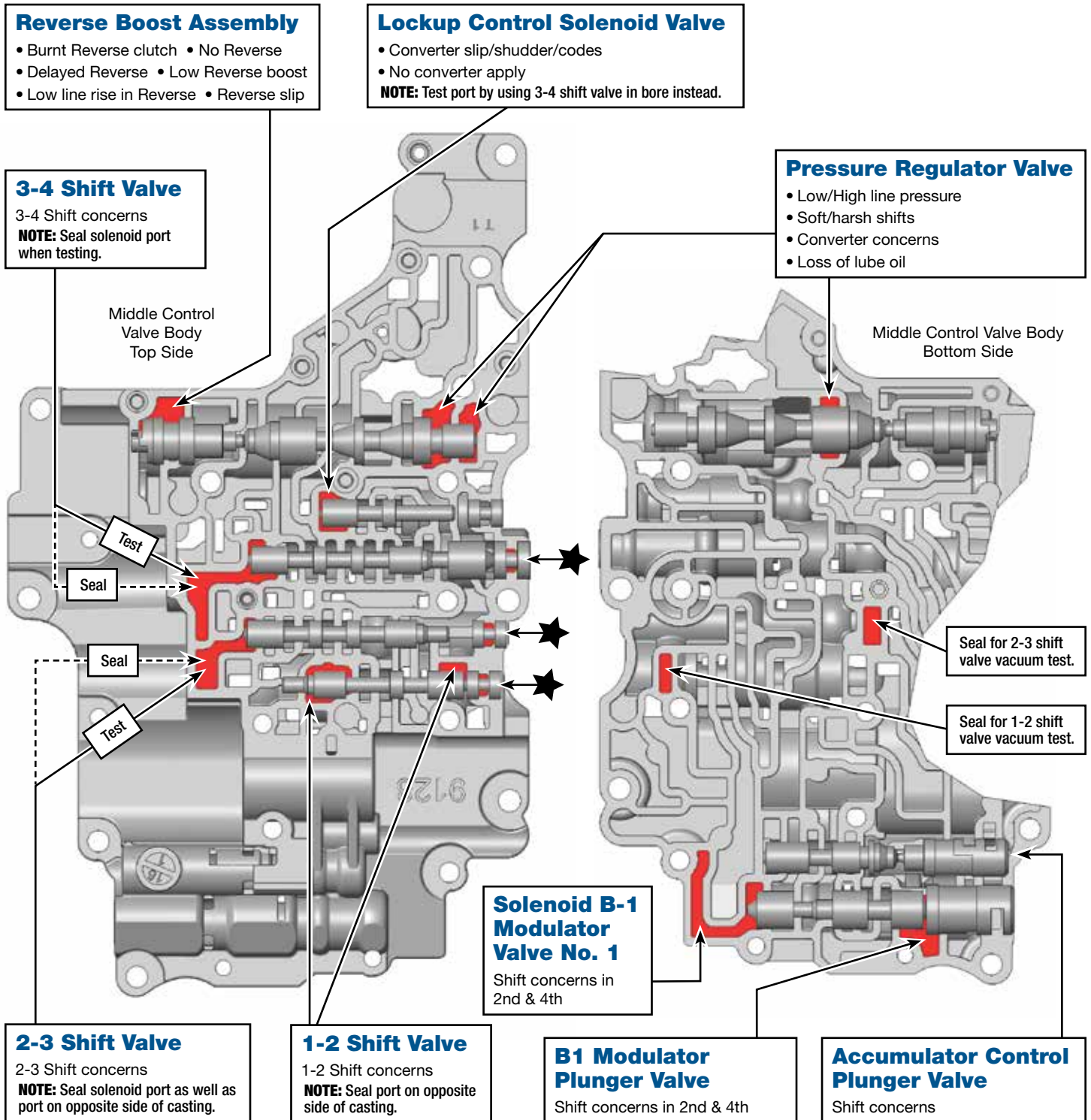

# Critical Wear Areas & Vacuum Test Locations



**NOTE:** OE valves are shown in rest position and should be tested in rest position unless otherwise indicated. Test locations are pointed to with an arrow. Springs are not shown for visual clarity. Low vacuum reading indicates wear and Sonnax parts are noted for replacement.

## Rear Control Valve Body - Top Side (Bottom Side Inset) Shown

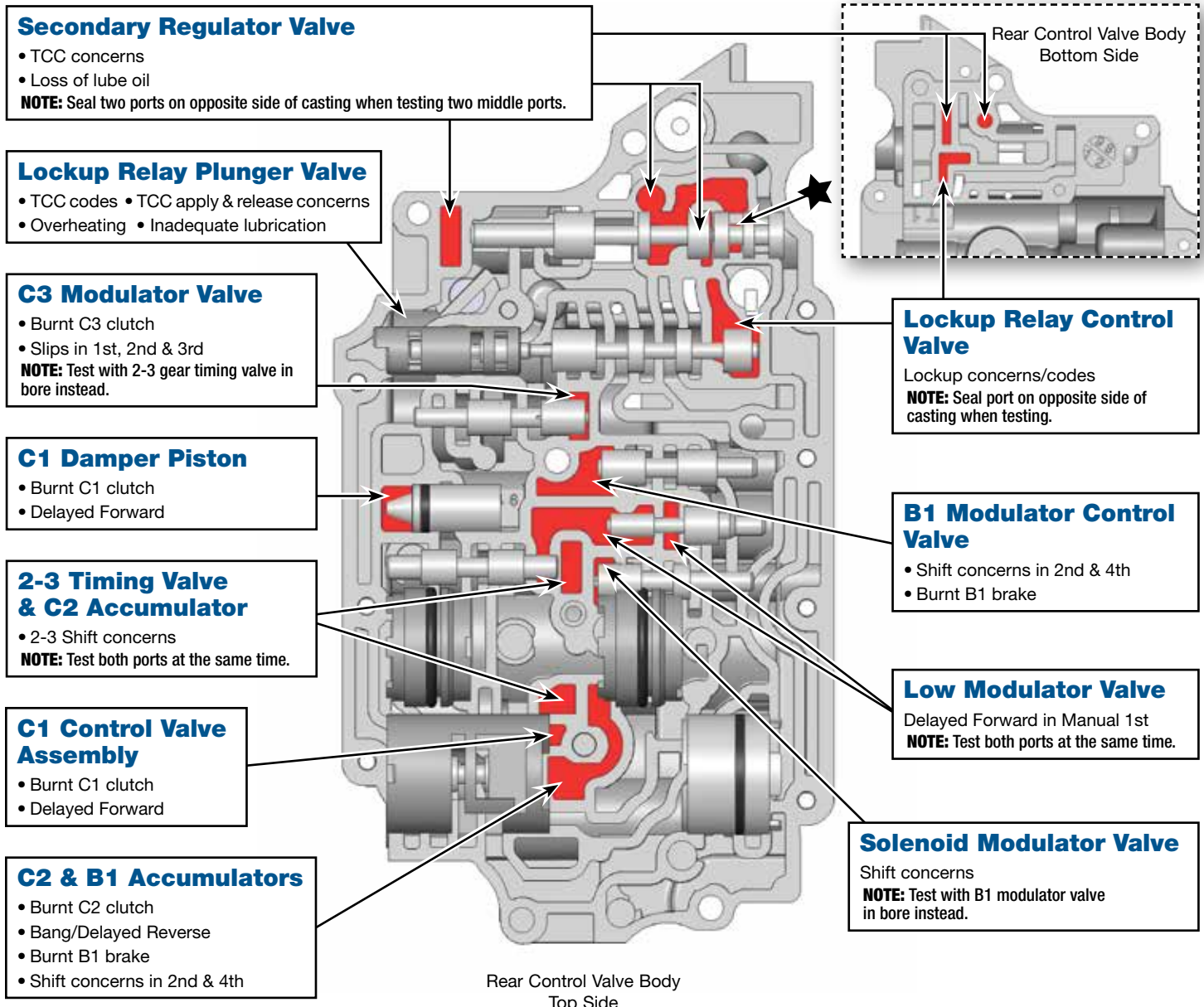

## No. 2 Rear Control Valve Body

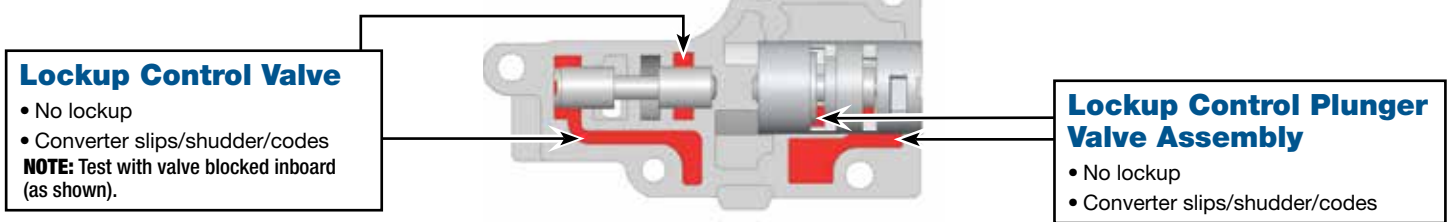

# OE Exploded View

Front & Middle Control Valve Bodies Shown Here

### Front Control Valve Body Descriptions

I.D. No.	Description
101	Solenoid B1 Modulator Valve No. 2
102	Neutral Relay Valve

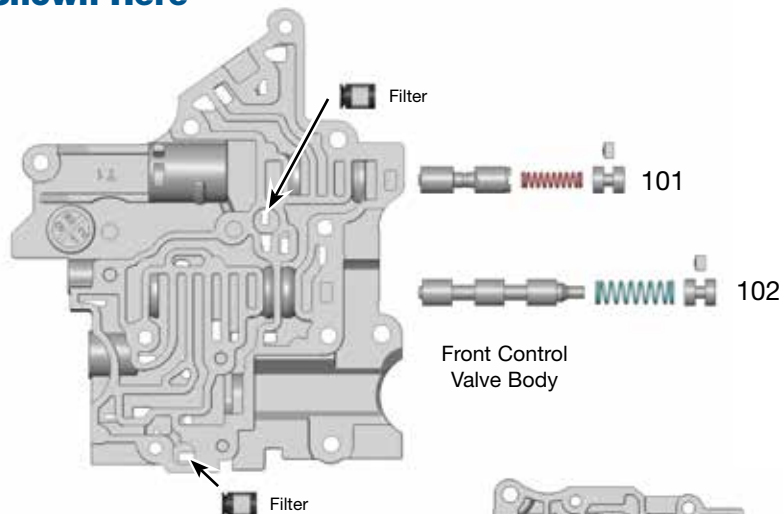

### Middle Control Valve Body Descriptions

I.D. No.	Description
201	Pressure Relief Valve
202	Lockup Control Solenoid Valve
203	3-4 Shift Valve
204	2-3 Shift Valve
205	1-2 Shift Valve
206	Solenoid B1 Modulator Valve No.1
207	Accumulator Regulator Valve and Plunger Valve Assembly
208	Primary Regulator Valve & Reverse Boost Assembly
209	Pressure Relief Valve

Middle Control Valve Body (Bottom Side)

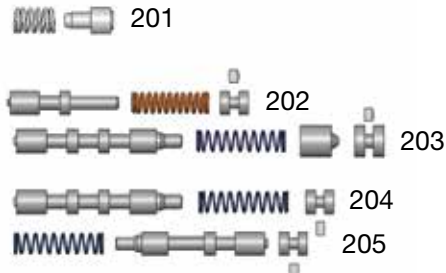
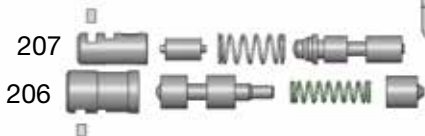
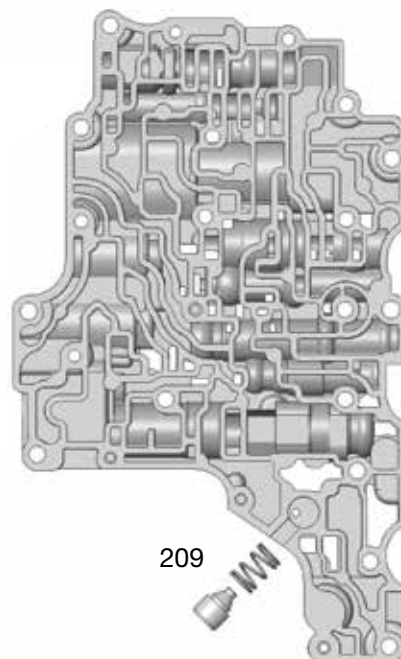

Middle Control Valve Body (Front Side)

# OE Exploded View

Rear & No. 2 Rear Control Valve Bodies Shown Here

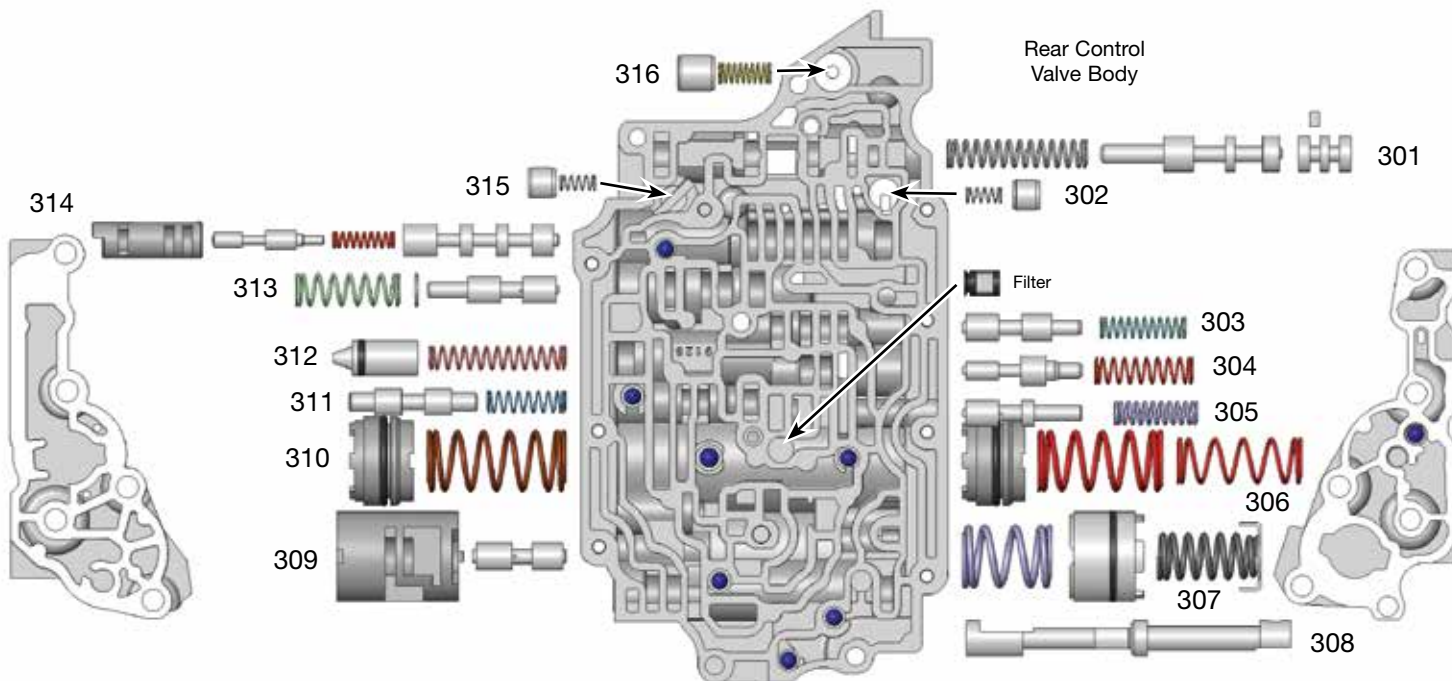

Rear Control Valve Body Descriptions	
I.D No.	Description
301	Secondary Regulator Valve
302	Check Valve
303	B1 Modulator Control Valve
304	Low Modulator Valve
305	Solenoid Modulator Valve
306	C2 Accumulator
307	B1 Accumulator
308	Manual Valve
309	C1 Control Valve Assembly
310	C0 Accumulator
311	2-3 Timing Valve
312	C1 Damper Piston
313	C3 Modulator Valve
314	Lockup Relay Control Valve & Plunger Assembly
315	Check Valve
316	Check Valve



No. 2 Rear Control Valve Body Descriptions	
I.D. No.	Description
401	TCC Control Valve & Plunger Valve Assembly