

Critical Wear Areas & Vacuum Test Locations



NOTE: OE valves are shown in rest position and should be tested in rest position unless otherwise indicated. Test locations are pointed to with an arrow. Springs are not shown for visual clarity. Low vacuum reading indicates wear and Sonnax parts are noted for replacement.

Valve Body • 4L60-E Shown

*NOTE: Valve designs vary by year, however all port locations for vacuum testing are the same.



For specific vacuum test information, refer to individual part instructions included in kits and available at www.sonnax.com.

Click on Sonnax part numbers to see more information.

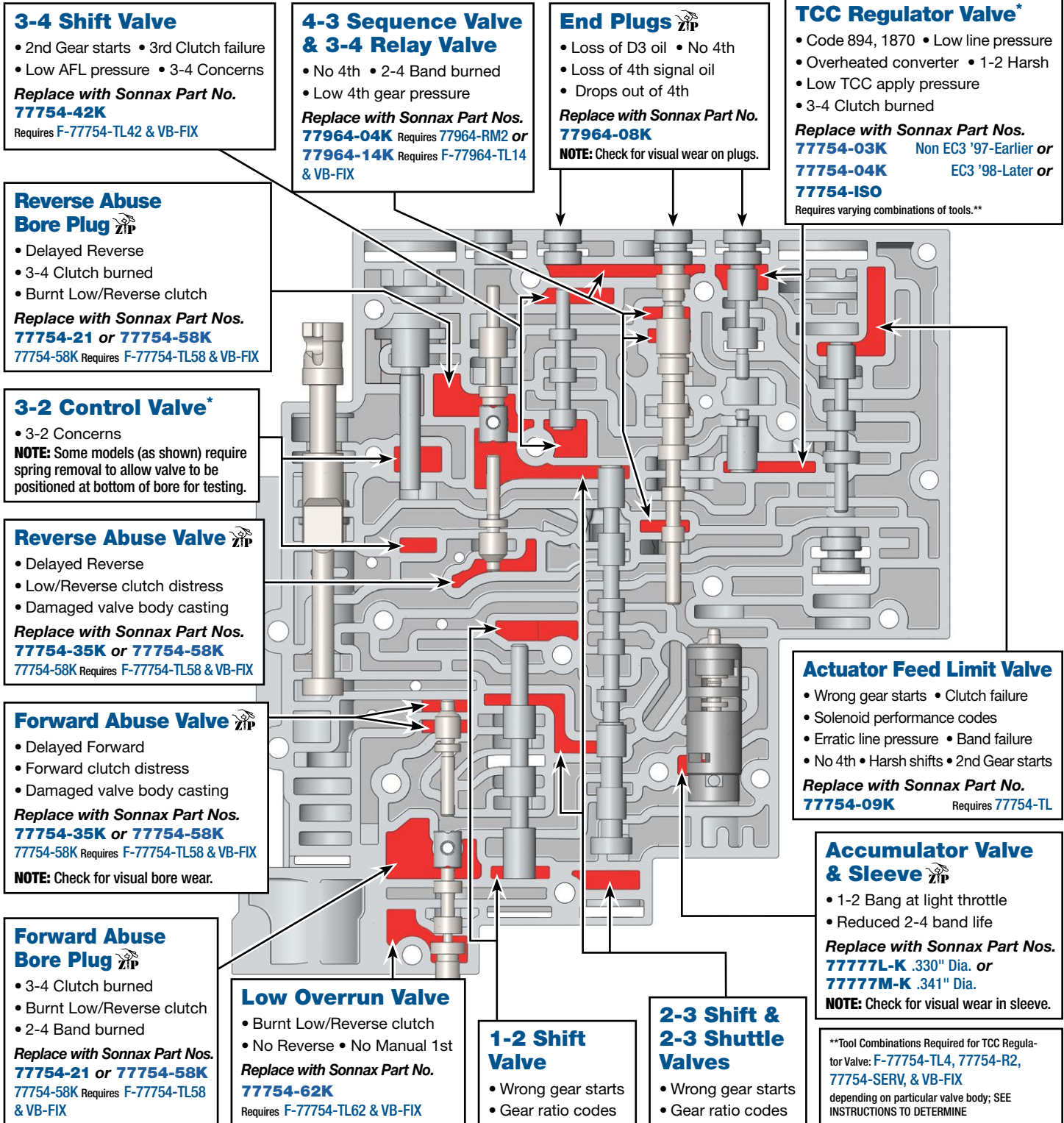

**Tool Combinations Required for TCC Regulator Valve: F-77754-TL4, 77754-R2, 77754-SERV, & VB-FIX depending on particular valve body; SEE INSTRUCTIONS TO DETERMINE

Critical Wear Areas & Vacuum Test Locations



NOTE: OE valves are shown in rest position and should be tested in rest position unless otherwise indicated. Test locations are pointed to with an arrow. Springs are not shown for visual clarity. Low vacuum reading indicates wear and Sonnax parts are noted for replacement.



For specific vacuum test information, refer to individual part instructions included in kits and available at www.sonnax.com.

Click on Sonnax part numbers to see more information.

Pump Cover (Front) 4L60-E PWM Shown

NOTE: Worm tracks will vary slightly on non-PWM pump covers, but locations for vacuum testing are identical.

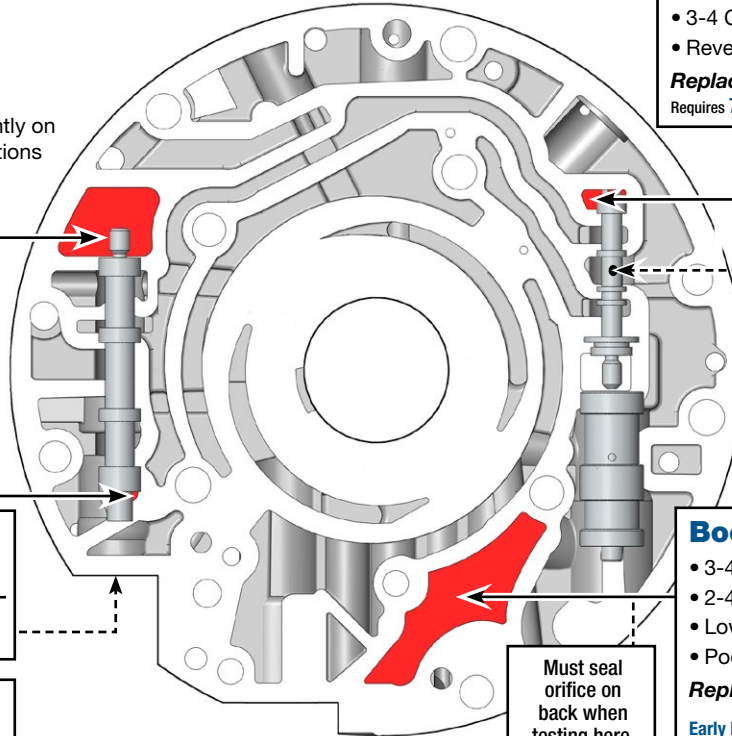

Test this location with valve stroked outboard, as shown.
Must seal orifice on back when testing here.

Test this port with valve blocked inboard.
Seal bore opening with thumb.

Seal valve orifice with pencil eraser.

Must seal orifice on back when testing here.

Pressure Regulator Valve

- Erratic line pressure
- Low line rise
- 3-4 Clutch failure
- Excess pump noise
- Reverse chatter

Replace with Sonnax Part No. 77917-07
Requires 77917-TL or 77917-TLC

TCC Apply Valve ZIP

- No lockup
- Falls out of lockup when hot
- Fluid blown out fill tube
- Code 1870
- Lockup immediately after 2nd gear

Replace with Sonnax Part Nos.
77805-K Non-PWM or
77805E-K PWM

Boost Valve Assembly ZIP

- 3-4 Clutch failure
- 2-4 Band failure
- Low line rise
- Poor shift quality

Replace with Sonnax Part Nos.

Early Pump Design w/ 1.907" Long Sleeve:
77898E-K Increased Ratio, O-Rings *or*
77898E-4K Large OE Ratio, O-Rings *or*
77898E-3K Increased Ratio, Factory Style *or*
77898E-6K Large OE Ratio, Factory Style *or*

Late Pump Design w/ 1.890" Long Sleeve:
77898E-14K Standard OE Ratio, O-Rings *or*
77898E-16K Large OE Ratio, O-Rings

Pump Cover (Back) 4L60-E PWM Shown

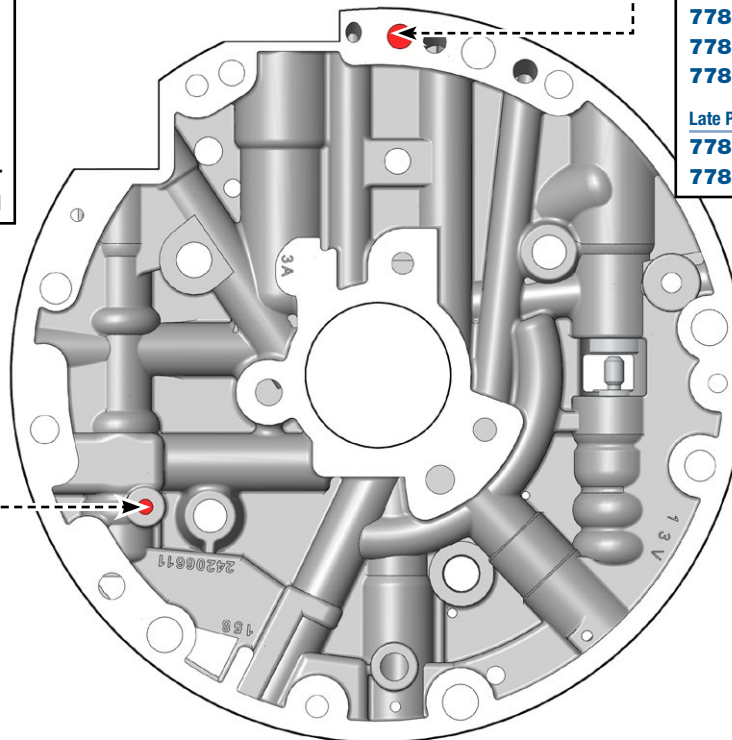

OE Exploded View

NOTE: Solenoids not shown.

Valve Body • 4L60-E Shown

Valve Body Descriptions	
I.D. No.	Description
201	Manual Valve
202	3-2 Control Valve
203	Reverse Abuse Valve (Inboard), 3-2 Downshift Valve (Outboard)
204	3-4 Shift Valve
205	4-3 Sequence Valve (Inboard), 3-4 Relay Valve (Outboard)
206	TCC Regulator Valve
207	Actuator Feed Limit Valve
208	Accumulator Valve & Sleeve
209	2-3 Shift Valve (Inboard), 2-3 Shuttle Valve (Outboard)
210	1-2 Shift Valve
211	Forward Abuse Valve (Inboard), Low Overrun Valve (Outboard)
212	Forward Accumulator Piston

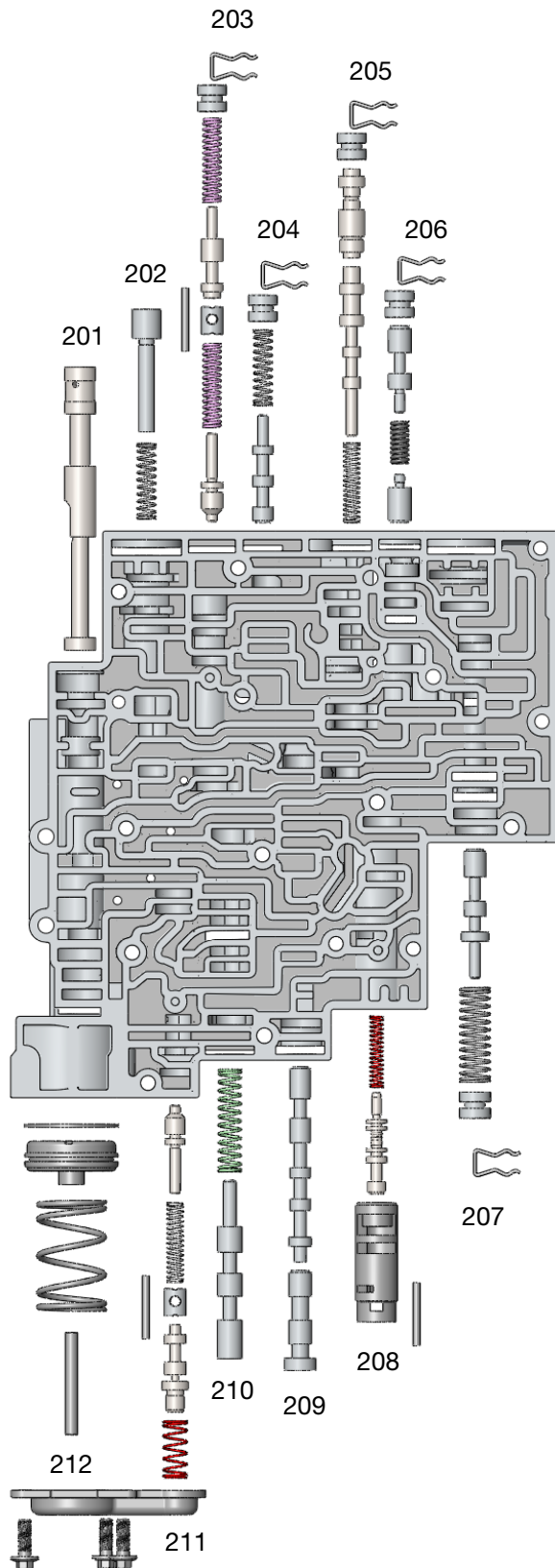

OE Exploded View

NOTE: Worm tracks will vary on non-PWM pump covers.

Pump Cover • 4L60-E PWM Shown

PWM Pump Cover Descriptions

I.D. No.	Description
101	Pressure Regulator Valve & Boost Valve Assembly
102	TCC Apply Valve
103	Pressure Relief Ball & Spring

