

Critical Wear Areas & Vacuum Test Locations

ZIP Drop-In Zip Valve™ Parts Available

U140E-U241E-ZIP Zip Kit® Available

NOTE: OE valves are shown in rest position and should be tested in rest position unless otherwise indicated. Test locations are pointed to with an arrow. Springs are not shown for visual clarity. Low vacuum reading indicates wear and Sonnax parts are noted for replacement.

Upper Valve Body – Bottom Side U241E Shown



For specific vacuum test information, refer to individual part instructions included in kits and available at www.sonnax.com.

Click on Sonnax part numbers to see more information.

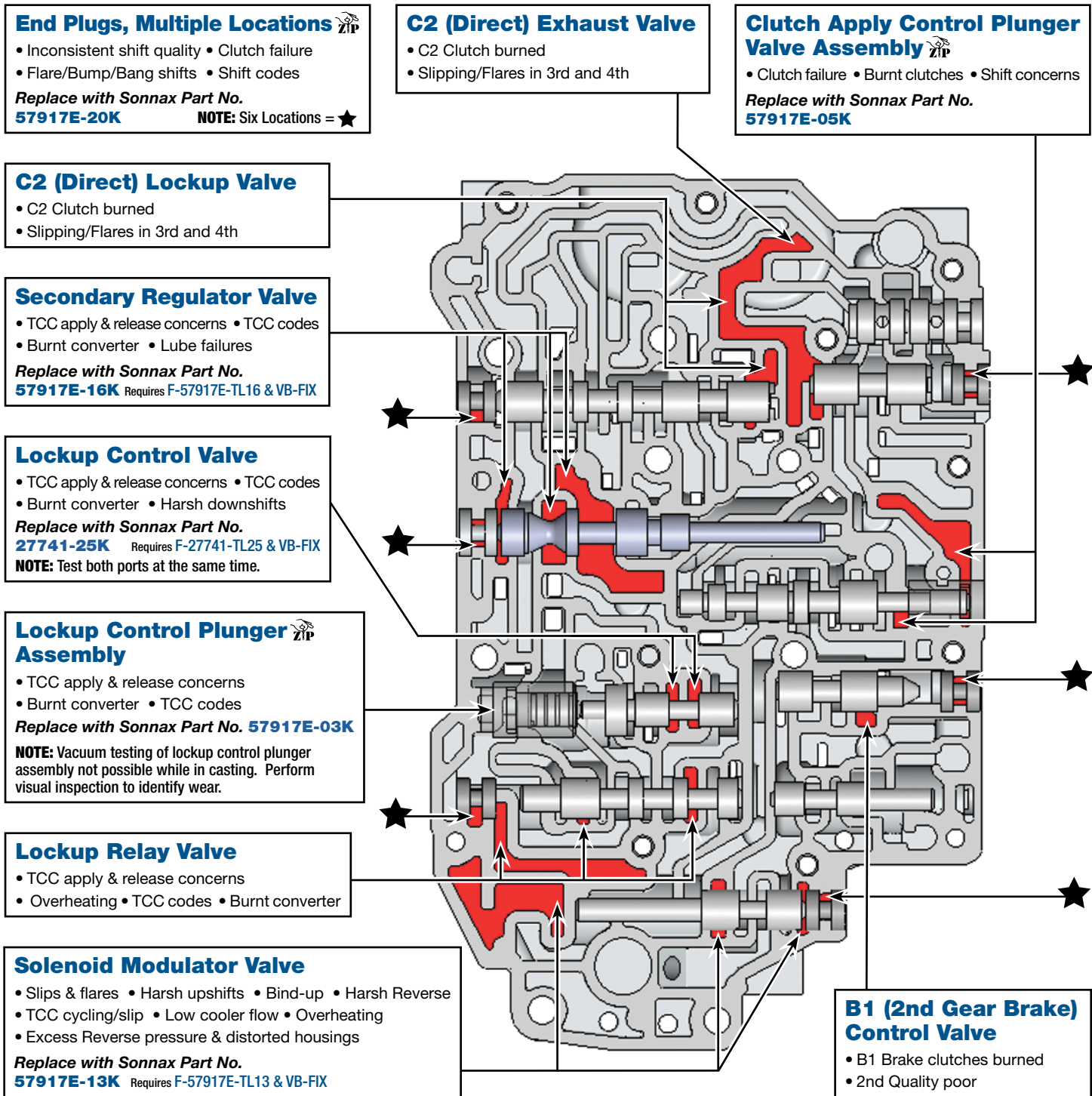

Part numbers with an asterisk () are included in this Zip Kit. Other part numbers are available separately.

Critical Wear Areas & Vacuum Test Locations



Drop-In Zip Valve™
Parts Available



U140E-U241E-ZIP
Zip Kit® Available

NOTE: OE valves are shown in rest position and should be tested in rest position unless otherwise indicated. Test locations are pointed to with an arrow. Springs are not shown for visual clarity. Low vacuum reading indicates wear and Sonnax parts are noted for replacement.

Upper Valve Body – Top Side U241E Shown



For specific vacuum test information, refer to individual part instructions included in kits and available at www.sonnax.com.

Click on Sonnax part numbers to see more information.

C2 (Direct) Accumulator Piston

- Delayed engagement • Flare shifts
- Forward slip • Burnt clutches

Replace with Sonnax Part No.
57917E-19K

B1 (2nd Gear) Accumulator Piston

- Delayed engagement • Flare shifts
- Forward slip • Burnt clutches

Replace with Sonnax Part No.
57917E-19K

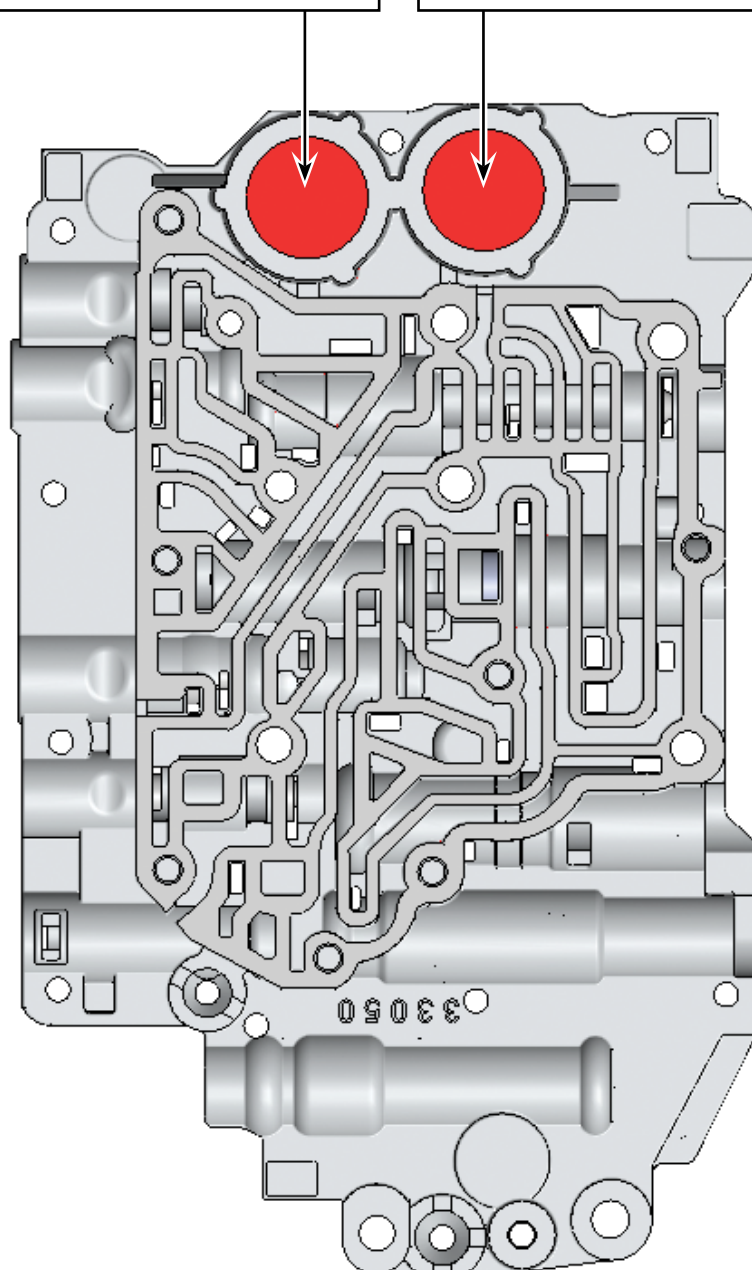

Critical Wear Areas & Vacuum Test Locations

ZIP Drop-In Zip Valve™ Parts Available

ZIP KIT U140E-U241E-ZIP Zip Kit® Available

NOTE: OE valves are shown in rest position and should be tested in rest position unless otherwise indicated. Test locations are pointed to with an arrow. Springs are not shown for visual clarity. Low vacuum reading indicates wear and Sonnax parts are noted for replacement.

Lower Valve Body – Bottom Side U241E Shown



For specific vacuum test information, refer to individual part instructions included in kits and available at www.sonnax.com.

Click on Sonnax part numbers to see more information.

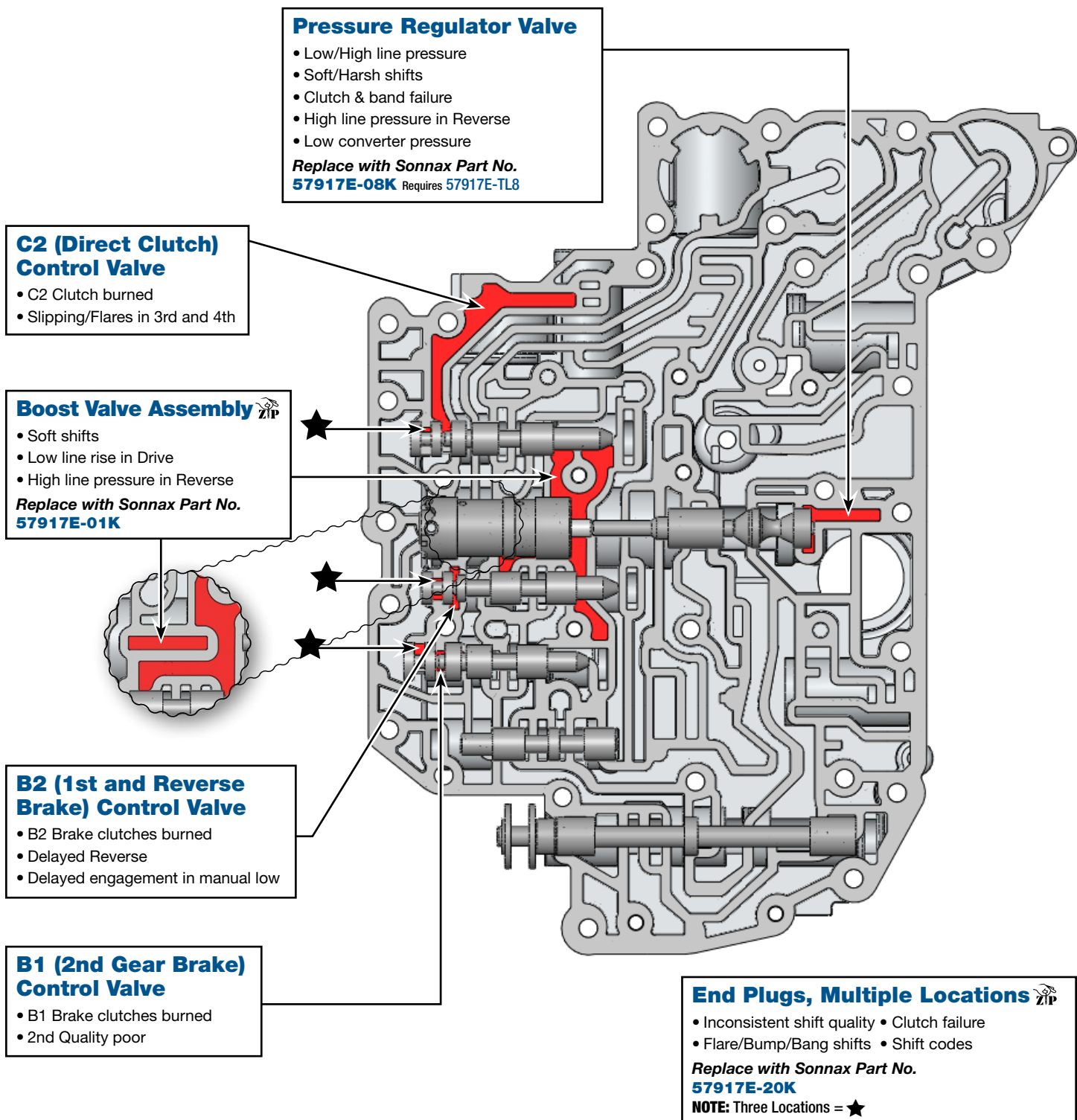

OE Exploded View

Upper & Lower Valve Body • U241E Shown

Upper Valve Body Descriptions

I.D. No.	Description
101	C2 Lockup Valve
102	Secondary Regulator Valve
103	Lockup Control Valve
104	Lockup Relay Valve
105	Solenoid Modulator Valve
106	B3 Orifice Control Valve
107	B1 Lockup Valve
108	Clutch Apply Control Valve
109	C2 Exhaust Valve
110	Three-Way Check Valve

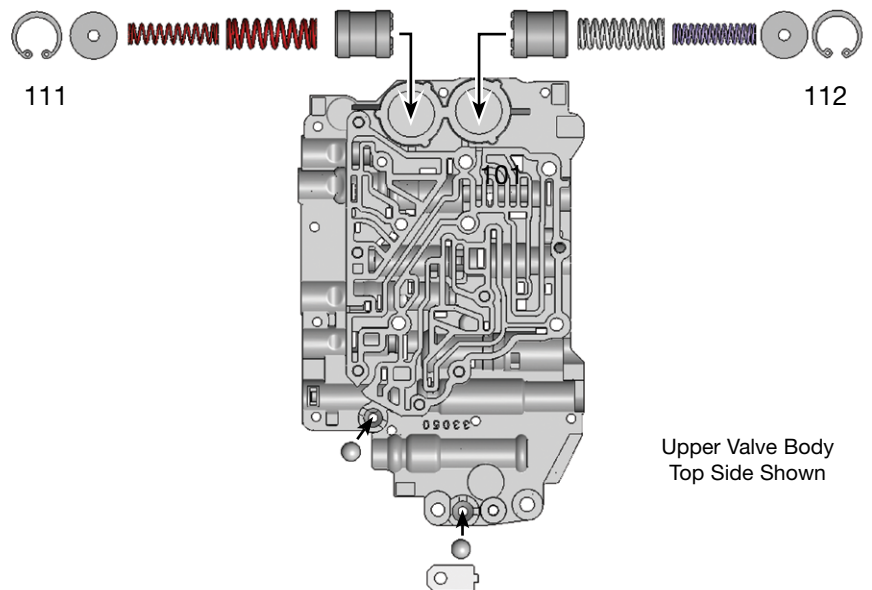
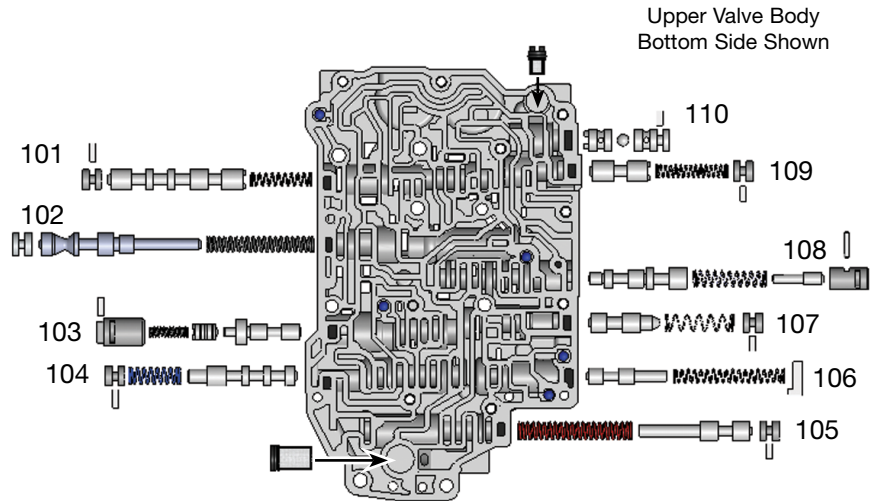

Upper Valve Body Descriptions

I.D. No.	Description
111	C2 Accumulator Piston
112	B1 Accumulator Piston

OE Exploded View

Upper & Lower Valve Body • U241E Shown Here

Lower Valve Body Descriptions

I.D No.	Description
201	C2 Control Valve
202	Main Regulator Valve
203	B2 Control Valve
204	B1 Control Valve
205	3-4 Shift Valve
206	Manual Valve

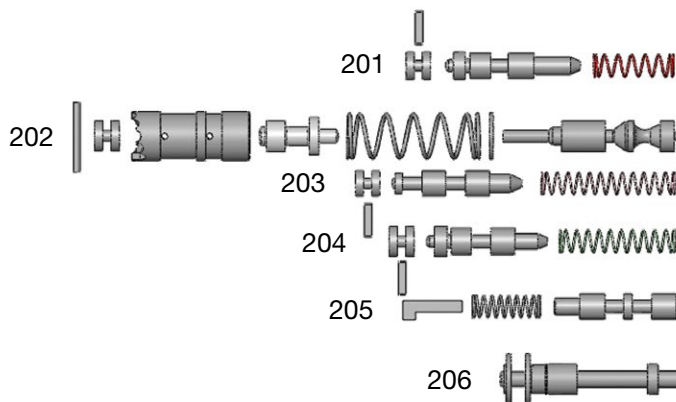

Checkball is not used in all units. Only use in models that have a corresponding hole in the separator plate at this location.

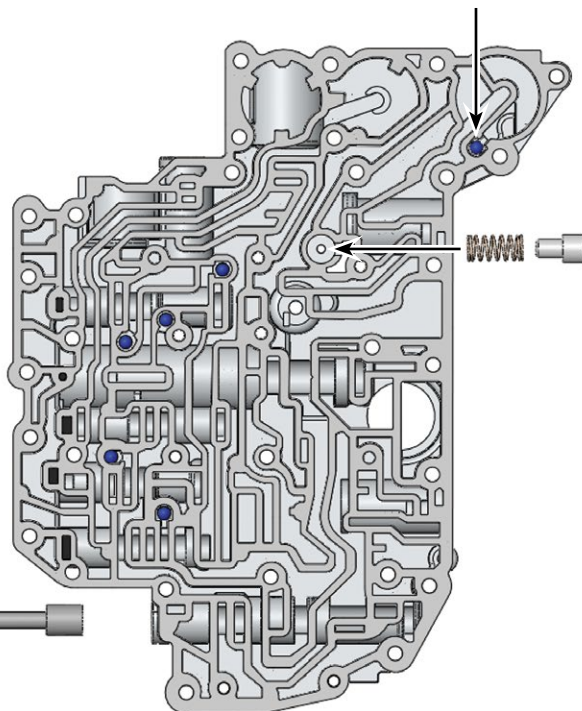

Lower Valve Body Bottom Side Shown

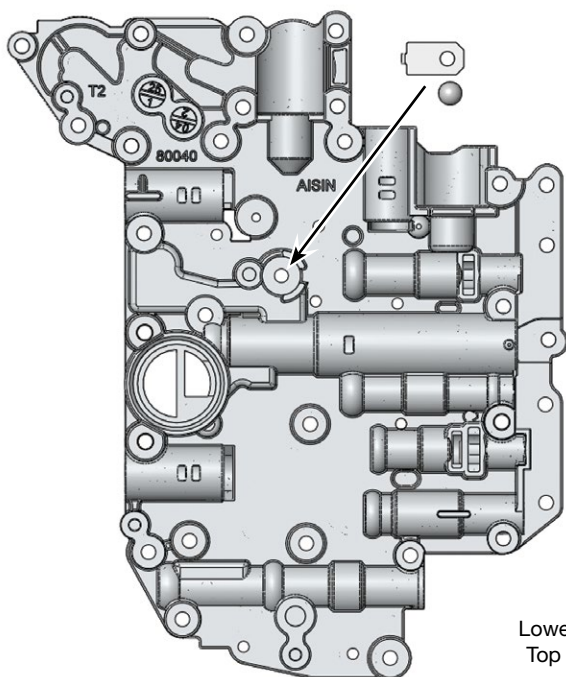

Lower Valve Body Top Side Shown