

Critical Wear Areas & Vacuum Test Locations

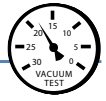

NOTE: OE valves are shown in rest position and should be tested in rest position unless otherwise indicated. Test locations are pointed to with an arrow. Springs are not shown for visual clarity. Low vacuum reading indicates wear.

Click on Sonnax part numbers to see more information.

Plug casting valley with foam, putty or appropriately sized O-ring coated in assembly lube to isolate circuits.

1-2 Shift Valve

- 1-2 Quality poor • Flare shifts
- Soft shifts & poor line rise

Replace with Sonnax Part No. 84754-57K Requires F-84754-TL57

Torque Signal Regulator Valve

- Erratic line pressure • Low line pressure
- Code 1811 • Code P0741, P0742
- Shudder condition • Slipping gears

Replace with Sonnax Part No. 84754-44 '97-Later Requires 84754-TL44

TCC Apply Valve

- No lockup • Code P0741
- Falls out of lockup when hot
- Converter shudder • High TCC slip RPM

Replace with Sonnax Part No. 84754-43K Standard
84754-50K Oversized
84754-50K: Requires F-84754-TL50 & VB-FIX

Boost Valve Assembly

- Erratic line pressure
- Soft upshifts (especially 1-2)
- Low line rise in Forward
- Low line rise in Reverse

Replace with Sonnax Part No. 84754-30K

TCC Regulator Apply Valve

- TCC slip
- Code P0741
- Cycling TCC RPM

Replace with Sonnax Part No. 84754-34K Requires 84754-TL3

Pressure Regulator Valve

- Erratic line pressure • Overheating
- Burnt clutches • Poor shift quality
- TCC apply & release concerns
- Low convert & lube flow

Replace with Sonnax Part No. 84754-46K Requires 84754-TL46

3-4 Accumulator Valve

- 3-4 Concerns
- Soft shifts
- Poor line rise

Replace with Sonnax Part No. 84754-55K GM Only
84754-58K Volvo Only
84754-55K & 84754-58K: Requires F-84754-TL55 & VB-FIX

Forward Servo Boost Valve ('99-Earlier)

- 1-2 Flare • 1-2 Band burned
- Delayed engagement
- Low Reverse pressure

Replace with Sonnax Part No. 84754-40K Requires 84754-TL2

2-3 Accumulator Valve Assembly

- 2-3 Shift concerns
- Burnt clutches

Replace with Sonnax Part No. 84754-53K GM Only

Reverse Servo Boost Valve ('99-Earlier)

- 1-2 Flare • 1-2 Band burned
- Delayed engagement
- Low Reverse pressure

Replace with Sonnax Part No. 84754-40K Requires 84754-TL2

Test these together.

Plug orifices on back when checking these locations.

3-4 Shift Valve & 4-3 Manual Downshift Valve ('91-Late 4T60-E)

- Erratic shifts • 2-3 Shuttle
- No 3rd, 4th • 2nd Gear starts

Replace with Sonnax Part No. 84754-39K 4-3 Manual Downshift Valve

2-3 Shift Valve & 3-2 Manual Downshift Valve ('94-Later 4T60-E)

- Erratic shifts • 2-3 Shuttle • No 3rd, 4th
- Temperature-sensitive shifts • 2nd Gear starts

Replace with Sonnax Part No. 84754-36K 2-3 Shift Valve
84754-37K 3-2 Manual Downshift Valve
These parts do not fit Geartronic® or Tapshift® Units

1-2 Accumulator Valve

- 1-2 Quality poor
- Flare shifts
- Soft shifts & poor line rise

Replace with Sonnax Part No. 84754-57K Requires F-84754-TL57

OE Exploded View



NOTE: OE valves are shown in rest position and should be tested in rest position unless otherwise indicated. Test locations are pointed to with an arrow. Springs are not shown for visual clarity. Low vacuum reading indicates wear.

Channel Plate Casting

Click on Sonnax part numbers to see more information.

■ Plug casting valley with foam, putty or appropriately sized O-ring coated in assembly lube to isolate circuits.

Actuator Feed Limit Valve

- Erratic line pressure
- Maximum adapt
- Code 1811
- 2nd Gear starts
- Poor EPC control
- Long Shifts
- TCC piston failure

Replace with Sonnax Part No. 84596-02K Requires F-84596-TL & VB-FIX

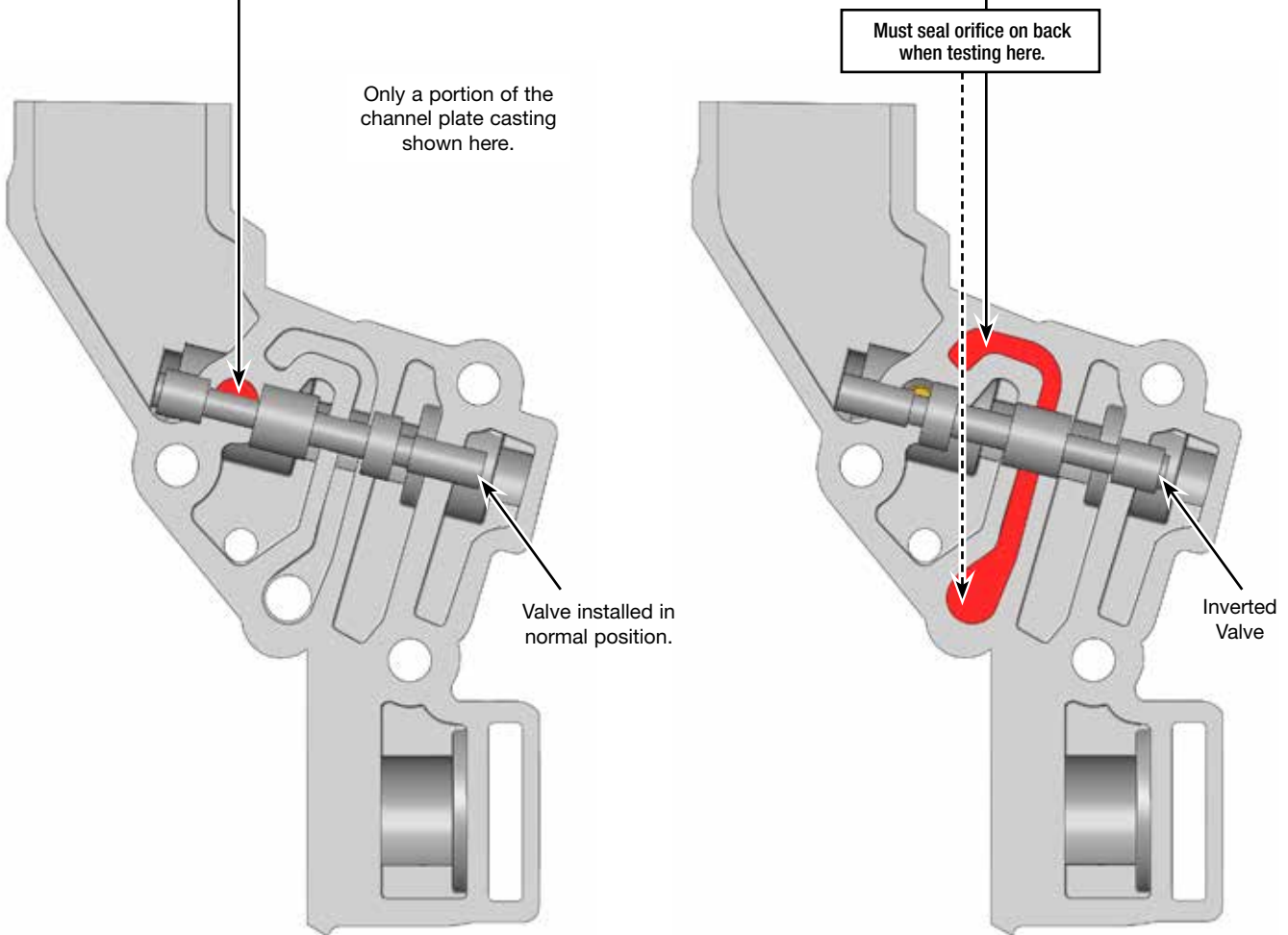

OE Exploded View

NOTE: Solenoids not shown.

Valve Body Descriptions	
I.D. No.	Description
101	Pressure Regulator Valve (inboard) Boost Valve Assembly (outboard)
102	1-2 Shift Valve
103	Torque Signal Regulator Valve
104	Line Pressure Relief Valve
105	TCC Apply Valve
106	TCC Regulator Apply Valve
107	Forward Servo Boost Valve ('99-Earlier)
108	Reverse Servo Boost Valve ('99-Earlier)
109	3-4 Shift Valve (inboard) 4-3 Manual Downshift Valve (outboard)
110	2-3 Shift Valve (inboard) 3-2 Manual Downshift Valve (outboard)
111	1-2 Accumulator Valve
112	3-4 Accumulator Valve (inboard) 2-3 Accumulator Valve Assembly (outboard)
201	Actuator Feed Limit Valve

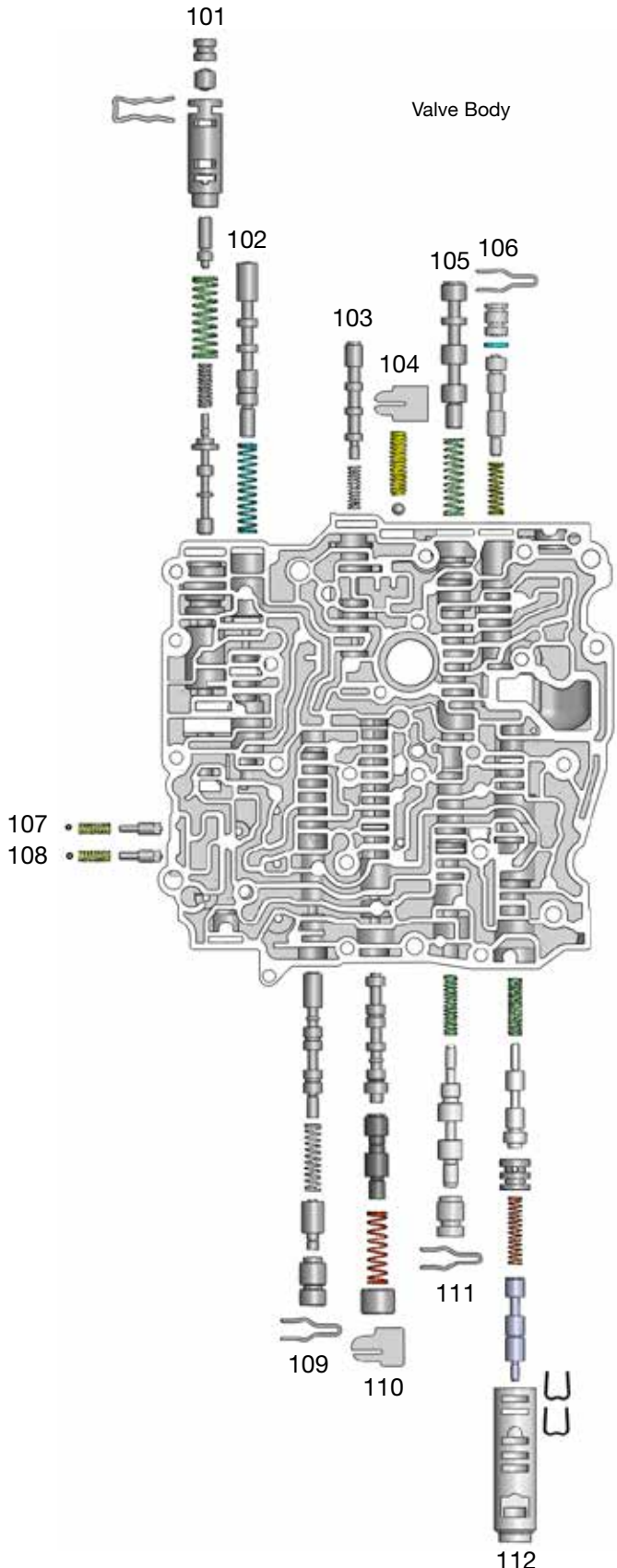

Portion of Channel Casting

