

# Critical Wear Areas & Vacuum Test Locations

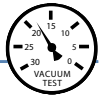

**NOTE:** OE valves are shown in rest position and should be tested in rest position unless otherwise indicated. Test locations are pointed to with an arrow. Springs are not shown for visual clarity. Low vacuum reading indicates wear.

## Valve Body - CFT23 Shown Here

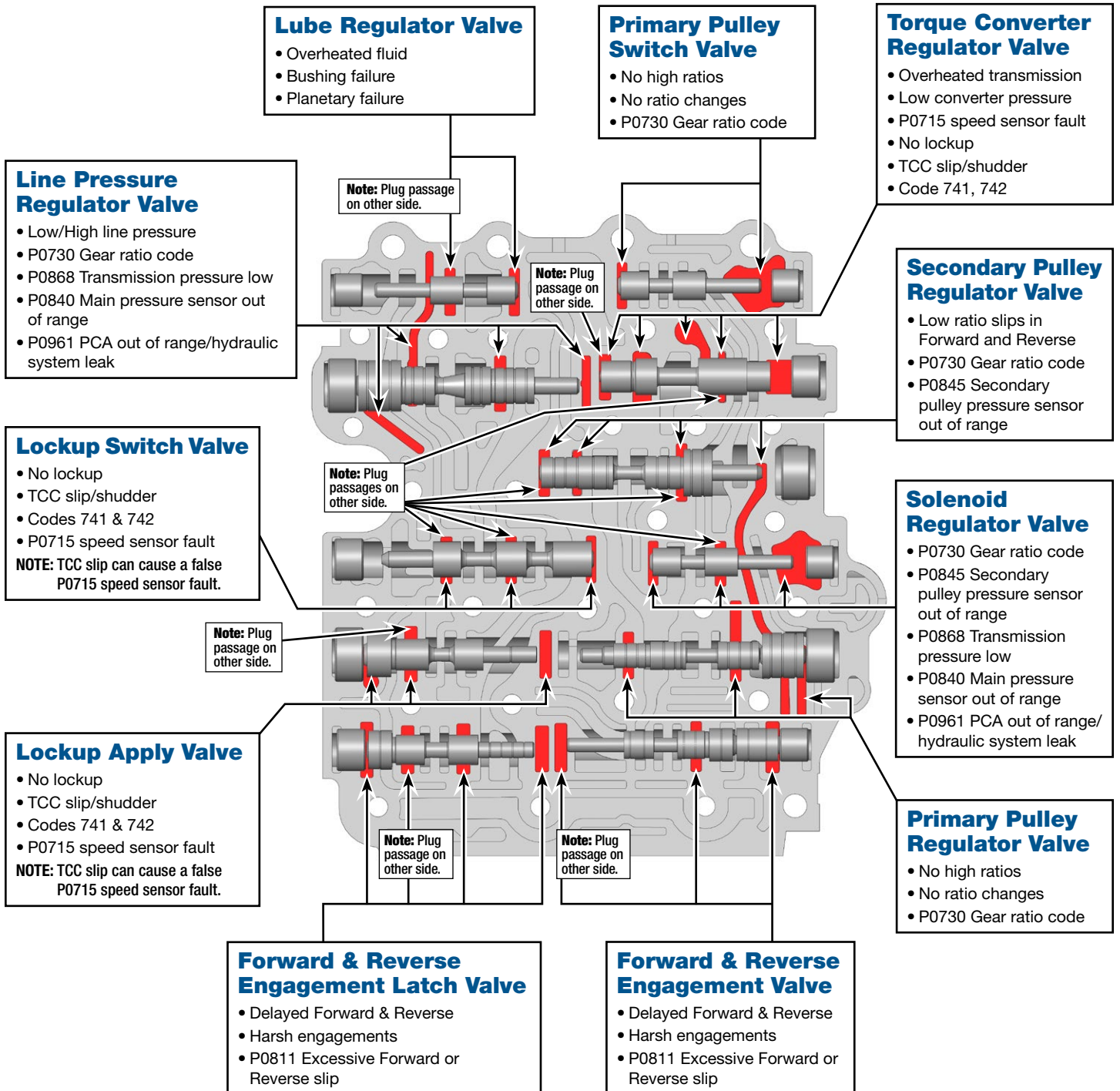

# OE Exploded View

## Valve Body • Left Side

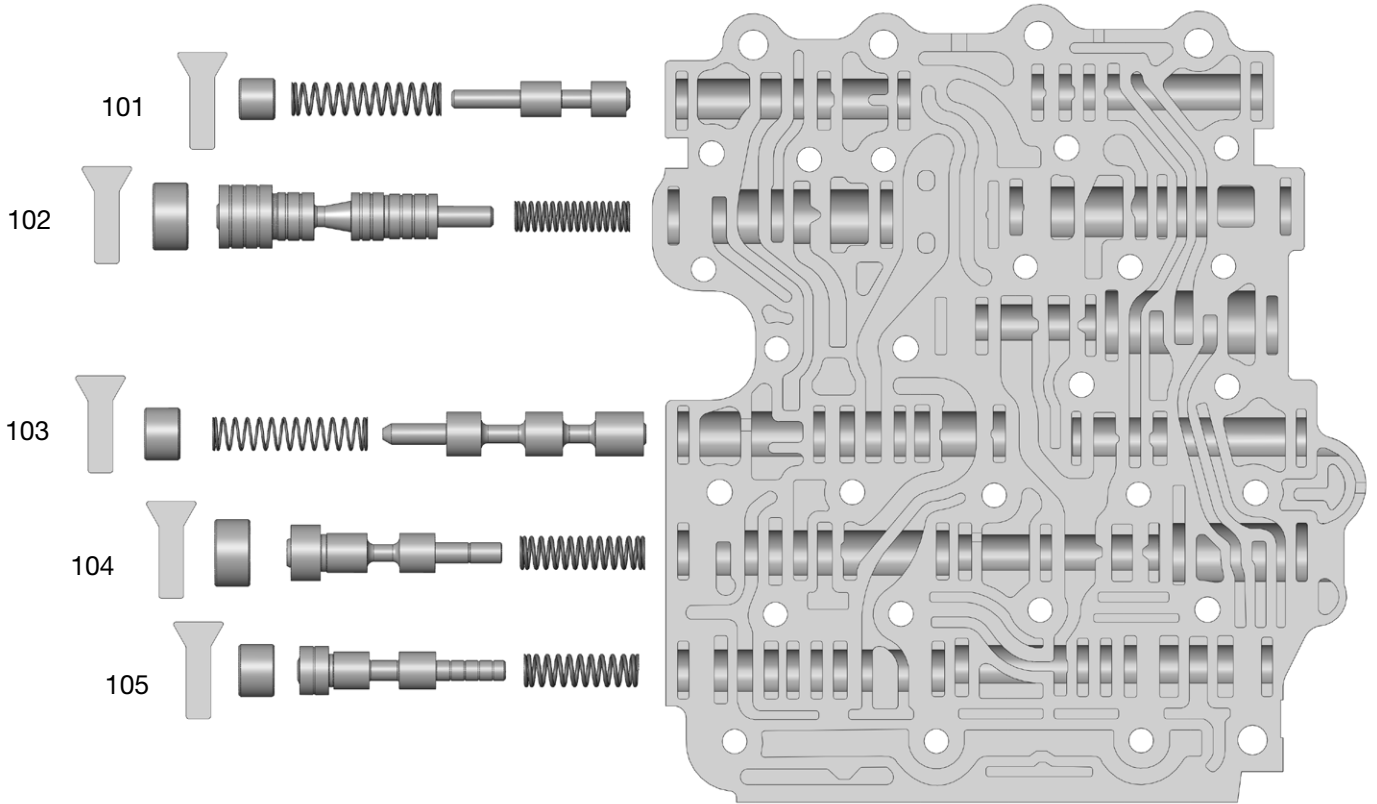

<b>Left Side Valve Body Descriptions</b>	
<b>I.D No.</b>	<b>Description</b>
101	Lube Regulator Valve
102	Line Pressure Regulator Valve
103	Lockup Switch Valve
104	Lockup Apply Valve
105	Forward & Reverse Engagement Latch Valve

# OE Exploded View

## Valve Body • Right Side

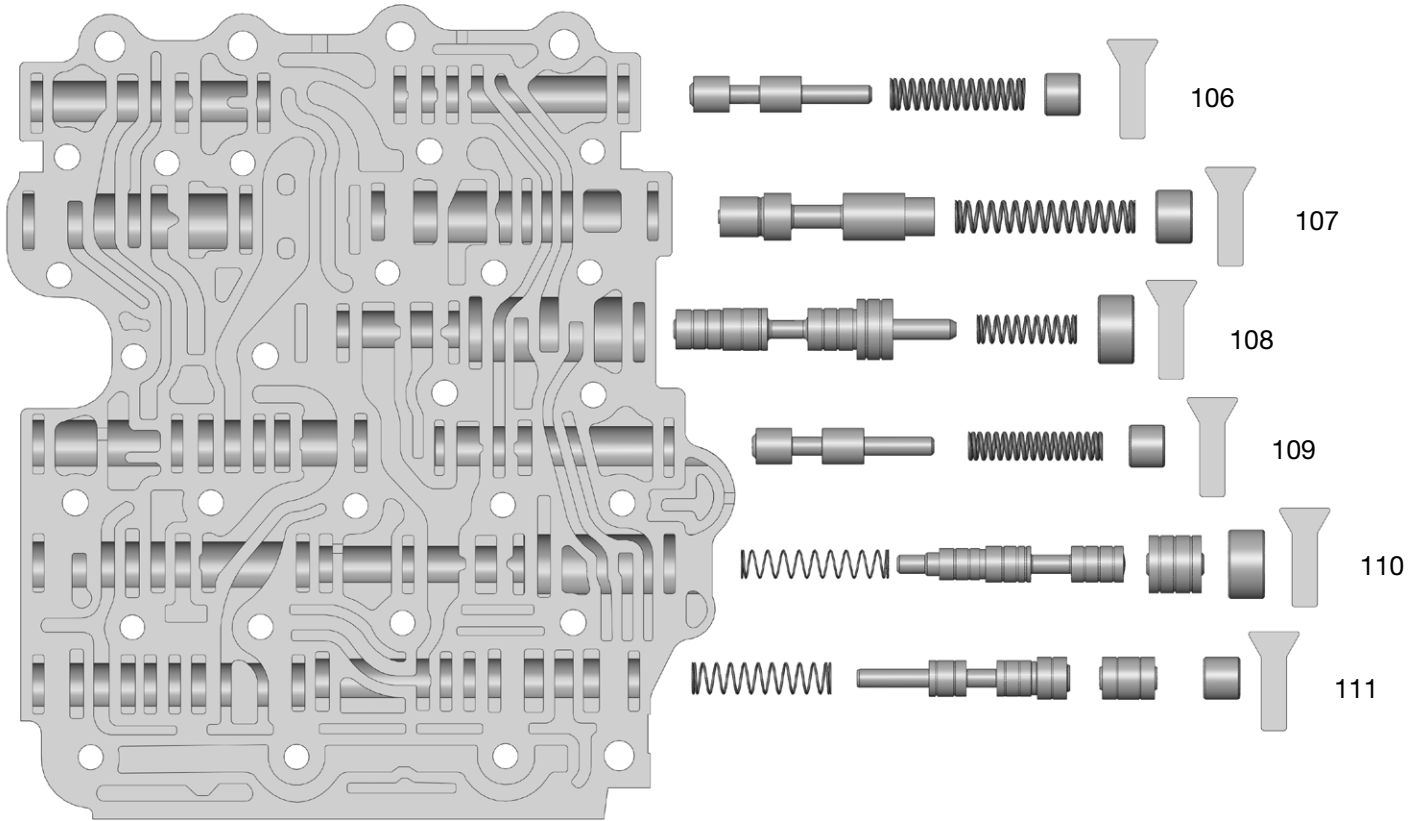

### Right Side Valve Body Descriptions

I.D No.	Description
106	Primary Pulley Switch Valve
107	Torque Converter Regulator Valve
108	Secondary Pulley Regulator Valve
109	Solenoid Regulator Valve
110	Primary Pulley Regulator Valve
111	Forward & Reverse Engagement Valve

# OE Exploded View

## Valve Body • Solenoid Locations & Identification

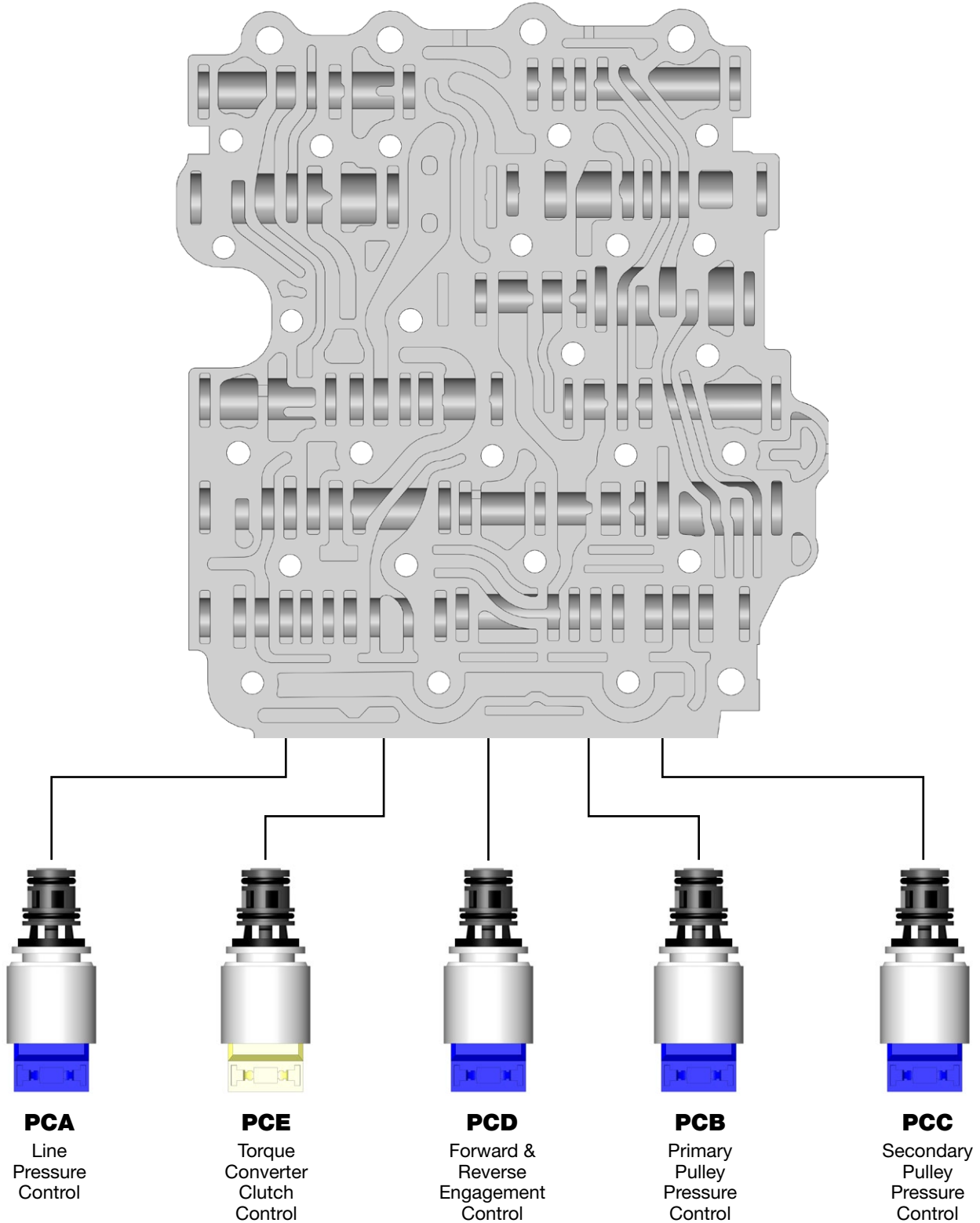

## OE Solenoids

PCA, PCB, PCC & PCD are Normally High PWM Solenoids

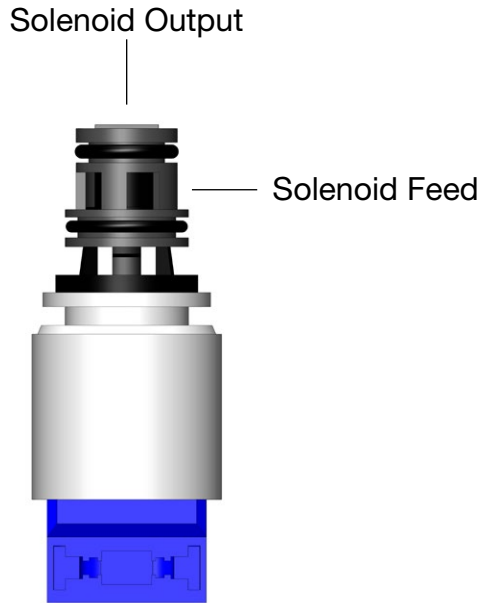

Resistance Value  
is 5–6 Ohms

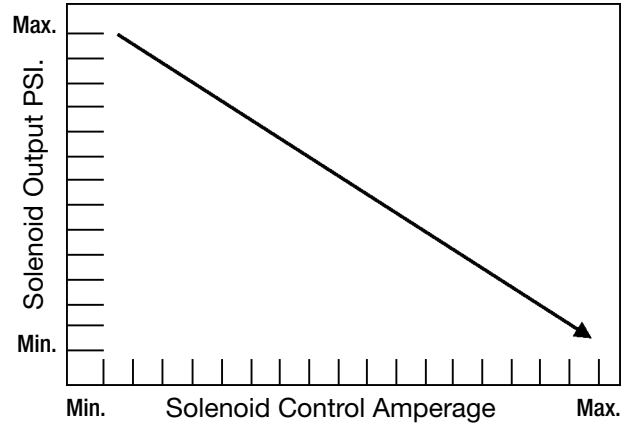

Torque Converter Clutch Solenoid is a Normally Low PWM Solenoid

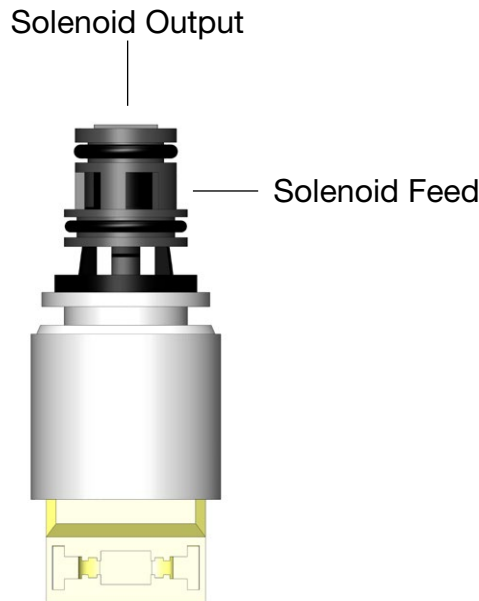

Resistance Value  
is 5–6 Ohms

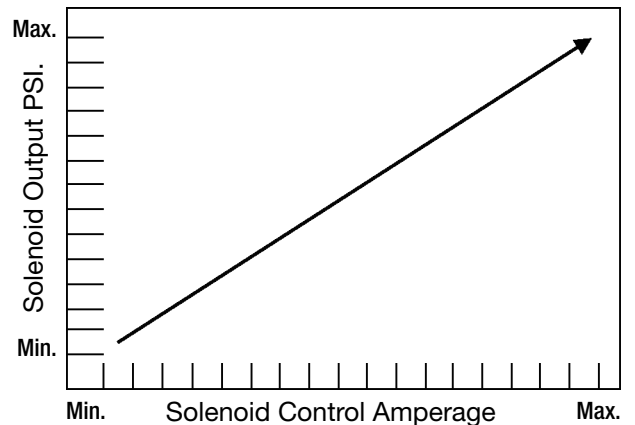

# OE Exploded View

## Channel Plate • Check Valves & Dampers

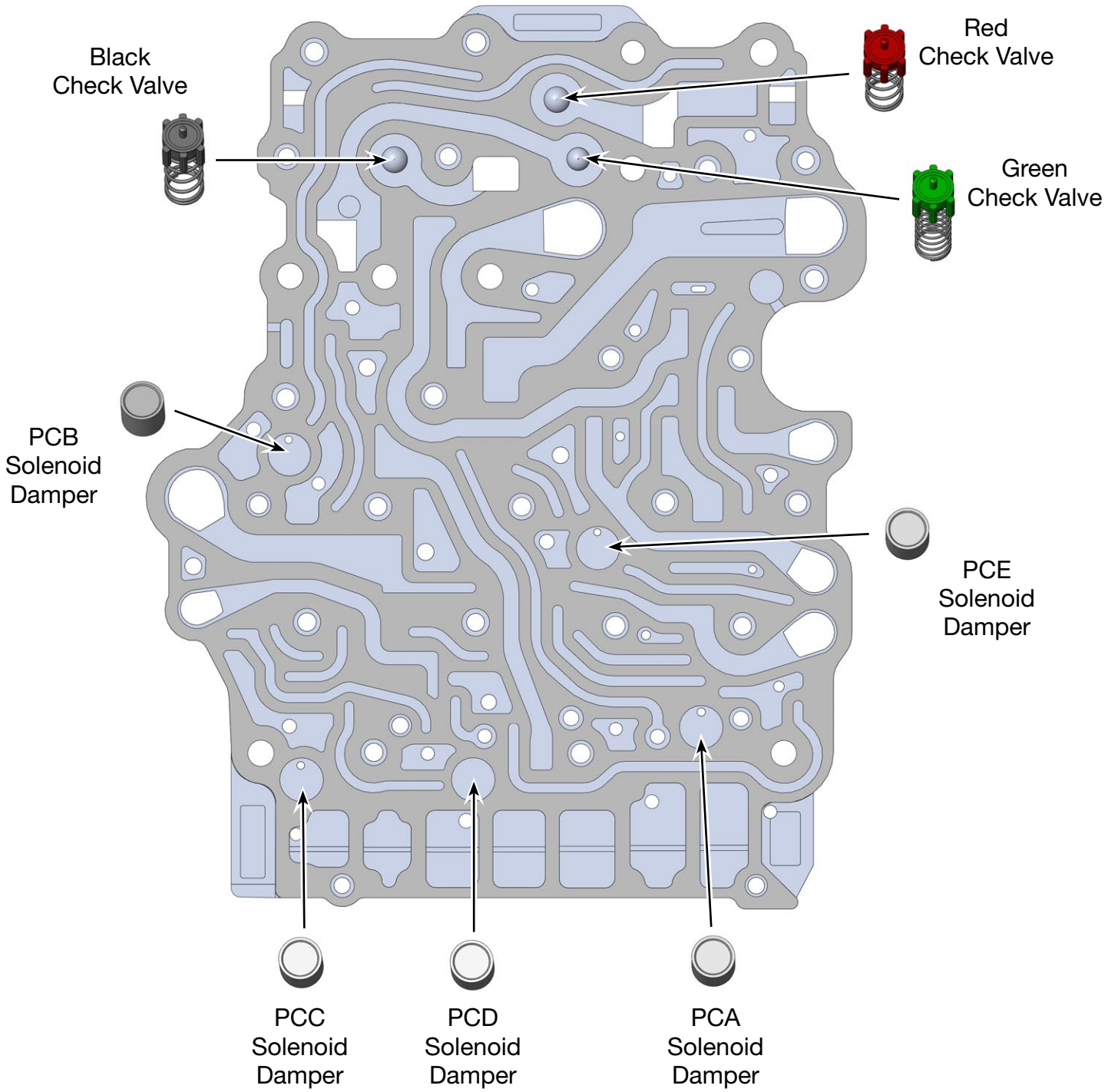

# OE Spring Specifications

## Main Valve Body & Channel Plate

Main Valve Body	CFT23 Spring Specifications						
Valve Name	OD	FL	Wire	Total Coils	Ends*	Color	Wind
Lube Regulator Valve	0.373	1.665	0.033	14.5	C & G	na	Right
Line Pressure Regulator	0.340	1.280	0.034	17.5	C & G	na	Right
Lockup Switch Valve	0.374	1.723	0.027	15	C & G	na	Right
Lockup Apply Valve	0.375	1.386	0.039	14.5	C & G	na	Right
Forward and Reverse Engagement Latch Valve	0.368	1.275	0.043	12.25	C & G	na	Right
Torque Converter Regulator Valve	0.362	1.962	0.038	17	C & G	na	Right
Secondary Pulley Regulator Valve	0.314	1.087	0.031	12	C & G	na	Right
Primary Pulley Switch Valve	0.352	1.470	0.043	15.25	C & G	na	Right
Solenoid Regulator Valve	0.315	1.462	0.043	17.5	C & G	na	Right
Primary Pulley Regulator Valve	0.315	1.610	0.019	12	C & G	na	Right
Forward and Reverse Engagement Valve	0.360	1.518	0.023	12.5	C & G	na	Right

Channel Plate	CFT23 Spring Specifications						
Valve name	OD	FL	Wire	Total Coils	Ends*	Color	Wind
Red Check Valve	0.410	0.955	0.031	7.5	C & G & T	na	Right
Green Check Valve	0.395	0.910	0.023	11.5	C & G & T	na	Right
Black Check Valve	0.424	0.950	0.035	7	C & G & T	na	Right

\*KEY: C = Cut; G = Ground; T = Tapered.