

Critical Wear Areas & Vacuum Test Locations



NOTE: OE valves are shown in rest position and should be tested in rest position unless otherwise indicated. Test locations are pointed to with an arrow. Springs are not shown for visual clarity. Low vacuum reading indicates wear and Sonnax parts are noted for replacement.

Valve Body (Left)



For specific vacuum test information, refer to individual part instructions included in kits and available at www.sonnax.com.

Click on Sonnax part numbers to see more information.

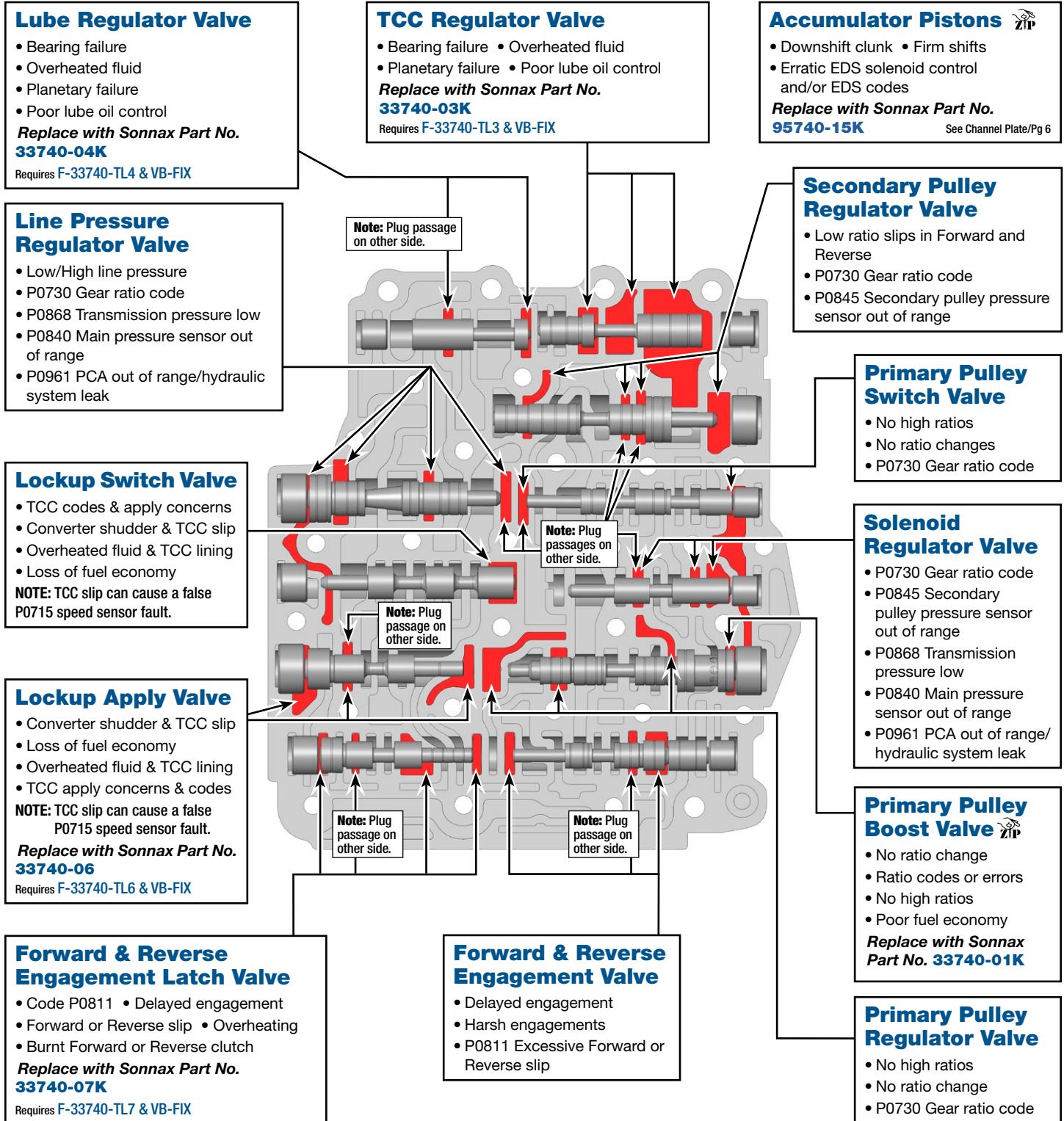

OE Exploded View

Valve Body (Left)

NOTE: Depending upon vehicle application, the OE springs shown may not be present.

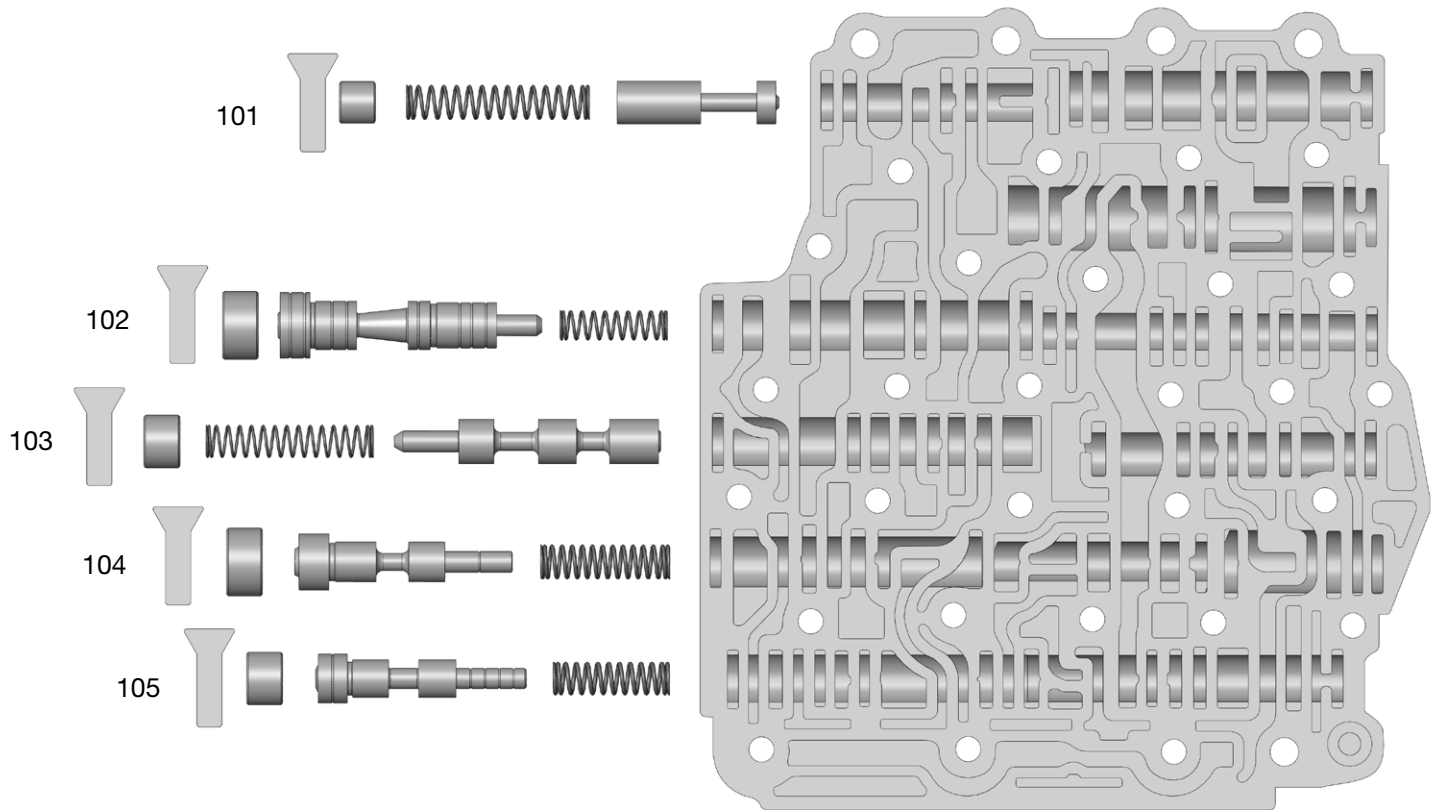

Left Side Valve Body Descriptions	
I.D No.	Description
101	Lube Regulator Valve
102	Line Pressure Regulator Valve
103	Lockup Switch Valve
104	Lockup Apply Valve
105	Forward & Reverse Engagement Latch Valve

OE Exploded View

Valve Body (Right)

NOTE: Depending upon vehicle application, the OE springs shown may not be present.

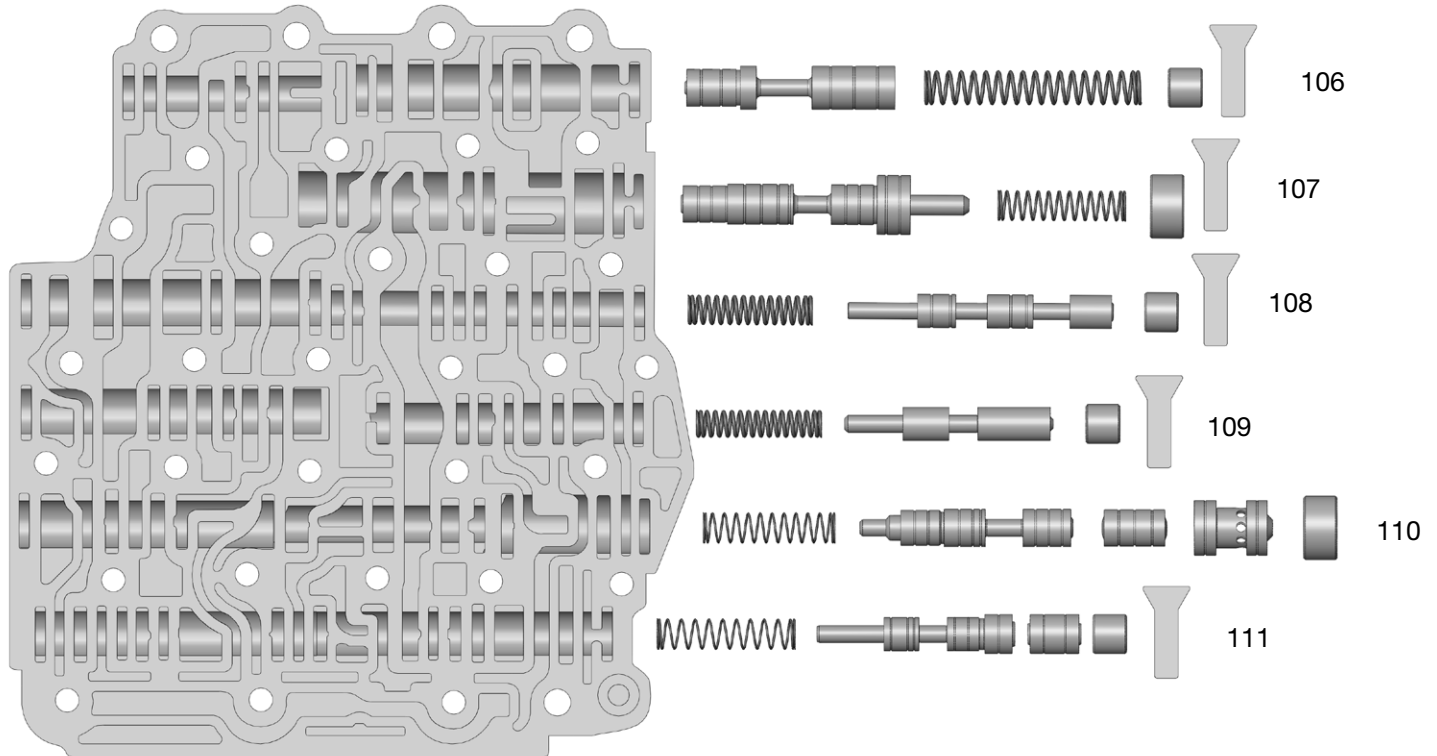

Right Side Valve Body Descriptions

I.D No.	Description
106	TCC Regulator Valve
107	Secondary Pulley Regulator Valve
108	Primary Pulley Switch Valve
109	Solenoid Regulator Valve
110	Primary Pulley Regulator Valve (inboard) Boost Valve Assembly (outboard)
111	Forward & Reverse Engagement Valve

OE Exploded View

Valve Body • Solenoid Locations & Identification

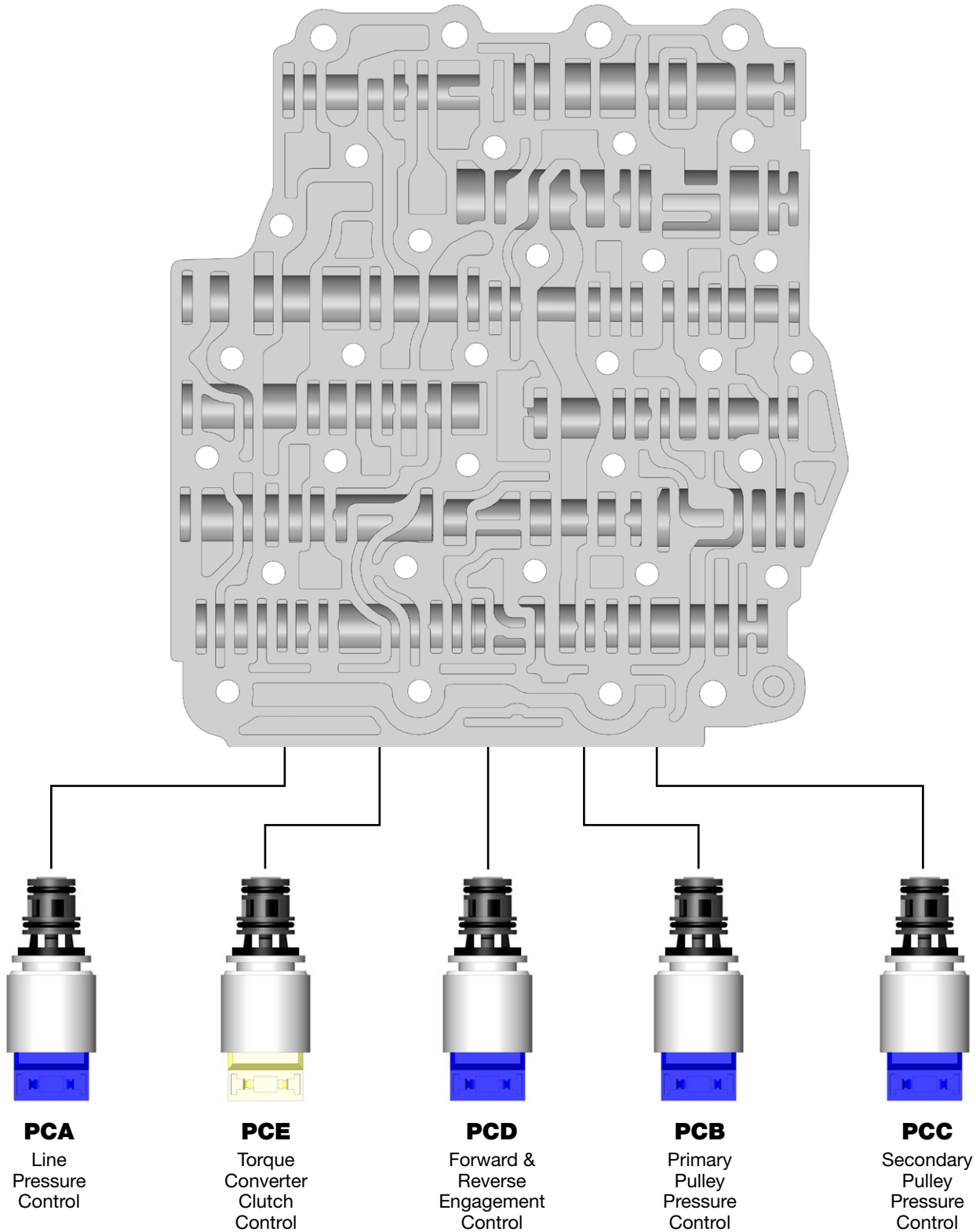

OE Solenoids

PCA, PCB, PCC & PCD are Normally High PWM Solenoids

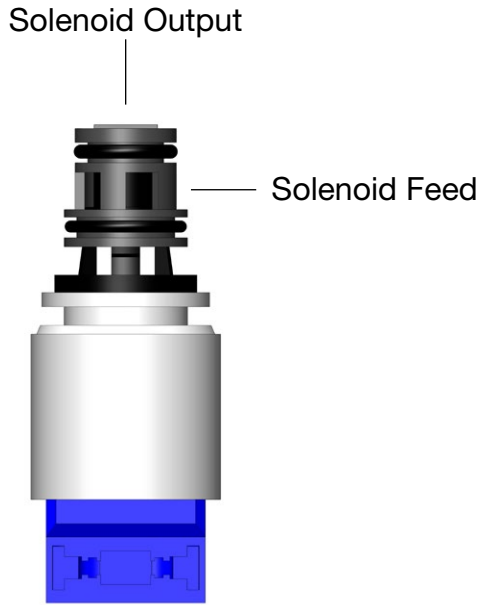

Resistance Value
is 5–6 Ohms

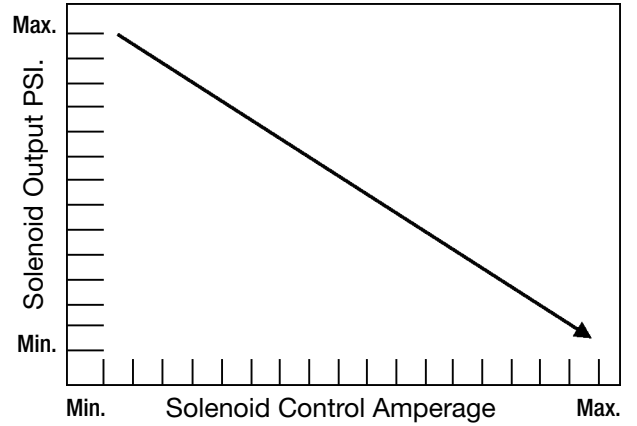

Torque Converter Clutch Solenoid is a Normally Low PWM Solenoid

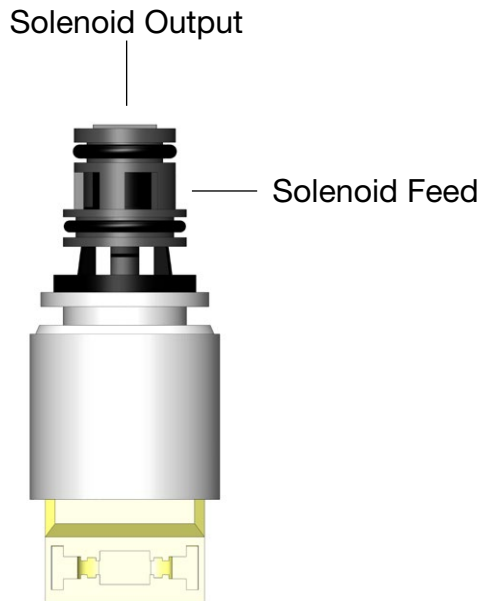

Resistance Value
is 5–6 Ohms

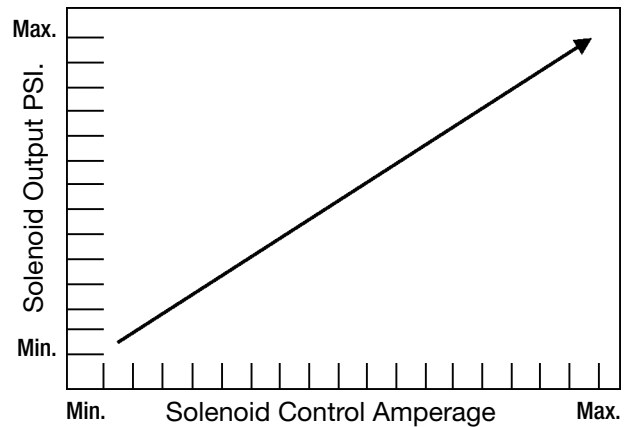

OE Exploded View

Channel Plate • Check Valves & Dampers

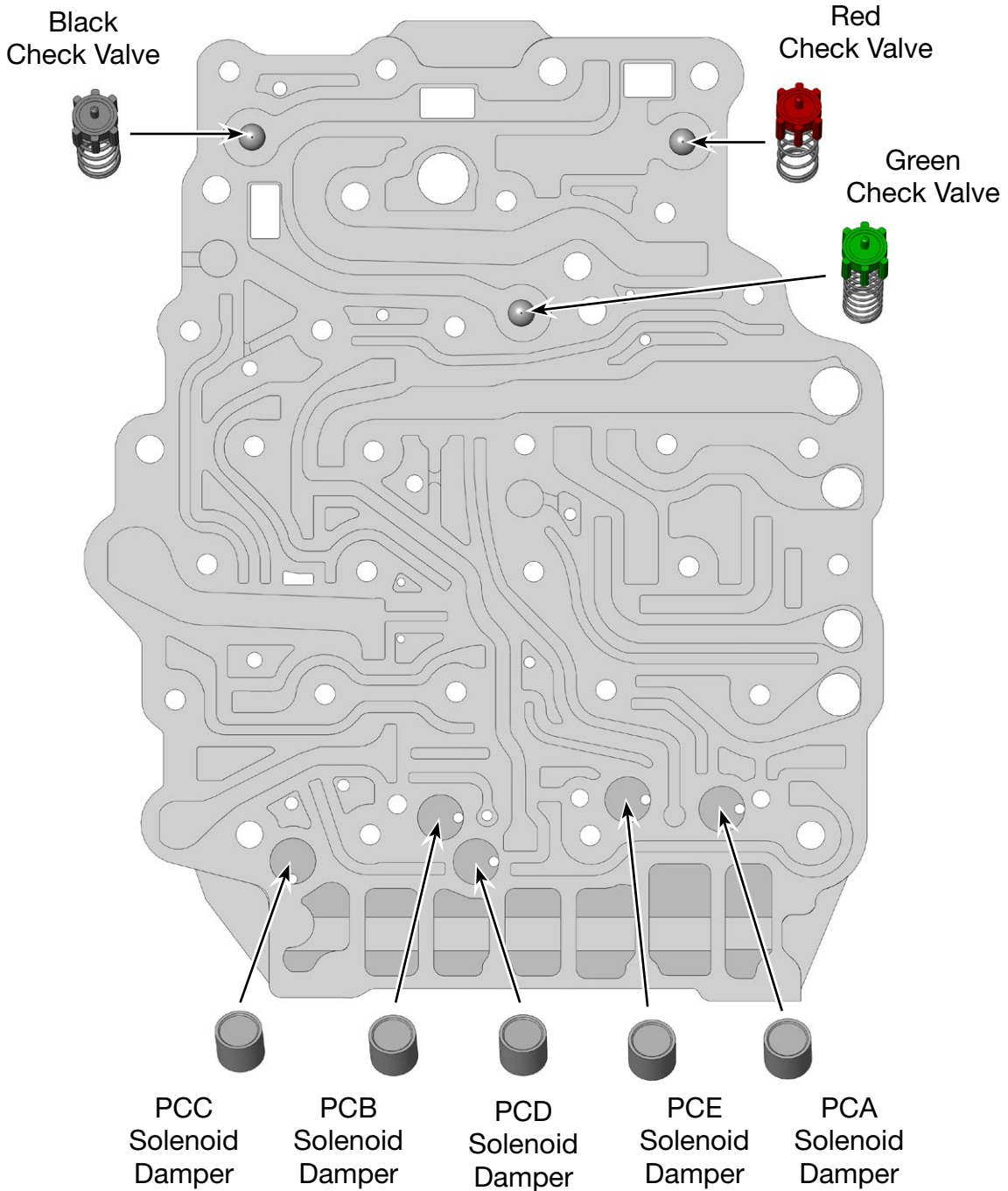

OE Spring Specifications

Main Valve Body & Channel Plate

Main Valve Body	CFT30 Spring Specifications						
Valve Name	OD	FL	Wire	Total Coils	Ends*	Color	Wind
Lube Regulator Valve	0.381	2.015	0.035	16.5	C & G	na	Right
Line Pressure Regulator	0.330	1.180	0.030	11.5	C & G	na	Right
Lockup Switch Valve	0.358	1.838	0.027	16.5	C & G	na	Right
Lockup Apply Valve	0.378	1.422	0.039	14.5	C & G	na	Right
Forward and Reverse Engagement Latch Valve	0.365	1.280	0.043	12.5	C & G	na	Right
Torque Converter Regulator Valve	0.402	2.560	0.039	19.5	C & G	na	Right
Secondary Pulley Regulator Valve	0.358	1.500	0.026	14.5	C & G	na	Right
Primary Pulley Switch Valve	0.350	1.462	0.042	15.5	C & G	na	Right
Solenoid Regulator Valve	0.322	1.470	0.043	16.5	C & G	na	Right
Primary Pulley Regulator Valve	0.358	1.548	0.022	13.5	C & G	na	Right
Forward and Reverse Engagement Valve	0.360	1.620	0.023	12.5	C & G	na	Right

Channel Plate	CFT30 Spring Specifications						
Valve name	OD	FL	Wire	Total Coils	Ends*	Color	Wind
Red Check Valve	0.413	0.930	0.031	7	C & G & T	na	Right
Green Check Valve	0.396	1.046	0.023	11.5	C & G & T	na	Right
Black Check Valve	0.428	0.930	0.035	7	C & G & T	na	Right

*KEY: C = Cut; G = Ground; T = Tapered.