

Aisin AW TF-80SC

Some parts also fit AF40-6.

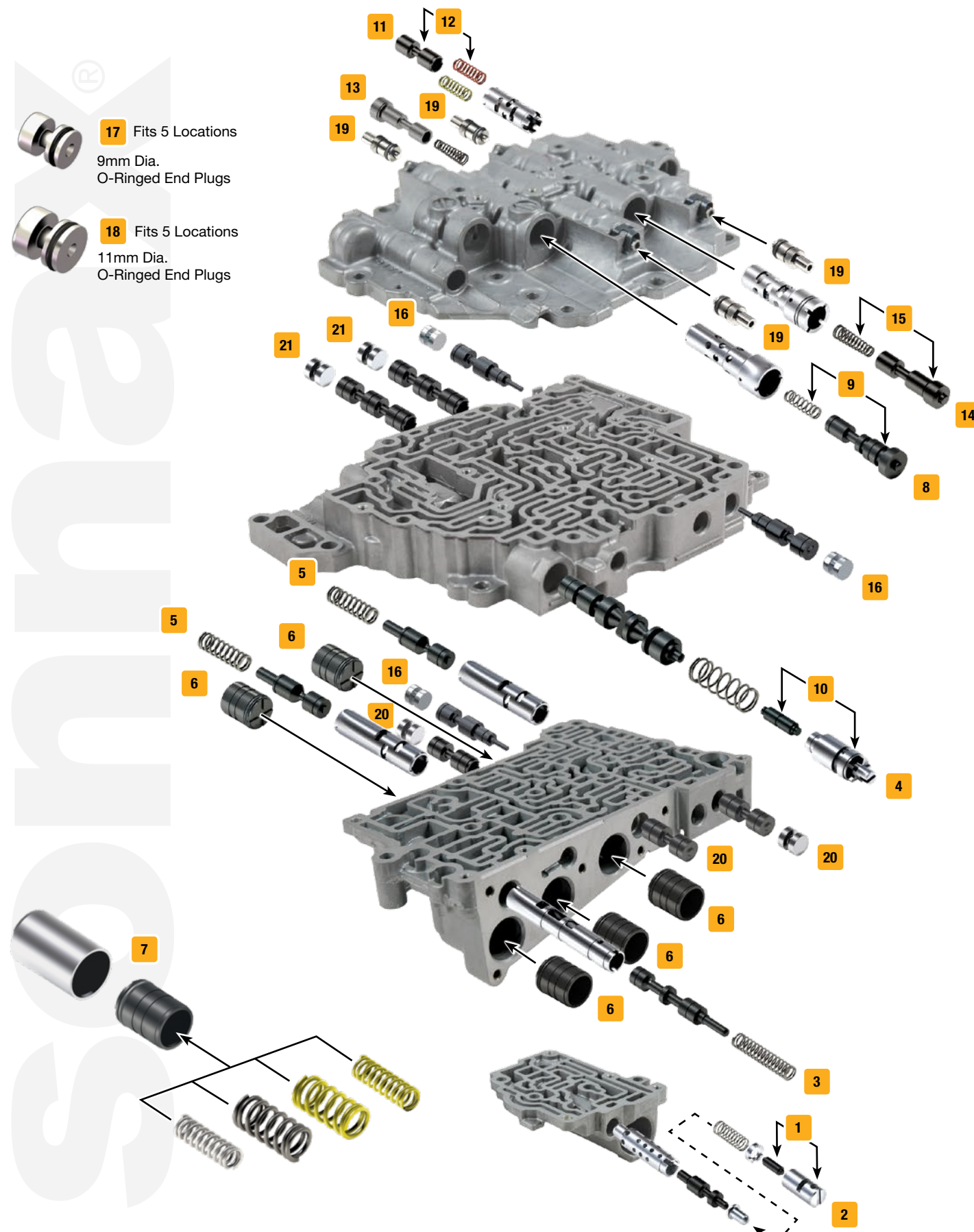

17 Fits 5 Locations
9mm Dia.
O-Ringed End Plugs

18 Fits 5 Locations
11mm Dia.
O-Ringed End Plugs



Click on part numbers for product details or visit www.sonnax.com to see all products for the unit(s) shown here.

Symptoms/Part Type	Product Name	Part No.	Details	Tooling
TCC/Lockup Symptoms				
TCC codes, TCC apply & release concerns, RPM surge on light acceleration	Lockup Clutch Control Plunger Valve Kit	1 15741-53K		
TCC codes, TCC apply & release concerns, RPM surge on light acceleration, Harsh downshifts	Lockup Clutch Control Valve Kit	2 15741-29K		F-15741-TL29*, F-15741-TL29PL*
TCC codes, TCC slip, TCC surge, Loss of lube oil, Overheated fluid, bushings & converter	Secondary Pressure Regulator Valve Kit	3 39741-11K		F-39741-TL11*
Pressure Problems				
Erratic line pressure, Low line rise in Drive, Low line rise in Reverse, Bushing failure	Oversized Main Pressure Regulator & Boost Valve Kit	4 39741-01K		F-39741-TL*
Code 734, 735, 729, Kickdown slip, Kickdown shock, 4th Slip, 5th Slip, 6th Slip	Oversized Solenoid Modulator Valve Kit	5 39741-18K	Fits either of 2 locations	F-39741-TL18*
Shift/Engagement Concerns				
Poor shift quality, Forward slip, Delayed engagement, Burnt clutches	Accumulator Piston Kit	6 15741-14K	Fits any of 5 locations	
Severe wear at accumulator bores, Low clutch oil pressure, Low TCC pressure	Accumulator Piston Kit	7 39741-42K	Fits any of 5 locations, includes selective springs	
1-2 Flare, 2nd Slip, 5-6 Flare, 6th Slip, B1 band burned, Gear ratio & solenoid codes	B1 Band Control Valve Kit	8 39741-22K	Valve, spring & sleeve	F-39741-TL22*
	Oversized B1 Band Control Valve Kit	9 39741-48K	Valve & spring	F-39741-TL48*‡
Delayed Reverse, Low line rise in Reverse, B2 Clutches burned, C3 Clutch burned	Boost Valve Kit	10 39741-44K		
Coastdown Neutral, Delayed Forward, Gear ratio & solenoid codes, K1 Clutch burned	C1/K1 Clutch Control Valve Kit	11 15741-25K	Valve, spring & sleeve, includes selective springs	F-15741-TL25*
C1 Clutch burned, K1 Clutch burned, Coastdown Neutral, Delayed Forward, Erratic shift timing	Oversized C1/K1 Clutch Control Valve Kit	12 15741-55K	Valve & spring	F-15741-TL55*
3-4 Flare, 4-5-6 Slip, Erratic shift timing, C2 Clutch burned	Oversized C2 Clutch Control Valve Kit	13 39741-46K		F-39741-TL46*
2-3 Shift concerns, 4-5 Concerns, Delayed Reverse, C3 Clutch burned, Slips & flares	C3 Clutch Control Valve Kit	14 39741-08K	Valve, spring & sleeve	F-39741-TL5*
	Oversized C3 Clutch Control Valve Kit	15 39741-50K	Valve & spring	F-39741-TL50*
Erratic shift timing, Failsafe mode, Harsh shifts, Burnt clutches, Overheated fluid	Oversized Clutch Cutoff Valve Kit	16 15741-63K	Fits any of 3 locations	F-15741-TL63*
Shift concerns associated with circuit pressure loss	O-Ringed End Plug Kit	17 15741-35K	9mm, includes 5 end plugs	
	O-Ringed End Plug Kit	18 15741-36K	11mm, includes 5 end plugs	
Soft shifts, Flare shifts, Long shifts, Shift quality gets worse as temperature increases	Spring Adjuster Kit	19 15741-48K	Fits 4 locations	
Gear ratio & solenoid codes, Various shift concerns, No shift	Oversized Two-Spool Relay/Signal Valve Kit	20 15741-49K	Fits any of 3 locations	F-33741B-TL1*
	Oversized Three-Spool Relay/Control/Switch Valve Kit	21 15741-50K	Fits either of 2 locations	F-33741B-TL1*

* VB-FIX Required

‡ No longer in production. Check with your distributor for availability.