

Click on part numbers for product details or visit www.sonnax.com to see all products for the unit(s) shown here.

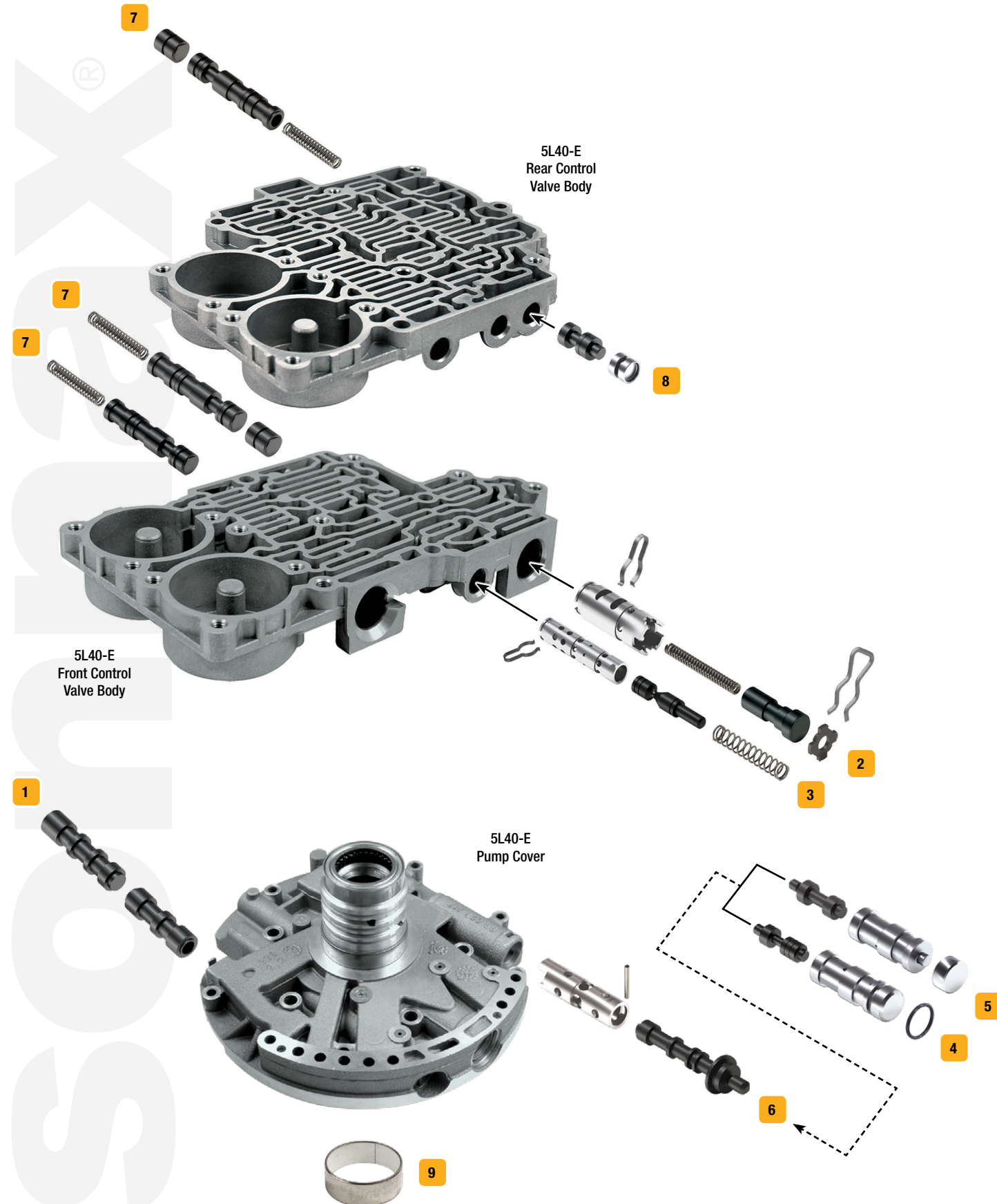

| Symptoms/Benefits | Product Name | Part No. | Details | ZIP Drop-In Zip Valve™ Parts | Tooling |
|--|--|-------------|--|------------------------------|------------------|
| TCC/Lockup Symptoms | | | | | |
| TCC apply & release concerns, Falls out of lockup when hot, No lockup | Oversized TCC Control & Enable Valve Kit | 1 55211-22K | Dual-valve pumps | | F-55211-TL22** ‡ |
| Code 894, 1870, No lockup, TCC slip, No Reverse, Overheated converter, Harsh TCC apply | TCC Regulator Valve Kit | 2 55211-04K | Replaces OE valves with .511" & .437" dia. valve spools | | F-55211-TL4* |
| Pressure Problems | | | | | |
| 2nd Gear starts, Gear ratio codes, Low line pressure, High line pressure, TCC slip, No 4th | AFL Valve Kit | 3 55211-01K | | | F-55211-TL* |
| High line pressure in Reverse, Low line rise, Gear ratio codes, TCC slip, Flare shifts | Boost Valve Kit | 4 55209-04K | ZIP OE ratio with .474" & .441" dia. valve spools | | |
| | Boost Valve Kit | 5 55209-01K | ZIP Performance ratio with .531" & .492" dia. valve spools | | |
| Low pressure, Pump damaged, Pump slide wear, Gear ratio codes, No 4-5 | Pressure Regulator Valve Kit | 6 55211-08K | | | 55211-TL8 |
| Shift/Engagement Concerns | | | | | |
| 1-2 Bind-up, 3-4 Flare, 4-5 Concerns, Clutch distress | Oversized 3-4, 4-5 & Safety Mode Valve Kit | 7 55211-14K | Fits any of 3 locations | | F-55211-TL14*‡ |
| 3-2-1 Bump, Harsh/No engine braking, Clutch failure | Oversized Low Pressure Control Valve Kit | 8 55211-17K | | | F-55211-TL17*‡ |
| High Performance/Heavy Duty Upgrades | | | | | |
| Upgraded bushing material for long-lasting protection against wear | Bushing | 9 77005T | Fits pump, precision, PTFE-lined | | |

* VB-FIX Required

** VB-FIX & VB-06 Required

‡ No longer in production. Check with your distributor for availability.