

Click on part numbers for product details or visit [www.sonnax.com](http://www.sonnax.com) to see all products for the unit(s) shown here.

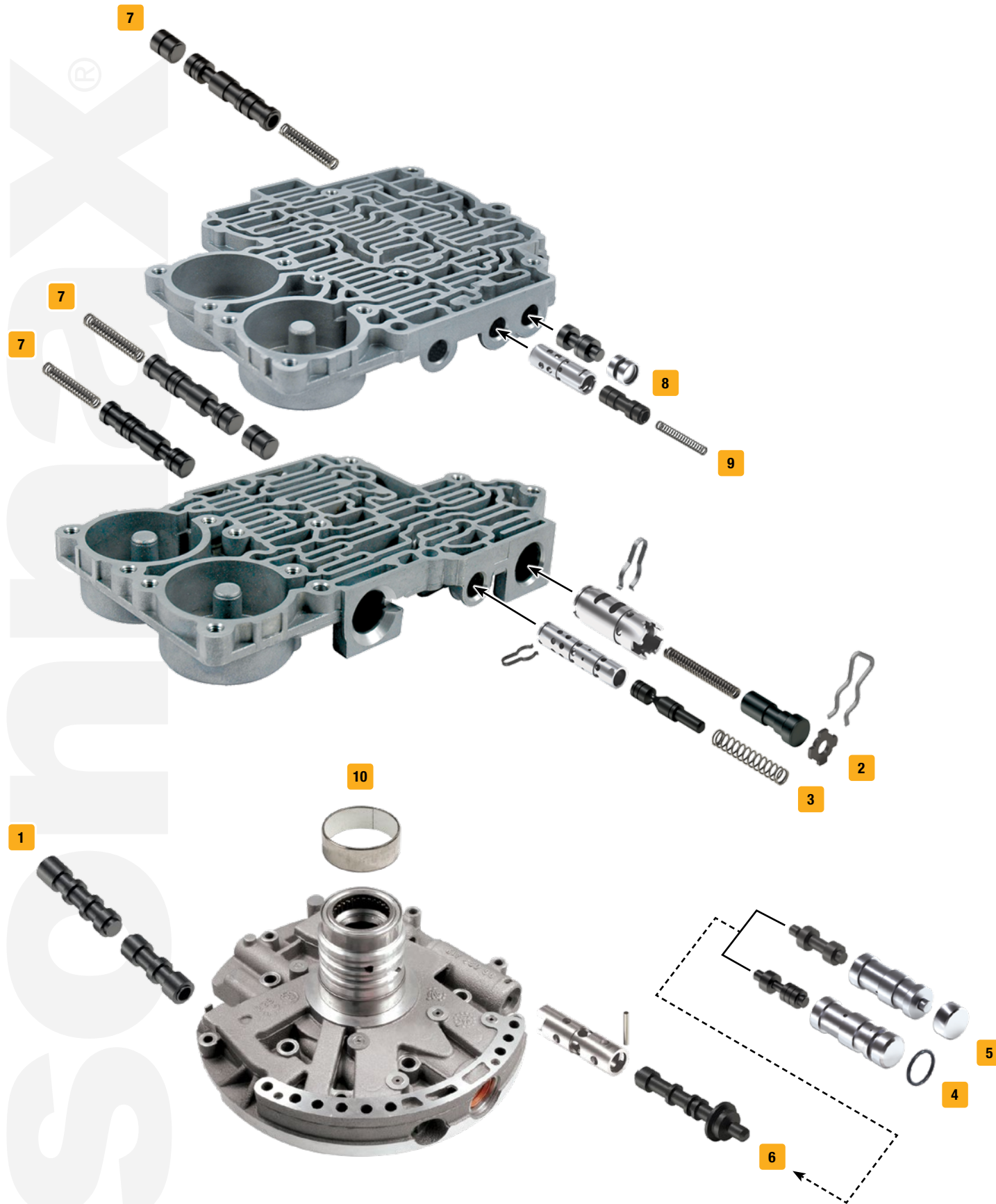

Symptoms/Part Type	Product Name	Part No.	Details	Tooling
<b>TCC/Lockup Symptoms</b>				
TCC apply & release concerns, Falls out of lockup when hot, No lockup	Oversized TCC Control & Enable Valve Kit	<b>1</b> 55211-22K	Dual-valve pumps	F-55211-TL22**
Code 894, 1870, No lockup, TCC slip, No Reverse, Overheated converter, Harsh TCC apply	TCC Regulator Valve Kit	<b>2</b> 55211-04K	Replaces OE valves with .511" & .437" dia. valve spools	F-55211-TL4*
<b>Pressure Problems</b>				
2nd Gear starts, Gear ratio codes, Low line pressure, High line pressure, TCC slip, No 4th	AFL Valve Kit	<b>3</b> 55211-01K		F-55211-TL*
High line pressure in Reverse, Low line rise, Gear ratio codes, TCC slip, Flare shifts	Boost Valve Kit	<b>4</b> 55209-04K	OE ratio with .474" & .441" dia. valve spools	
	Boost Valve Kit	<b>5</b> 55209-01K	Performance ratio with .531" & .492" dia. valve spools	
Low pressure, Pump damaged, Pump slide wear, Gear ratio codes, No 4-5	Pressure Regulator Valve Kit	<b>6</b> 55211-08K		55211-TL8
<b>Shift/Engagement Concerns</b>				
1-2 Bind-up, 3-4 Flare, 4-5 Concerns, Clutch distress	Oversized 3-4, 4-5 & Safety Mode Valve Kit	<b>7</b> 55211-14K	Fits any of 3 locations	F-55211-TL14*‡
3-2-1 Bump, Harsh/No engine braking, Clutch failure	Oversized Low Pressure Control Valve Kit	<b>8</b> 55211-17K		F-55211-TL17*
<b>Component Damage/Failure</b>				
No Reverse, TCC lining overheat, Burnt Low/Reverse clutch, Burnt Reverse clutch	Reverse Lockout Valve Kit	<b>9</b> 55211-11K		F-55211-TL*
<b>High Performance/Heavy Duty Upgrades</b>				
Upgraded bushing material for long-lasting protection against wear	Bushing	<b>10</b> 77005T	Precision, PTFE-lined	

\* VB-FIX Required

\*\* VB-FIX & VB-06 Required

‡ No longer in production. Check with your distributor for availability.