

Click on part numbers for product details or visit www.sonnax.com to see all products for the unit(s) shown here.

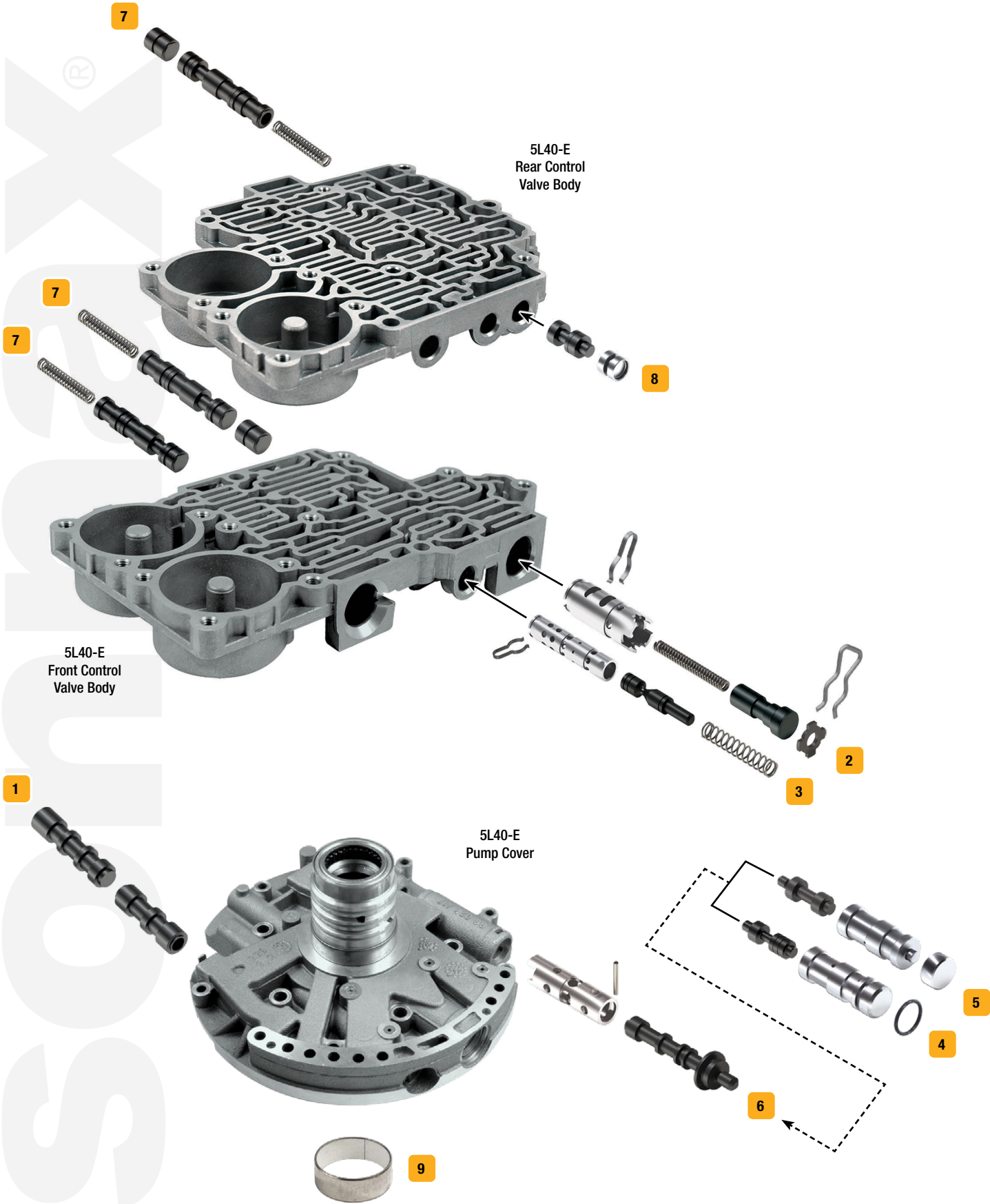

Symptoms/Part Type	Product Name	Part No.	Details	ZIP Drop-In Zip Valve™ Parts	Tooling
TCC/Lockup Symptoms					
TCC apply & release concerns, Falls out of lockup when hot, No lockup	Oversized TCC Control & Enable Valve Kit	1 55211-22K	Dual-valve pumps		F-55211-TL22**
Code 894, 1870, No lockup, TCC slip, No Reverse, Overheated converter, Harsh TCC apply	TCC Regulator Valve Kit	2 55211-04K	Replaces OE valves with .511" & .437" dia. valve spools		F-55211-TL4*
Pressure Problems					
2nd Gear starts, Gear ratio codes, Low line pressure, High line pressure, TCC slip, No 4th	AFL Valve Kit	3 55211-01K			F-55211-TL*
High line pressure in Reverse, Low line rise, Gear ratio codes, TCC slip, Flare shifts	Boost Valve Kit	4 55209-04K	ZIP OE ratio with .474" & .441" dia. valve spools		
	Boost Valve Kit	5 55209-01K	ZIP Performance ratio with .531" & .492" dia. valve spools		
Low pressure, Pump damaged, Pump slide wear, Gear ratio codes, No 4-5	Pressure Regulator Valve Kit	6 55211-08K			55211-TL8
Shift/Engagement Concerns					
1-2 Bind-up, 3-4 Flare, 4-5 Concerns, Clutch distress	Oversized 3-4, 4-5 & Safety Mode Valve Kit	7 55211-14K	Fits any of 3 locations		F-55211-TL14*‡
3-2-1 Bump, Harsh/No engine braking, Clutch failure	Oversized Low Pressure Control Valve Kit	8 55211-17K			F-55211-TL17*
High Performance/Heavy Duty Upgrades					
Upgraded bushing material for long-lasting protection against wear	Bushing	9 77005T	Precision, PTFE-lined		

* VB-FIX Required ** VB-FIX & VB-06 Required
‡ No longer in production. Check with your distributor for availability.