

Click on part numbers for product details or visit [www.sonnax.com](http://www.sonnax.com) to see all products for the unit(s) shown here.

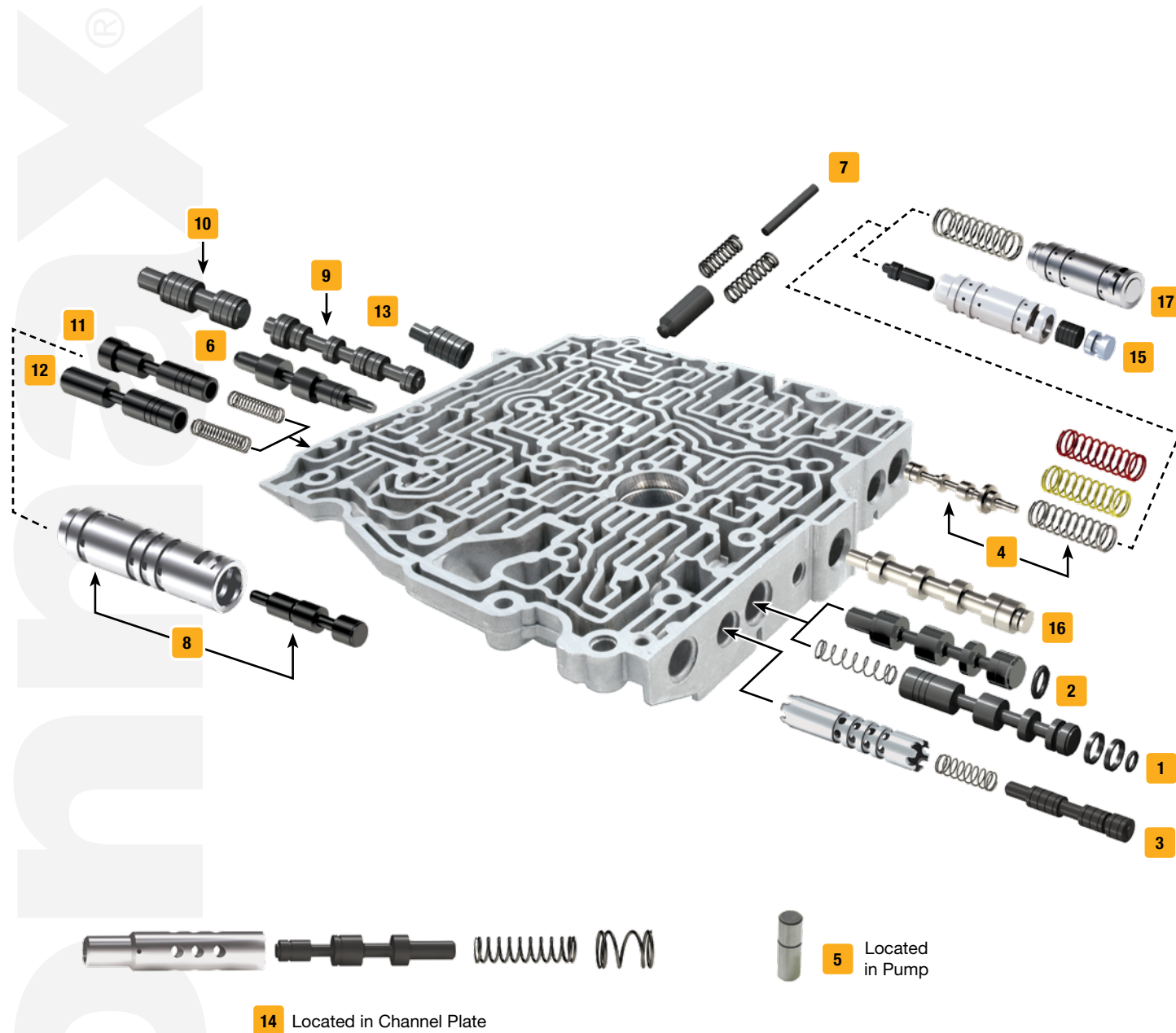

See kit components at [www.sonnax.com](http://www.sonnax.com).

Symptoms/Part Type	Product Name	Part No.	Details	Tooling
<b>Multiple Symptoms</b>				
Comprehensive kit for big problems you don't want back	The Sure Cure® Kit	SC-4T65E		84754-TL3, F-84596-TL*
<b>TCC/Lockup Symptoms</b>				
No lockup, Code P0741, Falls out of lockup when hot, Converter shudder, High TCC slip RPM	TCC Apply Valve Kit	1 84754-43K		
	Oversized TCC Apply Valve Kit	2 84754-50K		F-84754-TL50*
TCC slip, Code P0741, Cycling TCC RPM	TCC Regulated Apply Valve Kit	3 84754-34K		84754-TL3
<b>Pressure Problems</b>				
Erratic line pressure, Burnt clutches, Poor shift quality, Overheating	Oversized Pressure Regulator Valve Kit	4 84754-46K	Includes selective springs	84754-TL46
Erratic line pressure, High line pressure	Pump Slide Pivot Pin	5 84881A	Grooved, 5/bag	
<b>Shift/Engagement Concerns</b>				
1-2 Quality poor, Flare shifts, Soft shifts & poor line rise	Oversized 1-2 Accumulator Valve	6 84754-57K		F-84754-TL57*
1-2 Flare, Delayed engagement, Low Reverse pressure, 1-2 Band burned	Oversized 1-2 & Reverse Servo Boost Valve Kit	7 84754-40K	Fits either of 2 locations	84754-TL2, 84754-TL4
2-3 Shift concerns, Burnt clutches	2-3 Accumulator Valve Kit	8 84754-53K	GM only	
Erratic shifts, 2-3 Shuttle, No 3rd, No 4th, 2nd Gear starts, Temperature-sensitive shifts	2-3 Shift Valve	9 84754-36K	Does not fit Geartronic® or Tapshift® units	
Erratic shifts, 2-3 Shuttle, No 3rd, No 4th, 2nd Gear starts, Temperature-sensitive shifts	3-2 Manual Downshift Valve	10 84754-37K	Does not fit Geartronic® or Tapshift® units	
3-4 Concerns, Soft shifts & poor line rise	Oversized 3-4 Accumulator Valve Kit	11 84754-55K	GM only	F-84754-TL55*‡
	Oversized 3-4 Accumulator Valve Kit	12 84754-58K	Volvo only	F-84754-TL55*‡
Erratic shifts, 2-3 Shuttle, Temperature-sensitive shifts, No 3rd, No 4th, 2nd Gear starts	4-3 Manual Downshift Valve	13 84754-39K		
Erratic line pressure, Maximum adapt, Code 1811, 2nd Gear starts, Poor EPC control	AFL Valve Kit	14 84596-02K		F-84596-TL*
Erratic line pressure, Soft upshifts, Low line rise in Forward, Low line rise in Reverse	Boost Valve Kit	15 84754-30K		
Erratic line pressure, Low line pressure, Code 1811, Code P0741, P0742, Shudder condition	Oversized Torque Signal Valve	16 84754-44		84754-TL44
<b>High Performance/Heavy Duty Upgrades</b>				
Classic, large-ratio boost valve for crisp, clean shifts without harshness	Line Pressure Booster Kit	17 4T65E-LB1		
<b>Tools</b>				
	Vacuum Test Plate Kit	84754-VTP		

\* VB-FIX Required

‡ No longer in production. Check with your distributor for availability.