

Toyota/Lexus U660E/F, U760E/F

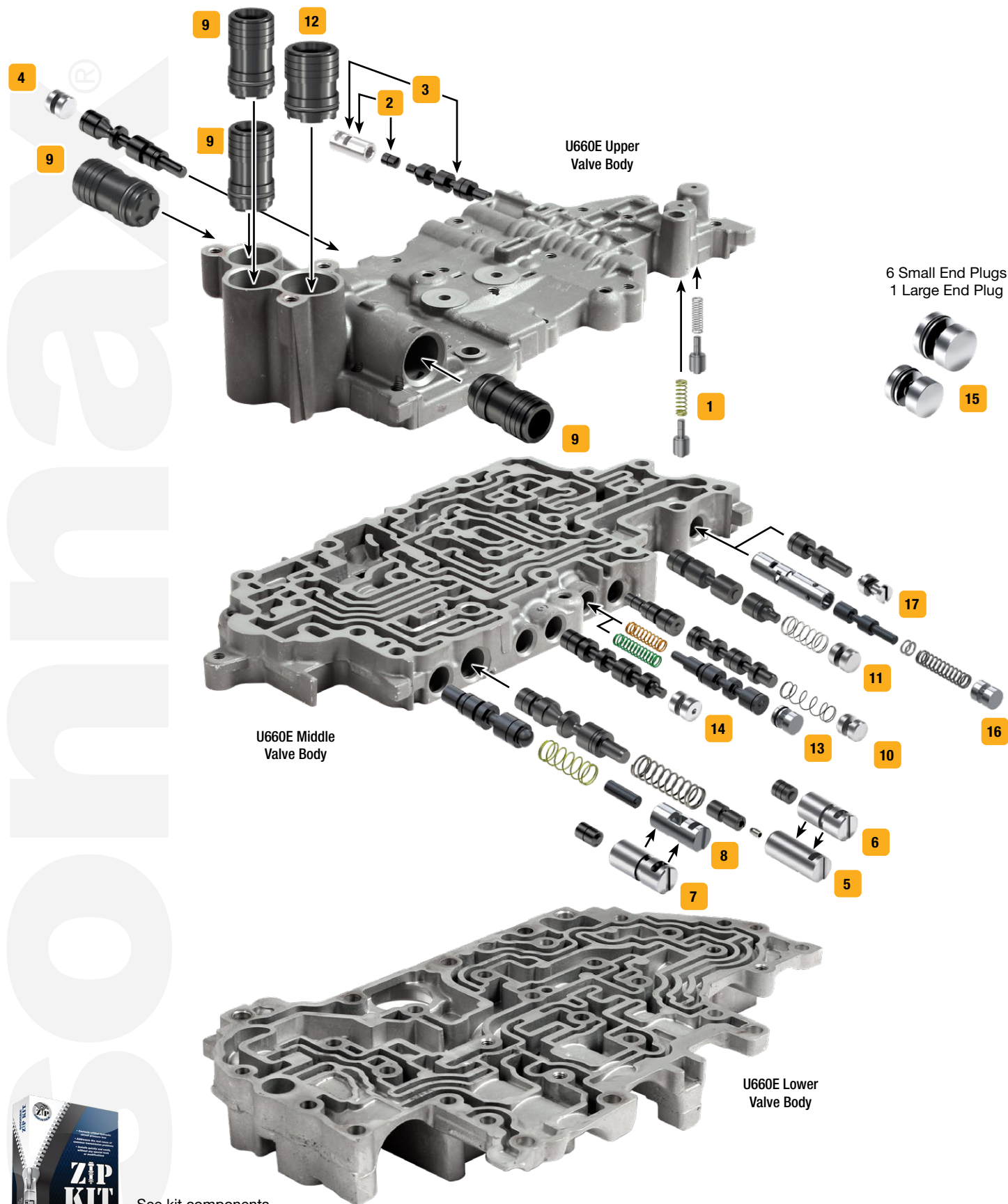

Click on part numbers for product details or visit www.sonnax.com to see all products for the unit(s) shown here.



See kit components at www.sonnax.com.



Symptoms/Benefits	Product Name	Part No.	Details	Tooling
Multiple Symptoms				
The first step in correcting common shift problems	Zip Kit®	U660E-ZIP	ZIP U660E, U660F only	
	Zip Kit®	U760E-ZIP	ZIP U760E, U760F only	
TCC/Lockup Symptoms				
Overheating, Repeated converter failure, TCC slip, TCC slip codes	Oversized Converter & Lube Relief Check Valve Kit	1 47740-60K		47740-TL60†
TCC apply & release concerns, TCC slip codes, Burnt converter, Overheated fluid	Lockup Control Boost Valve Kit	2 47740-06K	ZIP	
TCC slip codes, TCC apply & release concerns, RPM fluctuation, Harsh downshifts	Oversized Lockup Control Valve Kit	3 47740-30K	U660E, U660F only	F-47740-TL30*, F-85755-TL3PL †*
	Oversized Lockup Control Valve Kit	3 47740-31K	U760E, U760F only	F-47740-TL30*
TCC codes, TCC apply & release concerns, TCC shudder, Lube failures, Bearing failure	Oversized Secondary Pressure Regulator Valve Kit	4 47740-26K		F-47740-TL26*
Pressure Problems				
Erratic shifts, Soft shifts, Low line pressure, Low line rise, Clutch slippage, Burnt clutches	Oversized Primary Pressure Regulator & Reverse Boost Valve Kit	5 47740-02K	Replaces either OE ratio	F-47740-TL2*
Delayed Reverse, Low line rise in Reverse, B2 Clutches burned	Reverse Boost Valve Kit	6 47740-17K	ZIP U660E, U660F only	
Delayed Reverse, Low line rise in Reverse, B2 Clutches burned, UD/B3 Clutches burned	Reverse Boost Valve Kit	6 47740-38K	ZIP U760E, U760F only	
Shift/Engagement Concerns				
2nd & 6th Gear shift concerns, B1 Clutches burned	B1 Apply Boost Valve Kit	7 47740-19K	ZIP U660E, U660F only	
1-2 Flare, 5-6 Flare, B1 Clutches burned, Gear ratio codes, No Manual 1st, 2nd Slip, 6th Slip	B1 Apply Boost Valve Kit	7 47740-40K	ZIP U760E, U760F only	
2nd & 6th Gear shift concerns, B1 Clutches burned	Oversized B1 Apply Control Valve Kit	8 47740-57K	U660E, U660F only	F-47740-TL57*
1-2 Long slide, B1 Clutches burned, Clutch failure, Low line pressure	Oversized B1 Apply Control Valve Kit	8 47740-44K	U760E, U760F only	F-47740-TL44*
Burnt clutches, Flare shifts, Harsh shifts, Delayed Reverse with harsh engagement	B1, B2, B3, C2 Accumulator Piston Kit	9 47740-11K	ZIP Fits any of 4 locations	
B2 Clutches burned, Delayed Reverse, No Reverse, Reverse slip	Oversized B2 Apply Control Valve Kit	10 47740-27K		F-47740-TL27*
Delayed Reverse, Harsh Reverse, Double bump Reverse engagement, No Manual 1st	Oversized B2 Control Valve Kit	11 47740-35K		F-47740-TL35*
Delayed Forward, Forward slip, Flare shifts, C1 Clutch burned, Harsh Forward	C1 Accumulator Piston Kit	12 47740-12K	ZIP	
3-4 Flare, C2 Clutch burned, 4-5-6 Slip	Oversized C2 Apply Control Valve Kit	13 47740-63K		F-47740-TL63*
4-5 Harsh, 4-5 Flare, Delayed Neutral to Drive, Delayed Reverse	Oversized Clutch Control Valve Kit	14 47740-22K		F-47740-TL22*‡
Shift concerns, Lockup concerns, Burnt clutches	O-Ringed End Plug Kit	15 47740-21K	ZIP Includes 7 end plugs	
	Solenoid Modulator Valve Kit	16 47740-41K	ZIP U660E, U660F only	
Shift concerns, Solenoid performance codes, TCC apply & release concerns	Solenoid Modulator Valve Kit	16 47740-42K	ZIP U760E, U760F only	
	Oversized Solenoid Modulator Valve Kit	17 47740-24K	U660E, U660F only	F-47740-TL24*
	Oversized Solenoid Modulator Valve Kit	17 47740-25K	U760E, U760F only	F-47740-TL24*
Tools				
	Vacuum Test Plate Kit	47740-VTP		VACTEST-01K

* VB-FIX Required

† Recommended Tool

‡ No longer in production. Check with your distributor for availability.