

Ford 5R55S, 5R55W

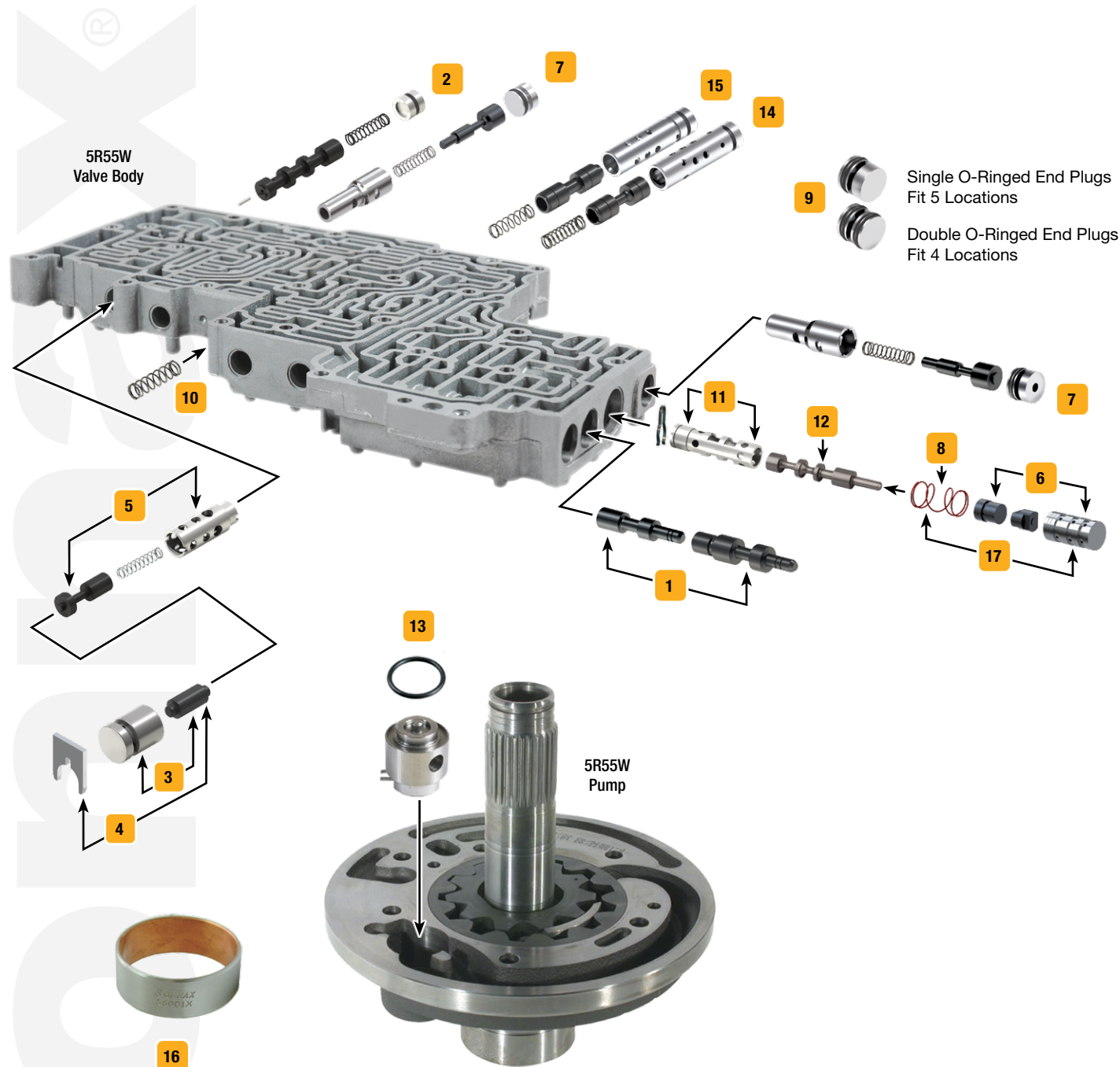

Click on part numbers for product details or visit www.sonnax.com to see all products for the unit(s) shown here.



See kit components at www.sonnax.com.

Symptoms/Part Type	Product Name	Part No.	Details	ZIP Drop-In Zip Valve™ Parts	Tooling
TCC/Lockup Symptoms					
No lockup, Delayed engagement, Overheating Codes 731 to 741, Front lube failure	Oversized Solenoid & Converter Feed Limit Valve Kit	1 56947J-61K			F-56947J-TL61*
Code P0741, Excess TCC slip, TCC lining failure, Overheated converter, Low cooler flow	Oversized TCC Control Valve Kit	2 56947J-05K			F-56947J-TL2*
Slip codes, High TCC slip RPM at increasing load, Overheated fluid	TCC Modulator Plunger Valve Kit	3 56947J-03K	ZIP Increased ratio		
	TCC Modulator Plunger Valve Kit	3 56947J-01K	ZIP OE ratio		
Damaged valve body casting, Slip codes, High TCC slip RPM at increasing load	Oversized TCC Modulator Plunger Valve Kit	4 56947J-80K	.275" Dia., OE ratio		F-56947J-TL80*
	Oversized TCC Modulator Plunger Valve Kit	4 56947J-81K	.288" Dia., increased ratio		F-56947J-TL80*
	Oversized TCC Modulator Plunger Valve Kit	4 56947J-82K	.247" Dia., OE ratio, 4.6L engines		F-56947J-TL80*
Code P0741, Excess TCC slip, Code 1783, High line pressure, Overheated transmission	TCC Modulator Valve Kit	5 56947J-15K			F-56947J-TL15*
Pressure Problems					
No Reverse, Reverse slip, Low Reverse boost, Delayed engagement, Soft shifts, Low line rise	Boost Valve Kit	6 56947J-74K	ZIP		
Flare shifts, Pressure control out-of-range codes, Low line pressure	Oversized VFS Modulator Control Valve Kit	7 56947J-19K	Fits either of 2 locations		F-56947J-TL19*
Shift/Engagement Concerns					
Soft shifts, Poor shift quality, Delayed engagement, Low base line pressure	Elevated Pressure Main Pressure Regulator Spring	8 56947J-S7	5/Bag		
Soft & inconsistent shift feel	O-Ringed End Plug Kit	9 56947J-66K	ZIP Includes 9 end plugs		
Delayed engagement, Burnt Forward clutch	Forward Engagement Control Spring	10 56947J-S6	5/Bag		
Delayed engagement, Soft shifts, Low line rise, Erratic buzz, High line pressure in Reverse	Pressure Regulator Sleeve Kit	11 56947J-09K			56947J-TL9
Delayed engagement, Soft shifts & poor line rise, Erratic buzz, Harsh shifts, Burnt clutches	Pressure Regulator Valve	12 56947J-77	ZIP		
Delayed engagement, No movement, Pump noise, Low line pressure	Pump Flow Control Valve Kit	13 56200-03K	ZIP		
Delayed Reverse, No Reverse, Slipping gears, Direct clutch burned	Reverse Engagement Valve Kit	14 56947J-29K			F-27741-TL13*
Delayed Reverse, No 4th, No 5th, Direct clutch burned	Oversized Reverse Modulator Valve Kit	15 56947J-23K			F-27741-TL13*
Component Damage/Failure					
Repeat front seal leakage, Worn pump bushing, Worn converter hub	Bell Housing/Pump Cover Bushing	16 56001X	Finish-in-place, 5/bag		
High Performance/Heavy Duty Upgrades					
Classic, large-ratio boost valve for crisp, clean shifts without harshness	Line Pressure Booster Kit	17 5R55WS-LB1	ZIP		
Tools					
	Vacuum Test Plate Kit	56947J-VTP			VACTEST-01K

* VB-FIX Required