

# Ford 5R55S, 5R55W

# sonnax®

Click on part numbers for product details or visit [www.sonnax.com](http://www.sonnax.com) to see all products for the unit(s) shown here.

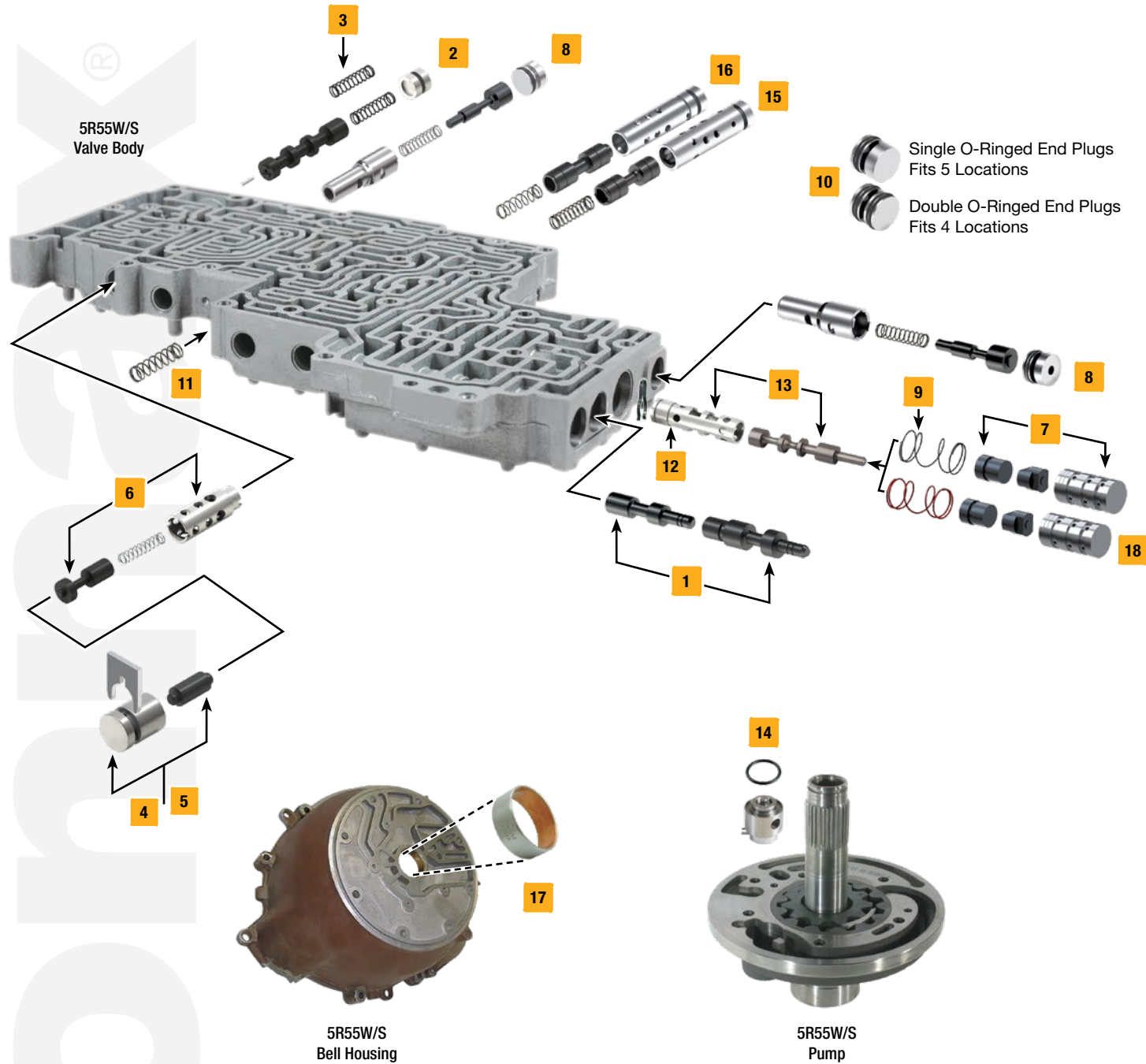

Symptoms/Part Type	Product Name	Part No.	Details	ZIP Drop-In Zip Valve™ Parts	Tooling
<b>TCC/Lockup Symptoms</b>					
No lockup, Delayed engagement, Codes 731 to 741, Overheating, Front lube failure	Oversized Solenoid & Converter Feed Limit Valve Kit	1 56947J-61K			F-56947J-TL61*
Code P0741, Excess TCC slip, TCC lining failure, Overheated converter, Low cooler flow	Oversized TCC Control Valve Kit	2 56947J-05K			F-56947J-TL2*
Engine stall, No TCC release, TCC cycling, Burnt converter	TCC Control Valve Spring	3 56947J-S3	5/Bag		
Slip codes, High TCC slip RPM at increasing load, Overheated fluid	TCC Modulator Plunger Valve Kit	4 56947J-03K		ZIP Increased ratio	
	TCC Modulator Plunger Valve Kit	4 56947J-01K		ZIP OE ratio	
Damaged valve body casting, Slip codes, High TCC slip RPM at increasing load	Oversized TCC Modulator Plunger Valve Kit	5 56947J-80K	OE ratio		F-56947J-TL80*
	Oversized TCC Modulator Plunger Valve Kit	5 56947J-81K	Increased ratio		F-56947J-TL80*
	Oversized TCC Modulator Plunger Valve Kit	5 56947J-82K	OE ratio, Fits 4.6L engines		F-56947J-TL80*
Code P0741, Excess TCC slip, Code 1783, High line pressure, Overheated transmission	TCC Modulator Valve Kit	6 56947J-15K			F-56947J-TL15*
<b>Pressure Problems</b>					
No Reverse, Reverse slip, Low Reverse boost, Delayed engagement, Soft shifts, Low line rise	Boost Valve Kit	7 56947J-74K		ZIP	
Flare shifts, Pressure control out-of-range codes, Low line pressure	Oversized VFS Modulator Control Valve Kit	8 56947J-19K	Fits either of 2 locations		F-56947J-TL19*
<b>Shift/Engagement Concerns</b>					
Soft shifts, Poor shift quality, Delayed engagement, Low base line pressure	Elevated Pressure Main Pressure Regulator Spring	9 56947J-S7	5/Bag		
Soft & inconsistent shift feel	O-Ringed End Plug Kit	10 56947J-66K		ZIP Includes 9 end plugs	
Delayed engagement, Burnt Forward clutch	Forward Engagement Control Spring	11 56947J-S6	5/Bag		
Delayed engagement, Soft shifts, Low line rise, Erratic buzz, High line pressure in Reverse	Pressure Regulator Sleeve Kit	12 56947J-09K			56947J-TL9
Delayed engagement, Soft shifts & poor line rise, Erratic buzz, Harsh shifts, Burnt clutches	Pressure Regulator Valve	13 56947J-77		ZIP	
Delayed engagement, No movement until RPM increased, Pump noise, Low line pressure	Pump Flow Control Valve Kit	14 56200-03K		ZIP	
Delayed Reverse, No Reverse, Slipping gears, Direct clutch burned	Reverse Engagement Valve Kit	15 56947J-29K			F-27741-TL13*
Delayed Reverse, No 4th, No 5th, Direct clutch burned	Oversized Reverse Modulator Valve Kit	16 56947J-23K			F-27741-TL13*
<b>Component Damage/Failure</b>					
Repeat front seal leakage, Worn pump bushing, Worn converter hub	Bell Housing/Pump Cover Bushing	17 56001X	Finish-in-Place, 5/bag		
<b>High Performance/Heavy Duty Upgrades</b>					
Classic, large-ratio boost valve for crisp, clean shifts without harshness	Line Pressure Booster Kit	18 5R55WS-LB1			
<b>Tools</b>					
	Vacuum Test Plate Kit	56947J-VTP	VACTEST-01K		VACTEST-01K

\* VB-FIX Required