

Ford 5R55S, 5R55W

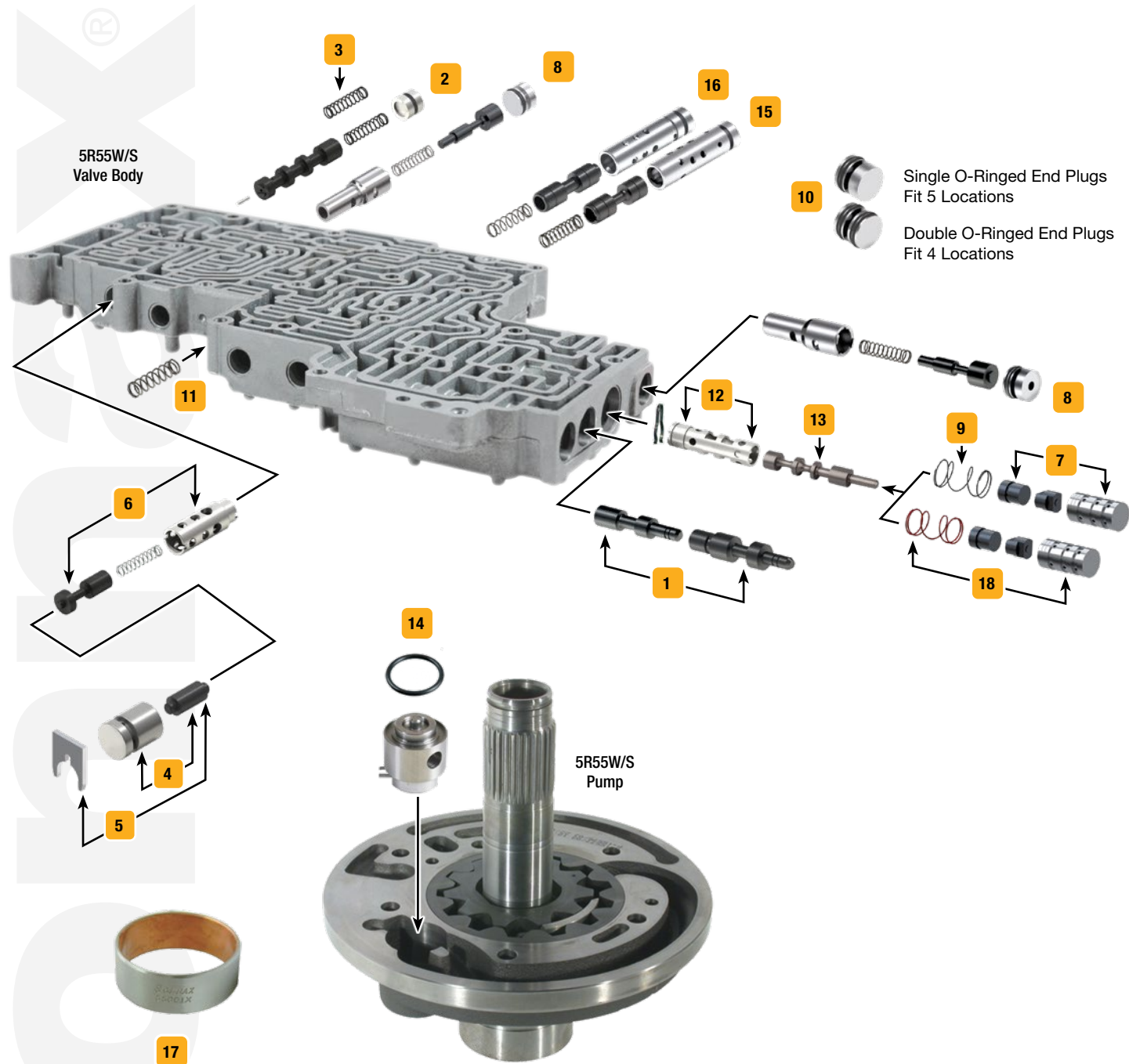

Click on part numbers for product details or visit www.sonnax.com to see all products for the unit(s) shown here.



Symptoms/Part Type	Product Name	Part No.	Details	Tooling
TCC/Lockup Symptoms				
No lockup, Delayed engagement, Codes 731 to 741, Overheating, Front lube failure	Oversized Solenoid & Converter Feed Limit Valve Kit	1 56947J-61K		F-56947J-TL61*
Code P0741, Excess TCC slip, TCC lining failure, Overheated converter, Low cooler flow	Oversized TCC Control Valve Kit	2 56947J-05K		F-56947J-TL2*
Engine stall, No TCC release, TCC cycling, Burnt converter	TCC Control Valve Spring	3 56947J-S3	5/Bag	
Slip codes, High TCC slip RPM at increasing load, Overheated fluid	TCC Modulator Plunger Valve Kit	4 56947J-03K	ZIP Increased ratio	
	TCC Modulator Plunger Valve Kit	4 56947J-01K	ZIP OE ratio	
Damaged valve body casting, Slip codes, High TCC slip RPM at increasing load	Oversized TCC Modulator Plunger Valve Kit	5 56947J-80K	OE ratio	F-56947J-TL80*
	Oversized TCC Modulator Plunger Valve Kit	5 56947J-81K	Increased ratio	F-56947J-TL80*
	Oversized TCC Modulator Plunger Valve Kit	5 56947J-82K	OE ratio, Fits 4.6L engines	F-56947J-TL80*
Code P0741, Excess TCC slip, Code 1783, High line pressure, Overheated transmission	TCC Modulator Valve Kit	6 56947J-15K		F-56947J-TL15*
Pressure Problems				
No Reverse, Reverse slip, Low Reverse boost, Delayed engagement, Soft shifts, Low line rise	Boost Valve Kit	7 56947J-74K	ZIP	
Flare shifts, Pressure control out-of-range codes, Low line pressure	Oversized VFS Modulator Control Valve Kit	8 56947J-19K	Fits either of 2 locations	F-56947J-TL19*
Shift/Engagement Concerns				
Soft shifts, Poor shift quality, Delayed engagement, Low base line pressure	Elevated Pressure Main Pressure Regulator Spring	9 56947J-S7	5/Bag	
Soft & inconsistent shift feel	O-Ringed End Plug Kit	10 56947J-66K	ZIP Includes 9 end plugs	
Delayed engagement, Burnt Forward clutch	Forward Engagement Control Spring	11 56947J-S6	5/Bag	
Delayed engagement, Soft shifts, Low line rise, Erratic buzz, High line pressure in Reverse	Pressure Regulator Sleeve Kit	12 56947J-09K		56947J-TL9
Delayed engagement, Soft shifts & poor line rise, Erratic buzz, Harsh shifts, Burnt clutches	Pressure Regulator Valve	13 56947J-77	ZIP	
Delayed engagement, No movement until RPM increased, Pump noise, Low line pressure	Pump Flow Control Valve Kit	14 56200-03K	ZIP	
Delayed Reverse, No Reverse, Slipping gears, Direct clutch burned	Reverse Engagement Valve Kit	15 56947J-29K		F-27741-TL13*
Delayed Reverse, No 4th, No 5th, Direct clutch burned	Oversized Reverse Modulator Valve Kit	16 56947J-23K		F-27741-TL13*
Component Damage/Failure				
Repeat front seal leakage, Worn pump bushing, Worn converter hub	Bell Housing/Pump Cover Bushing	17 56001X	Finish-in-Place, 5/bag	
High Performance/Heavy Duty Upgrades				
Classic, large-ratio boost valve for crisp, clean shifts without harshness	Line Pressure Booster Kit	18 5R55WS-LB1	ZIP	
Tools				
	Vacuum Test Plate Kit	56947J-VTP		VACTEST-01K

* VB-FIX Required