

Chrysler 42-44-46-47RH/RE, 48RE

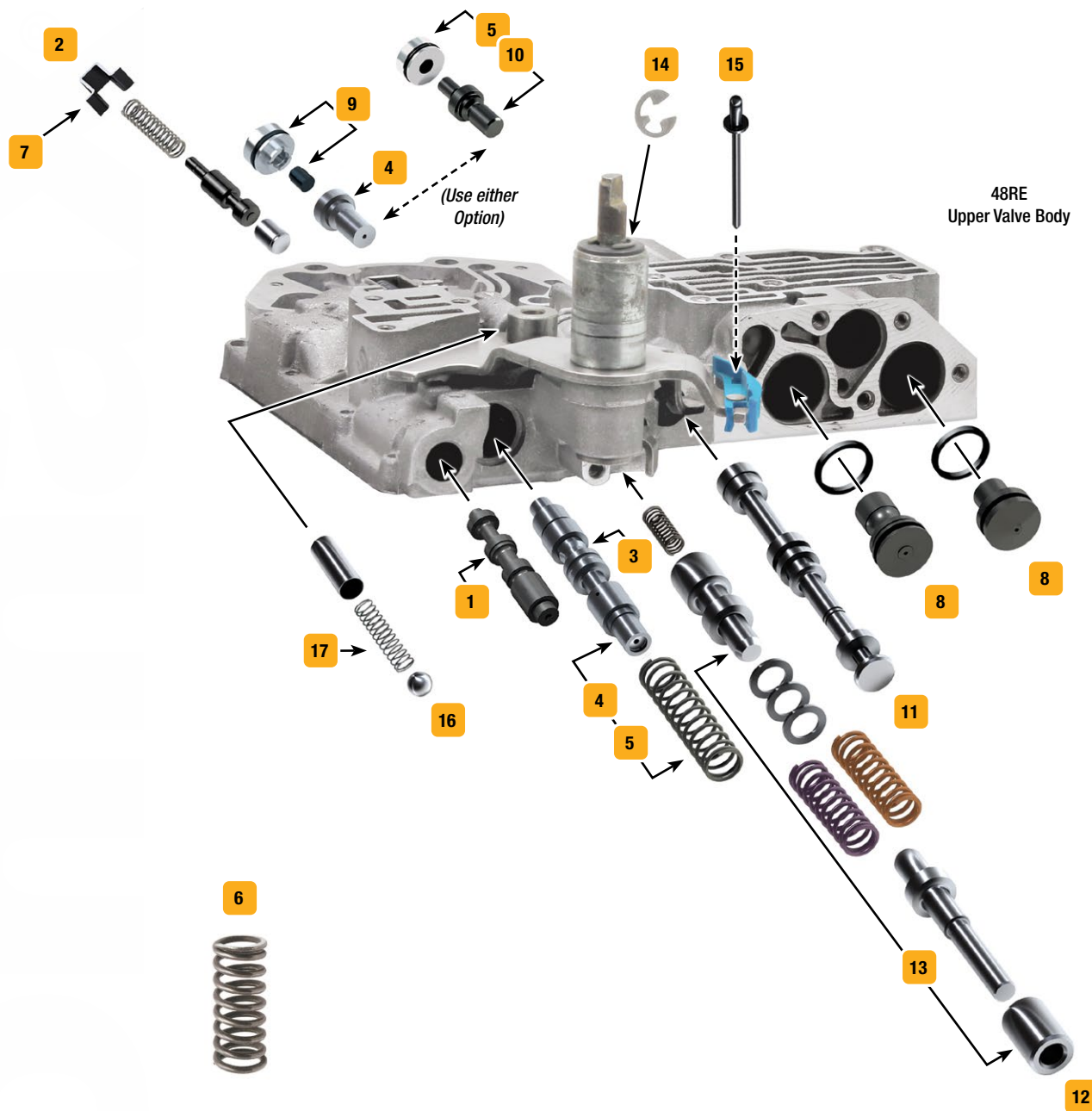

Click on part numbers for product details or visit www.sonnax.com to see all products for the unit(s) shown here.



See kit components at www.sonnax.com.

Symptoms/Part Type	Product Name	Part No.	Details	Drop-In ZIP Zip Valve™ Parts	Tooling
Multiple Symptoms					
Comprehensive kit for big problems you don't want back	The Sure Cure® Kit	SC-42RHE	42RH/RE only		
	The Sure Cure® Kit	SC-46-47RHE-OS	46-47RH/RE only		F-22771A-TL7*, 22771A-TL13, 22771-TL12, F-22771-TL*
	The Sure Cure® Kit	SC-48RE	48RE only		
The first step in correcting common shift problems	Zip Kit®	46-47RHE-ZIP	ZIP 46-47RH/RE only		
	Zip Kit®	48RE-ZIP	ZIP 48RE only		
TCC/Lockup Symptoms					
Lockup shudder, Overheated converter, Low cooler flow, Soft TCC apply	4-Spool Switch Valve	1 22771A-01	ZIP '93-Later, improved Sonnax design		
	4-Spool Switch Valve	1 22771A-43	ZIP '93-Later, OE design		
	Oversized 4-Spool Switch Valve	1 22771A-13	'93-Later, improved Sonnax design		22771A-TL13
TCC slip under load, No line rise during TCC apply in 4th, Overheated converter, No lockup	Oversized Lockup Boost Valve Kit	2 22771-19K	'94-Later with boost oil delivery tube		F-22771-TL19*
Pressure Problems					
Delayed engagement, Pressure regulator buzz, Converter drain back, Lube failures	Lube Regulated Pressure Regulator Valve	4 22771A-02K	ZIP OE valve must match '79-later design		
	Oversized Lube Regulated Pressure Regulator Valve Kit	5 22771A-07K	42-44-46-47RH/RE only, OE valve must match '78-later design		F-22771A-TL7*
	Oversized Lube Regulated Pressure Regulator Valve & Line/TV Pressure Plug Kit	6 22771A-16K	48RE only		F-22771A-TL7*
Delayed engagement, Pressure regulator buzz, Lost or damaged component	Pressure Regulator Valve	4 22771A-42	ZIP '78-Later only, OE 4130169		
Shift/Engagement Concerns					
3-4 Soft	3-4 Accumulator Spring	7 12861-01	Matches OE 47RE diesel calibration		
Leakage of 4th & TCC oil pressure, Slipping gears	Boost Valve Spring Retainer	8 22990-01	5/Bag		
1-2 Shuttle, 2-3, 3-2 Oversensitive, Early upshifts	Governor Bore Plug Kit	9 22771-14K	ZIP		
Reverse slip, Poor line pressure control, Poor Forward & Reverse engagement, Soft Reverse	Line Pressure Plug & Sleeve Kit	10 22229-01K	ZIP 42-44-46-47RH/RE only, .200" dia. plug		
	Line Pressure Plug & Sleeve Kit	10 22229-04K	ZIP 42-44-46-47RH/RE only, .264" dia. plug		
	Line Pressure Plug & Sleeve Kit	11 22771A-19K	48RE only		
Delayed engagement, No cooler flow in Park, Converter bushing failure	Manual Valve	12 22771-09	ZIP Use with '78-later pressure regulator valve only		
Shift timing concerns, Throttle buzz, Poor kickdown, 2-3 Late, 3-2 Oversensitive	Throttle Valve Kit	13 22771-03K	ZIP Fits all Chrysler RWD models, including '05-later units with motorized linkage		
	Oversized Throttle Valve Kit	14 22771-04K	Fits all Chrysler RWD models, including '05-later units with motorized linkage		F-22771-TL*
Component Damage/Failure					
Lost or damaged component	E-Ring	15 10000-03K	Manual shaft retainer, .250" shaft dia, 10/bag		
	Neutral Safety Back-Up Insulator Service Kit	16 22229-03	42-44-46-47RH/RE '70-'02 with 3-terminal switch only		
	Neutral Safety Back-up Insulator Service Kit	16 22229-07K	'02-Later with 5-terminal switch only		
Manual lever binds in Park position, No start, Damaged valve body casting, Linkage loose	Valve Body Detent Ball & Sleeve Kit	17 22771-12K	Fits both short & long OE detent bore designs		22771-TL12
Manual lever binds, Linkage loose, No start	Valve Body Detent Spring	18 22771-36	Fits both short & long OE detent bore designs, 5/bag		
High Performance/Heavy Duty Upgrades					
Reduces throttle sensitivity	Heavy Duty Throttle Valve Kit	13 22771-HDK3	ZIP Fits all Chry RWD models, including '05-later with motorized linkage		

* VB-FIX Required