

# Jatco/Nissan JF015E (RE0F11A)

These parts also fit Mitsubishi F1CJB.

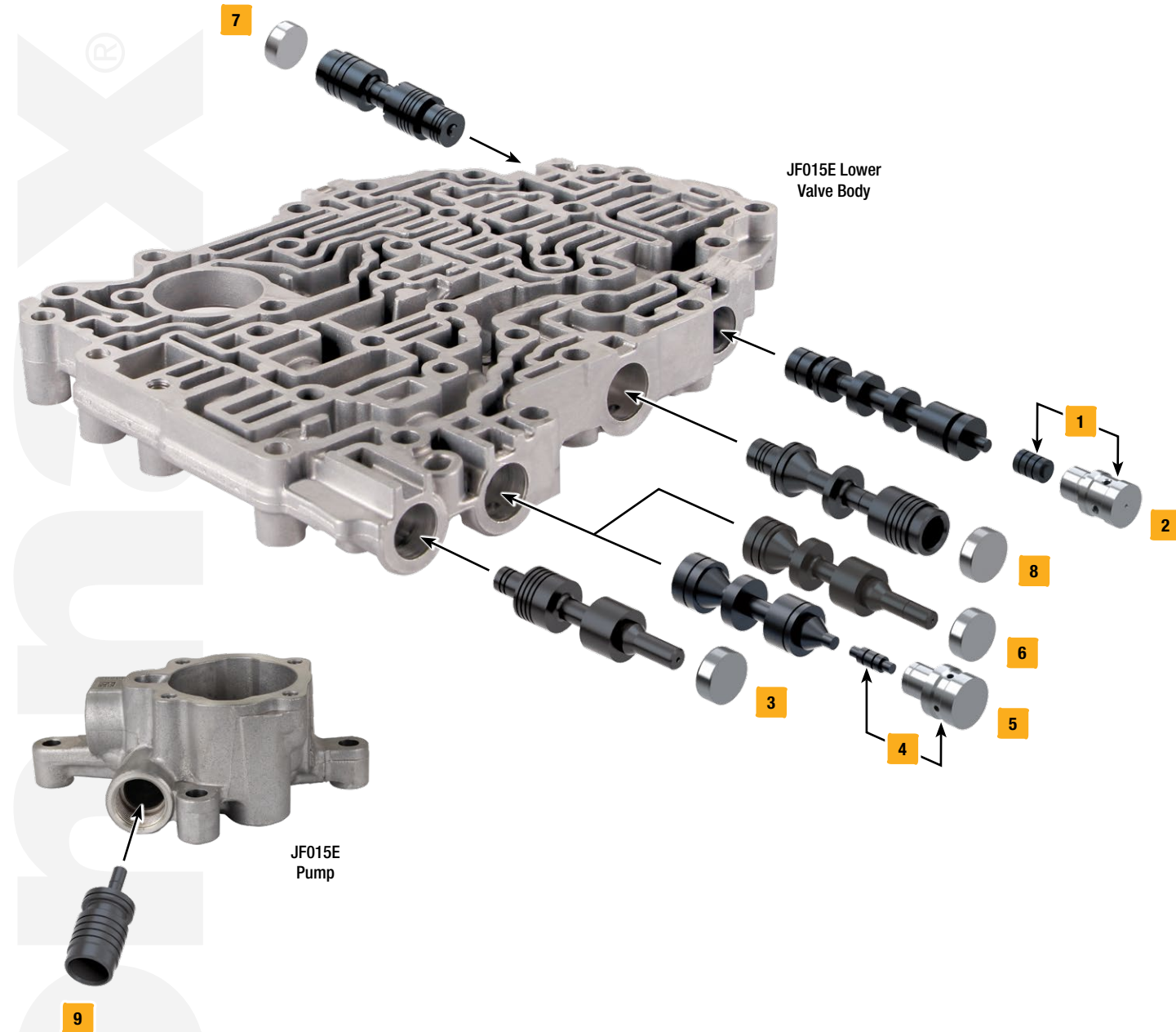

# sonnax®

Click on part numbers for product details or visit [www.sonnax.com](http://www.sonnax.com) to see all products for the unit(s) shown here.

Symptoms/Part Type	Product Name	Part No.	Details	ZIP Drop-In Zip Valve™ Parts	Tooling
<b>TCC/Lockup Symptoms</b>					
Jerking on coastdown, High engine RPM, Engine stall on engagement, No lockup	Lockup Control Plunger Valve Kit	<a href="#">1</a> <a href="#">113741-11K</a>	<b>ZIP</b>		
Jerking on coastdown, Harsh engagement, High engine RPM, No lockup	Oversized Lockup Control & Plunger Valve Kit	<a href="#">2</a> <a href="#">33741F-09K</a>			F-33741F-TL9*
Chatter on acceleration, Noise on acceleration, Push belt slippage, Low line rise	Oversized Solenoid Regulator Valve Kit	<a href="#">3</a> <a href="#">33741F-03K</a>			F-33741F-TL3*
Engine stall on engagement, Increased RPM during acceleration, No lockup, Overheated fluid	Torque Converter Lube Regulator Plunger Valve Kit	<a href="#">4</a> <a href="#">33741F-07K</a>	<b>ZIP</b> For valve assemblies with plunger valve & sleeve		
	Oversized Torque Converter Lube Regulator & Plunger Valve Kit	<a href="#">5</a> <a href="#">33741F-05K</a>	For valve assemblies with plunger valve & sleeve		F-33741F-TL4*
	Oversized Torque Converter Lube Regulator Valve Kit	<a href="#">6</a> <a href="#">33741F-04K</a>	For valve assemblies without plunger valve & sleeve		F-33741F-TL4*
<b>Pressure Problems</b>					
Chatter on acceleration, Damaged valve body casting, High line pressure, Low line pressure	Oversized Primary Pulley Regulator Valve Kit	<a href="#">7</a> <a href="#">33741F-02K</a>			F-33741F-TL2*
Push belt slippage, Pulley breakage, RPM surge, Chatter on acceleration	Oversized Secondary Pulley/Pressure Regulator Valve Kit	<a href="#">8</a> <a href="#">33741F-01K</a>			F-33741F-TL*
<b>Shift/Engagement Concerns</b>					
Push belt slippage, Delayed engagement, Low pump volume	Pump Flow Control Valve	<a href="#">9</a> <a href="#">33510N-02</a>	<b>ZIP</b> '07-Later		
	Oversized Pump Flow Control Valve	<a href="#">9</a> <a href="#">33510N-01</a>	'07-Later		F-33510N-TL*

\* VB-FIX Required