

Critical Wear Areas & Vacuum Test Locations

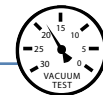

NOTE: OE valves are shown in rest position and should be tested in rest position unless otherwise indicated. Test locations are pointed to with an arrow. Springs are not shown for visual clarity. Low vacuum reading indicates wear.

Upper Valve Body • 6T70 (Gen. 2)

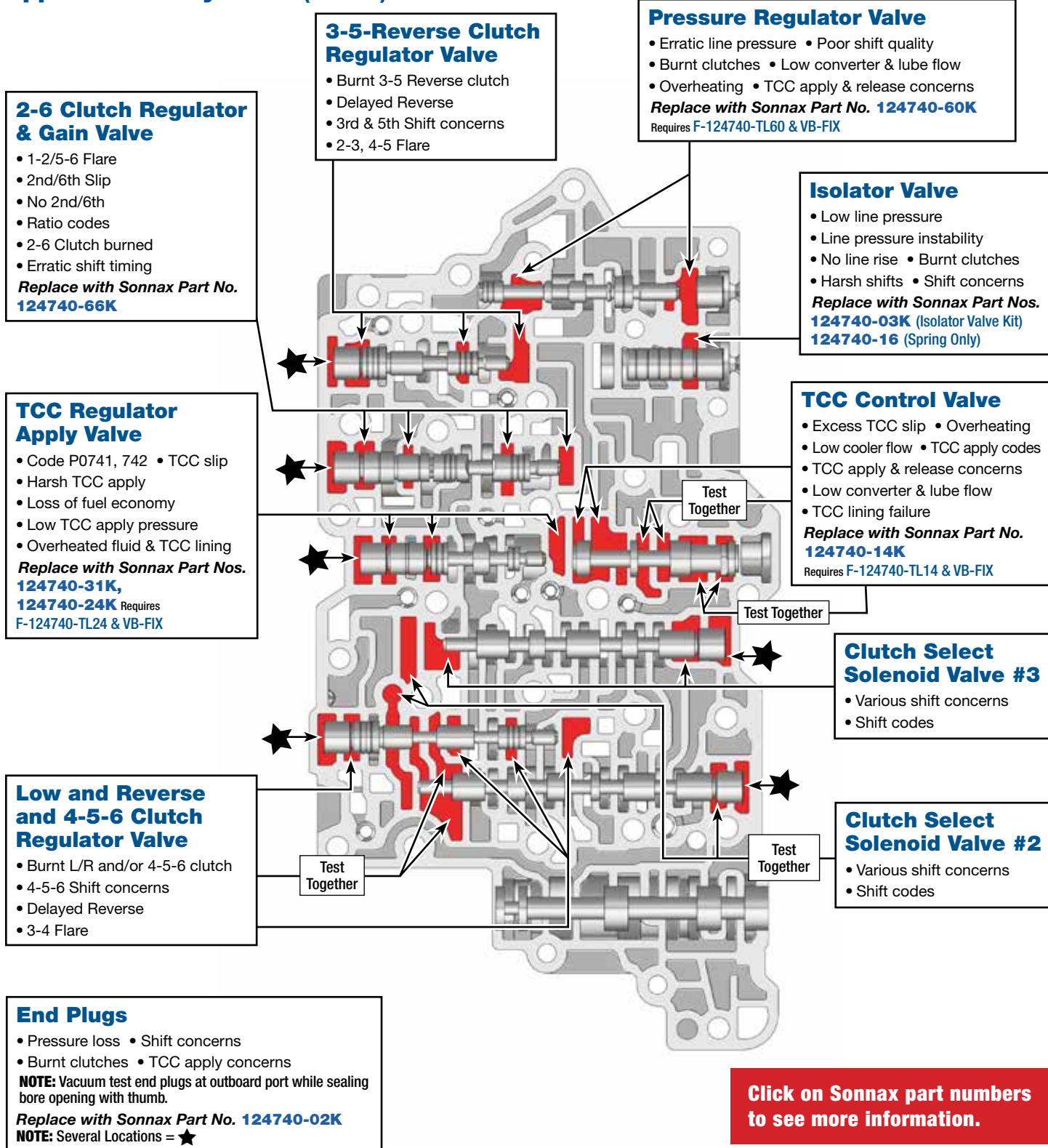

Critical Wear Areas & Vacuum Test Locations

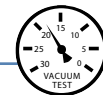

NOTE: OE valves are shown in rest position and should be tested in rest position unless otherwise indicated. Test locations are pointed to with an arrow. Springs are not shown for visual clarity. Low vacuum reading indicates wear.

Lower Valve Body • 6T70 (Gen. 2)

Click on Sonnax part numbers to see more information.

3-5-R Clutch Boost Valve

- Shift quality is not load sensitive
- Harsh shifts • Slips & flares
- Delayed engagement • Burnt clutches
- Slide shifts • Slip codes

Replace with Sonnax Part No. 124740-56

Requires F-144740-TL22 & VB-FIX

Actuator Feed Limit Valve

- Solenoid performance codes
- Wrong gear starts • Clutch failure

Replace with Sonnax Part Nos. 124740-33K,

124740-48K Requires F-124740-TL48 & VB-FIX

4-5-6 Clutch Boost Valve

- Shift quality is not load sensitive
- Harsh shifts • Slips & flares
- Delayed engagement • Burnt clutches
- Slide shifts • Slip codes

Replace with Sonnax Part No. 124740-56

Requires F-144740-TL22 & VB-FIX

4-5-6 Clutch Accumulator Piston

- 3-4 Flare • Ratio codes
- 4-5-6 Clutch burned
- Slipping gears • 3-4 Harsh

Replace with Sonnax Part No. 124740-57K

1-2-3-4 Clutch Boost Valve

- Shift quality is not load sensitive
- Harsh shifts • Slips & flares
- Delayed engagement
- Burnt clutches • Slide shifts
- Slip codes

Replace with Sonnax Part No. 124740-56

Requires F-144740-TL22 & VB-FIX

1-2-3-4 Clutch Regulator Valve

- Burnt 1-2-3-4 clutch
- Delayed Forward
- 1-2-3-4 Shift concerns

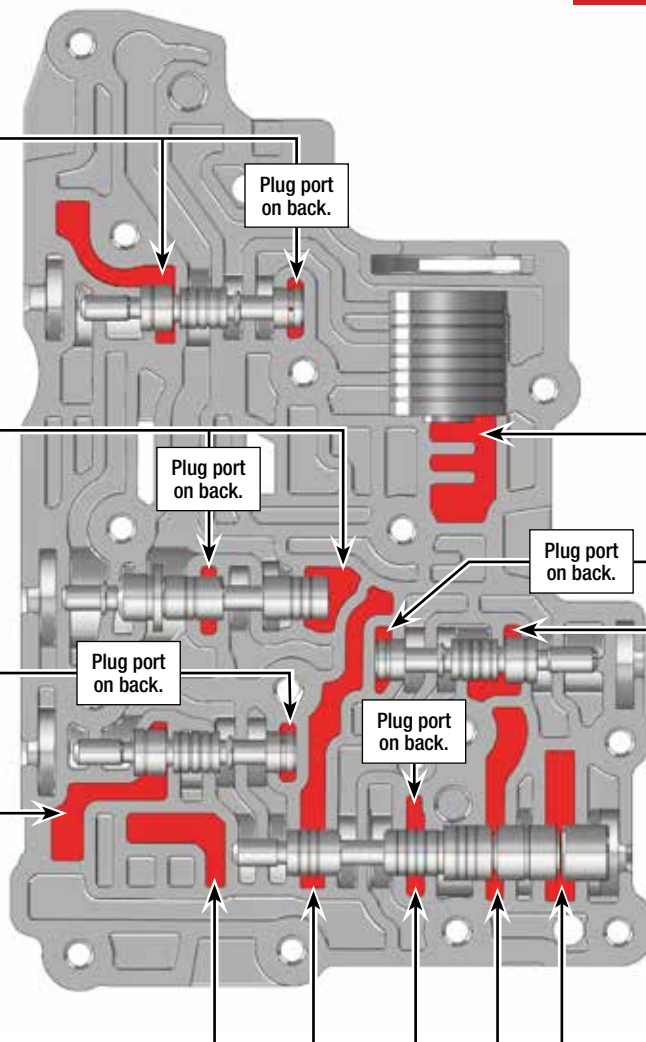

OE Exploded View

Upper Valve Body • 6T70 (Gen. 2)

NOTE: Depending upon vehicle application, the OE springs shown may not be present.

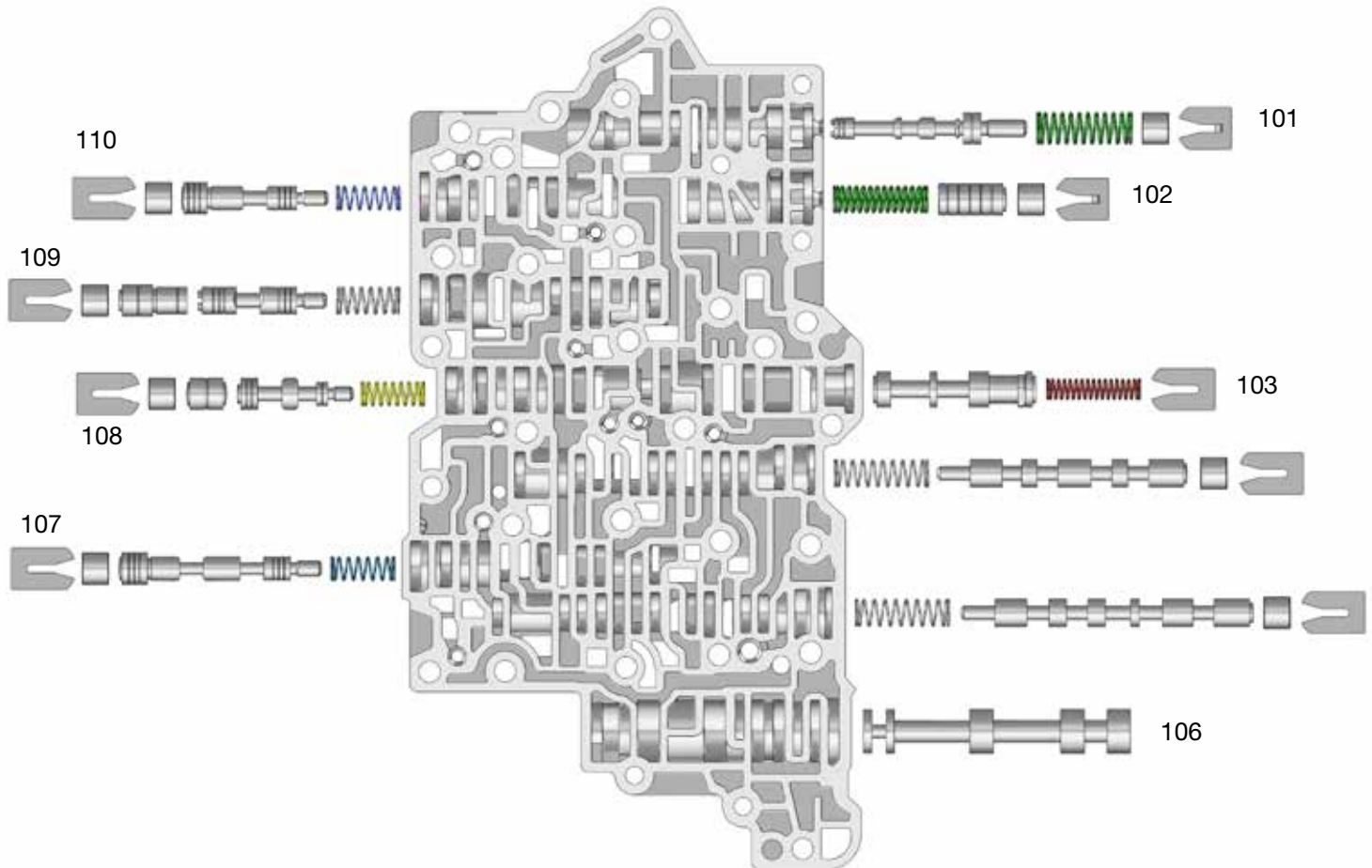

6T70 (Gen. 2) Upper Valve Body Descriptions

I.D. No.	Description
101	Pressure Regulator Valve
102	Isolator Valve
103	TCC Control Valve
104	Clutch Select Solenoid Valve #3
105	Clutch Select Solenoid Valve #2
106	Manual Valve
107	Low and Reverse and 4-5-6 Clutch Regulator Valve
108	TCC Regulator Apply Valve
109	2-6 Clutch Regulator & Gain Valve
110	3-5-Reverse Clutch Regulator Valve

OE Exploded View

Lower Valve Body • 6T70 (Gen. 2)

NOTE: Depending upon vehicle application, the OE springs shown may not be present.

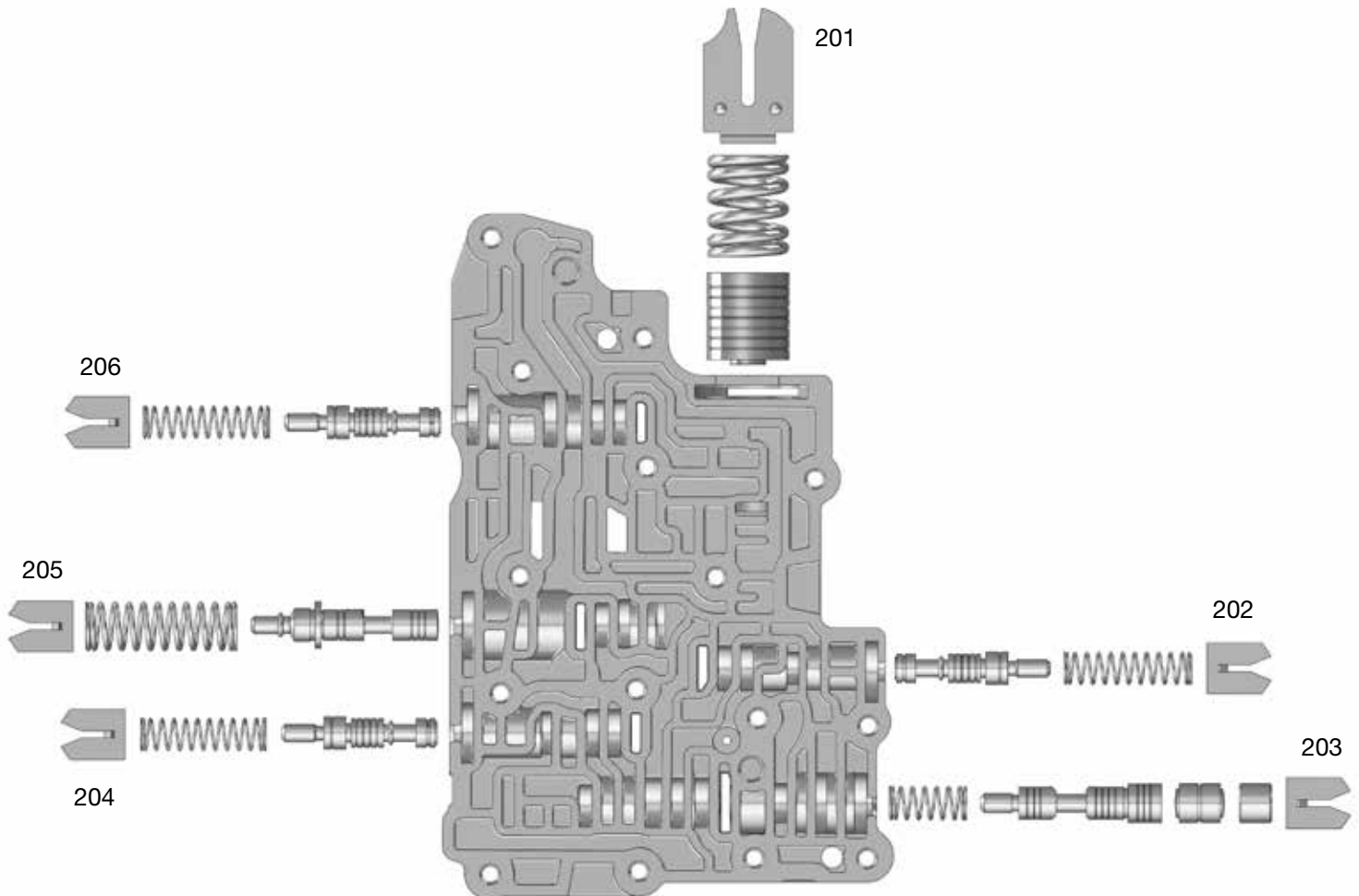

6T70 (Gen. 2) Lower Valve Body Descriptions

I.D. No.	Description
201	4-5-6 Clutch Accumulator Piston
202	1-2-3-4 Clutch Boost Valve
203	1-2-3-4 Clutch Regulator Valve
204	4-5-6 Clutch Boost Valve
205	Actuator Feed Limit Valve
206	3-5-Reverse Clutch Boost Valve