

# Critical Wear Areas & Vacuum Test Locations



**NOTE:** OE valves are shown in rest position and should be tested in rest position unless otherwise indicated. Test locations are pointed to with an arrow. Springs are not shown for visual clarity. Low vacuum reading indicates wear and Sonnax parts are noted for replacement.

## Lower Valve Body • JF016E Shown



For specific vacuum test information, refer to individual part instructions included in kits and available at [www.sonnax.com](http://www.sonnax.com).

Click on Sonnax part numbers to see more information.

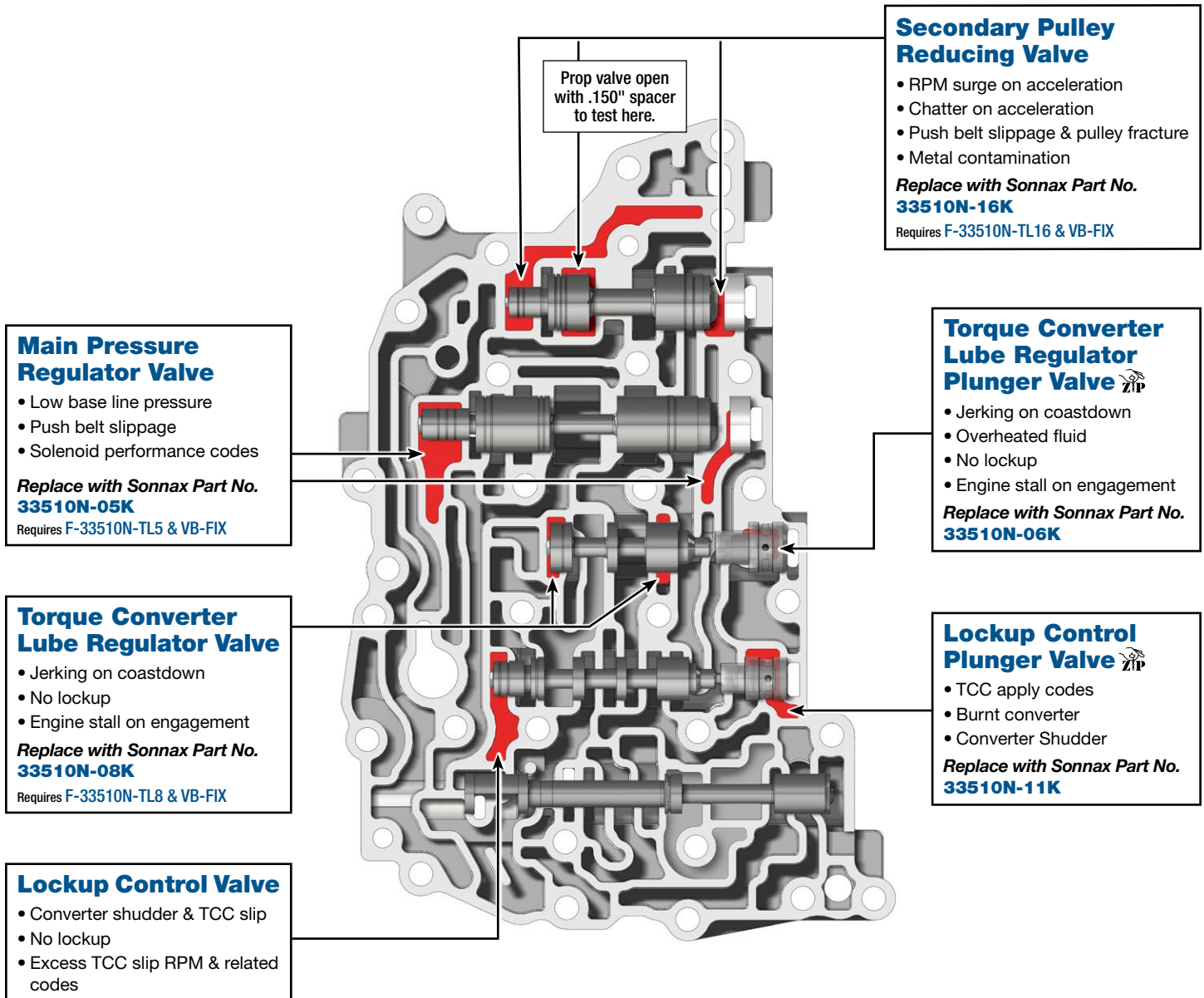

## Critical Wear Areas & Vacuum Test Locations



Drop-In Zip Valve™  
Parts Available

**NOTE:** OE valves are shown in rest position and should be tested in rest position unless otherwise indicated. Test locations are pointed to with an arrow. Springs are not shown for visual clarity. Low vacuum reading indicates wear and Sonnax parts are noted for replacement.

### Upper Valve Body • JF016E Shown



For specific vacuum test information, refer to individual part instructions included in kits and available at [www.sonnax.com](http://www.sonnax.com).

Click on Sonnax part numbers to see more information.

#### Primary Pulley Reducing Valve

- Chatter on acceleration
- High or low line pressure
- Pulley breakage
- Slips in Forward & Reverse

Replace with Sonnax Part No.

**33510N-03K** (JF016E)

Requires F-33510N-TL3 & VB-FIX or

**33510N-04K** (JF017E)

Requires F-33510N-TL4 & VB-FIX

#### Pilot Valve A

- Low solenoid feed pressure
- Solenoid performance codes

#### Pilot Valve B

- Low solenoid feed pressure
- TCC slip codes

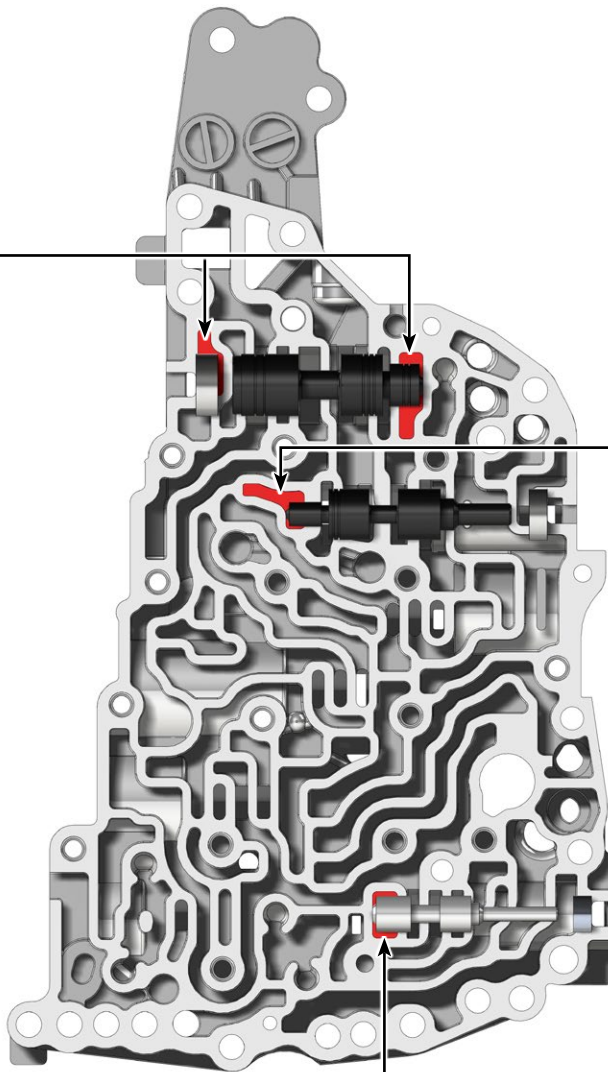

## OE Exploded View

### Lower Valve Body • JF016E Shown

**NOTE:** Depending upon vehicle application, the OE springs shown may not be present.

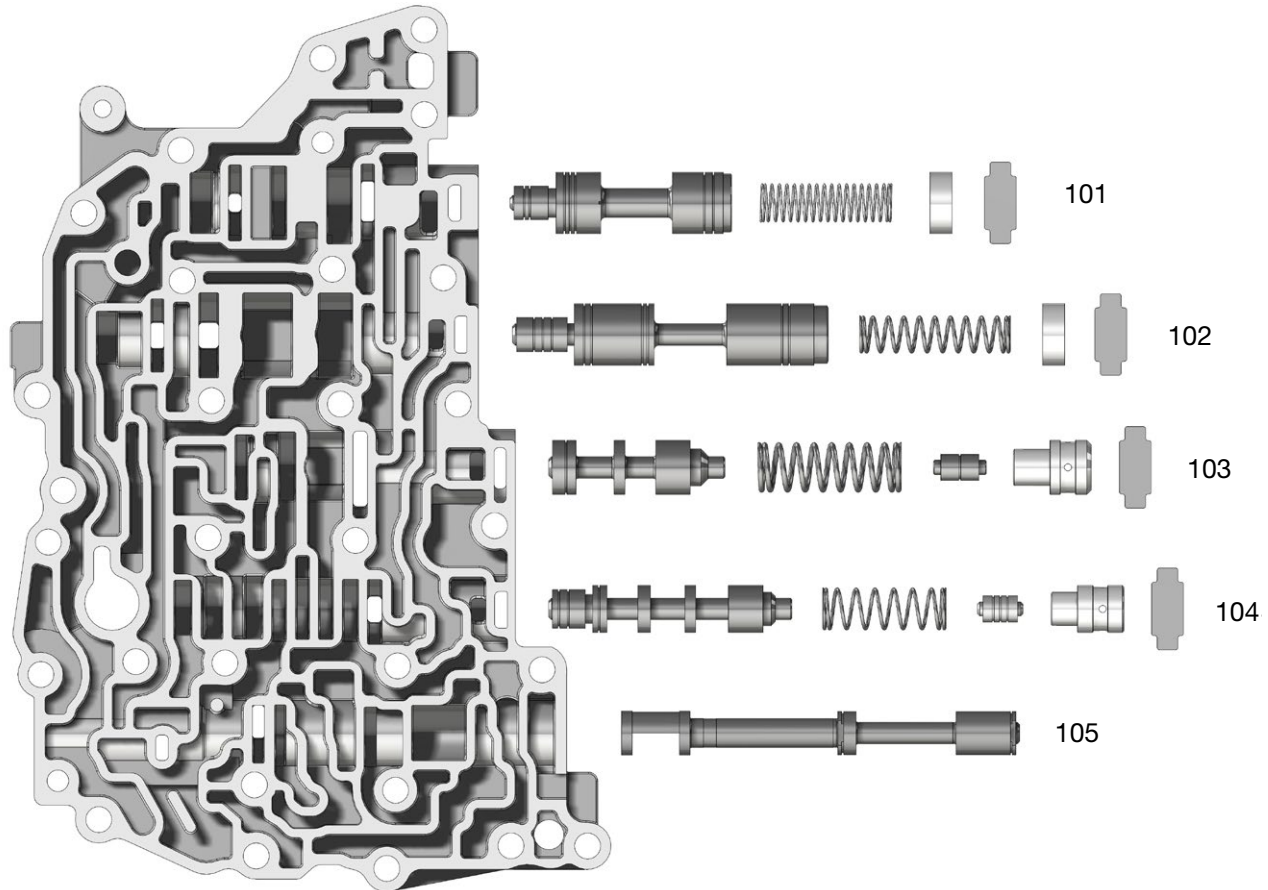

#### JF016E, JF017E Valve Body Descriptions

I.D. No.	Description
101	Secondary Pulley Reducing Valve
102	Main Pressure Regulator Valve
103	Torque Converter Lube Regulator Valve
104	Lockup Control Valve
105	Manual Valve

## OE Exploded View

### Upper Valve Body • JF016E Shown

**NOTE:** Depending upon vehicle application, the OE springs shown may not be present.

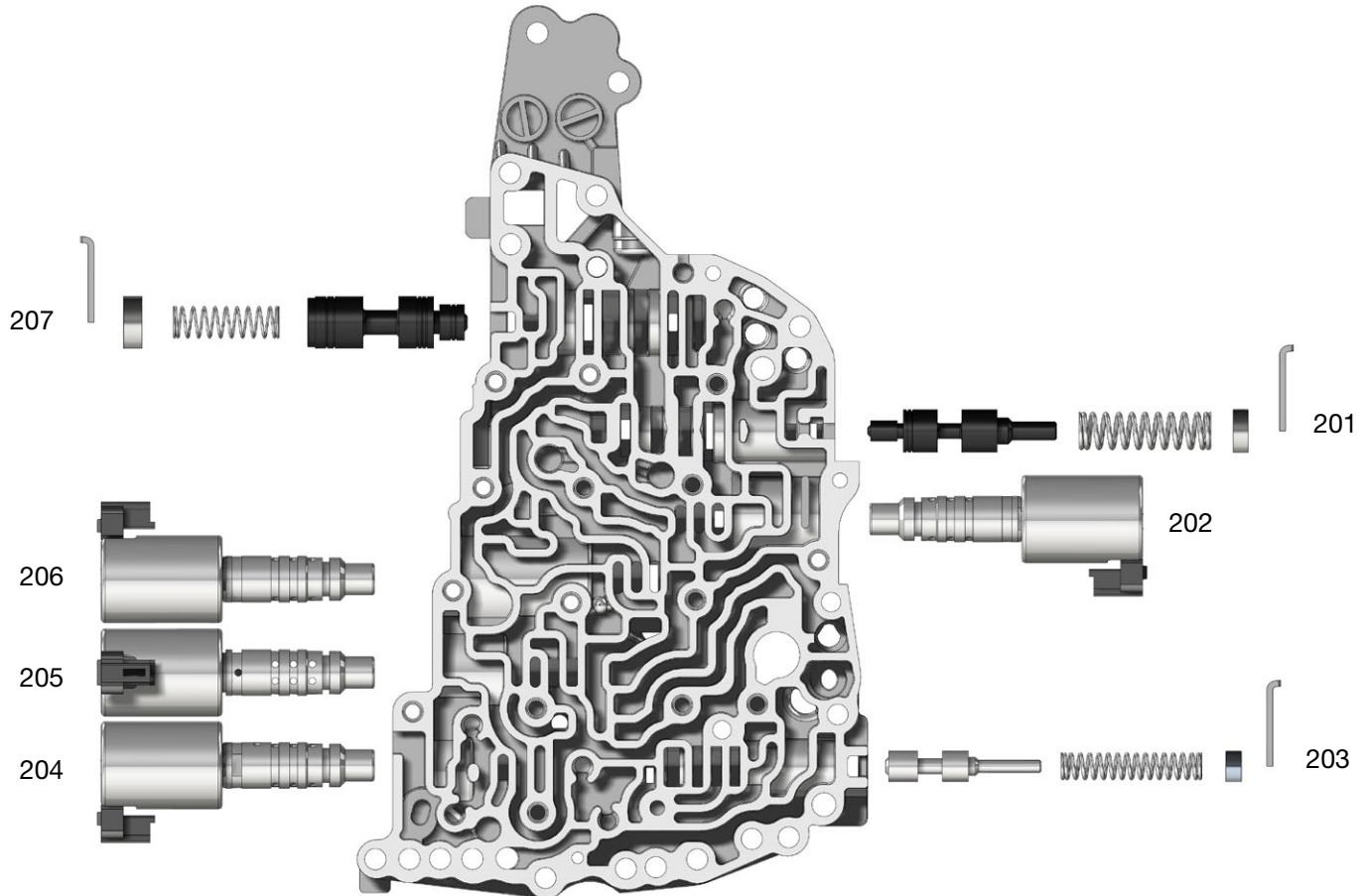

#### JF016E, JF017E Valve Body Descriptions

I.D. No.	Description
201	Pilot Valve A
202	Primary Pulley Solenoid Valve
203	Pilot Valve B
204	Select Solenoid Valve
205	Line Pressure Solenoid Valve
206	Secondary Pulley Solenoid Valve
207	Primary Pulley Reducing Valve