

GM 4L80-E, 4L85-E

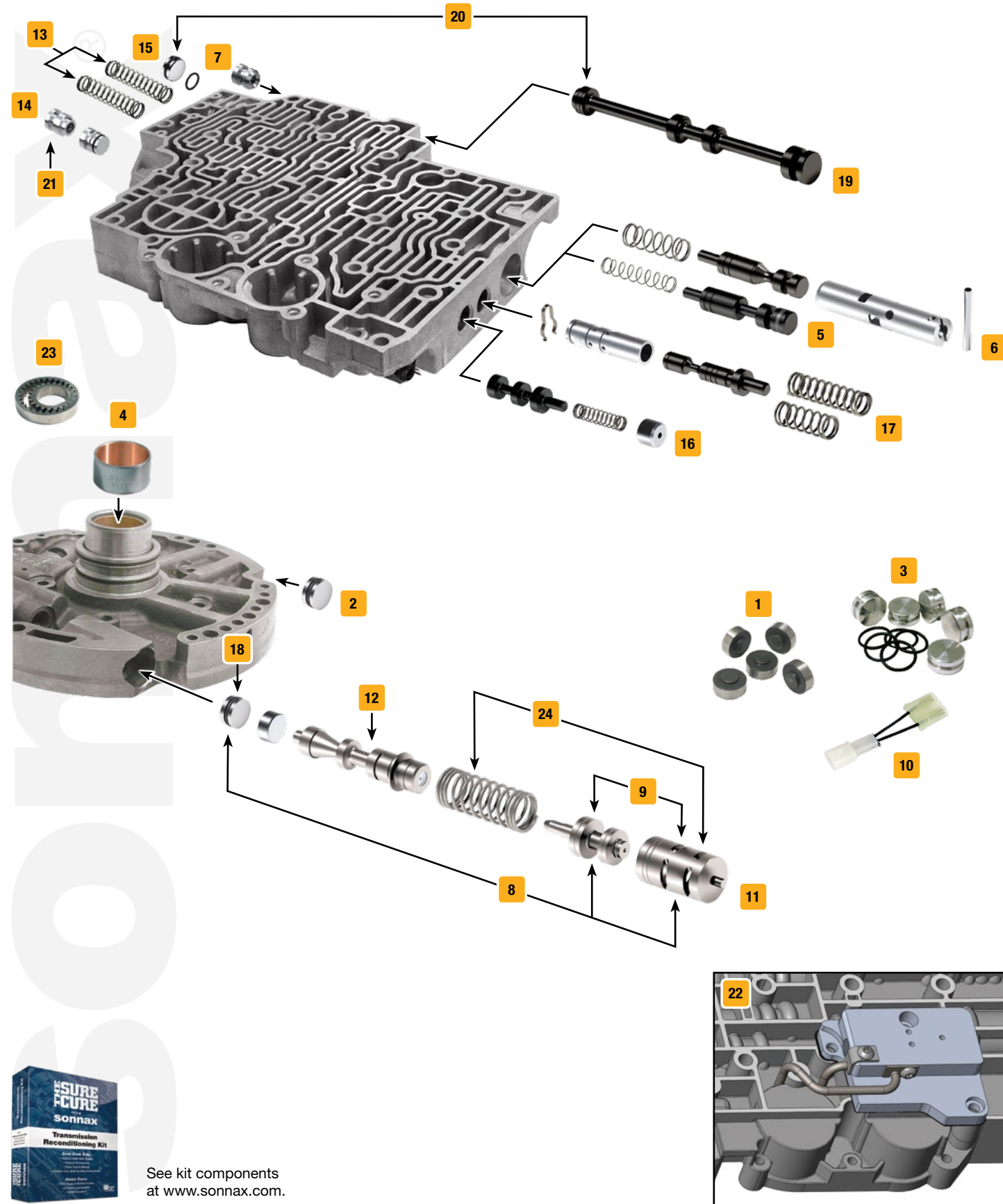

Click on part numbers for product details or visit www.sonnax.com to see all products for the unit(s) shown here.



See kit components at www.sonnax.com.

Symptoms/Part Type	Product Name	Part No.	Details	Tooling
Multiple Symptoms				
Comprehensive kit for big problems you don't want back.	The Sure Cure® Kit	SC-4L80E	42RH/RE only	
TCC/Lockup Symptoms				
No converter apply, 1-2, 2-3, 4-5 Flares	End Plug Kit	1 34994-11	4L80-E, 4L85-E only, fits TCC valve bore with .500" dia., includes 5 end plugs	
No converter apply, Burnt converter	O-Ringed End Plug Kit	2 34994-13	4L80-E, 4L85-E only, fits TCC shift valve bore, .497" dia., includes 5 end plugs	
No converter apply, 1-2, 2-3, 4-5 Flares	O-Ringed End Plug Kit	3 34994-14K	4L80-E, 4L85-E only, fits TCC valve bores with .668" dia., includes 5 end plugs	
TCC slip codes, No lockup, Overheated fluid, No Overdrive	Stator Support Bushing	4 34016-W	4L80-E, 4L85-E only, wider than OE, precision, 4/bag	
TCC codes, TCC apply & release concerns, Converter shudder, Burnt converter	TCC Regulator Valve Kit	5 34994-01K	4L80-E, 4L85-E only	
	Oversized TCC Regulator Valve Kit	6 34994-18K	4L80-E, 4L85-E only	F-34994-TL18*
Pressure Problems				
Burnt Reverse band, Delayed Reverse, No Reverse, No engine braking in manual low	#7 Low/Reverse Checkball Seat	7 34200-52	4L80-E, 4L85-E only, '95-later, 5/bag	
	Boost Valve Kit	8 34200-01K	4L80-E, 4L85-E only, O-ring style	
	Boost Valve Kit	8 34200-03K	4L80-E, 4L85-E only, factory style	
	Boost Valve Kit	9 34200-10K	4L80-E, 4L85-E only, with encapsulated relief valve, O-ring style	
Line pressure instability	EPC Solenoid Harness Adapter	10 34435-01K	4L80-E, 4L85-E only, for use with early-style ('92-'02) EPC solenoid in late-style ('03-later) units	
Engine surge at idle, Low cooler flow	Oversized Line-to-Lube Pressure Regulator & Boost Valve Kit	11 34200-36K	4L80-E, 4L85-E only, '99-later	F-34200-TL36*
Engine surge at idle, Low cooler flow, Low TCC release pressure	Lube Regulated Pressure Regulator Valve	12 34200-14K	4L80-E, 4L85-E only	
Shift/Engagement Concerns				
Repeated Solenoid B code 86, Repeated Solenoid B code 87, 2nd Gear starts, No 3rd/4th	1-2 & 2-3 Shift Valve Spring Kit	13 34994-02K	4L80-E, 4L85-E only	
3rd Slip, 4th Slip, Gear ratio codes, Direct clutch burned, Reverse slip	3rd & Reverse Checkball Sleeve Kit	14 34200-47K	4L80-E, 4L85-E only, '95-later	
Broken AFL filters, 2nd Gear starts, Leaking AFL end plug, Code 68, 85, 86, 87, No upshifts	AFL Filter End Plug & O-Ring Kit	15 34994-17K	4L80-E, 4L85-E only	
Soft shift & low accumulator pressure, High line pressure in Drive	Oversized Accumulator Control Valve Kit	16 34994-22K	4L80-E, 4L85-E only, upgrades '91-'96 units to '97 calibration	F-34994-TL22*
Wrong gear starts, Clutch failure, No 4th, Solenoid performance codes, Band failure	Actuator Feed Limit Valve Kit	17 34200-16K	4L80-E, 4L85-E only	77754-TL
Pressure loss, TCC apply concerns, Burnt clutches, Harsh shifts, Soft shifts	O-Ringed End Plug Kit	18 34200-05K	4L80-E, 4L85-E only, fits TCC & PR bores, includes 5 end plugs with .625" dia.	
Bent valves, Low line rise, Delayed engagement, Gear loss	Manual Valve	19 34994-16	4L80-E, 4L85-E only	
Bent valves, Low line rise, Broken AFL filters, Delayed engagement, Gear loss, 2nd Gear starts	Manual Valve Kit	20 34994-16K	4L80-E, 4L85-E only	
Reverse slip, Gear ratio codes, 3rd Slip, 4th Slip, Direct clutch burned, No Reverse	Reverse Checkball Sleeve	21 34200-38	4L80-E, 4L85-E only, '95-later, 4/bag	
Component Damage/Failure				
OD roller clutch failure, No Forward, Overrun clutch distress	Smart-Tech® Overrun Clutch Valve Kit	22 34200-40K	4L80-E, 4L85-E, '97-later only	
Lost or damaged component	Pump Gear Set	23 34201E-SP	4L80-E, 4L85-E only	
High Performance/Heavy Duty Upgrades				
Classic, large-ratio boost valve for crisp, clean shifts without harshness.	Line Pressure Booster Kit	24 4L80E-LB1	4L80-E, 4L85-E only	
Tools				
	Vacuum Test Plate Kit	34994-VTP		VACTEST-01K