

Click on part numbers for product details or visit [www.sonnax.com](http://www.sonnax.com) to see all products for the unit(s) shown here.

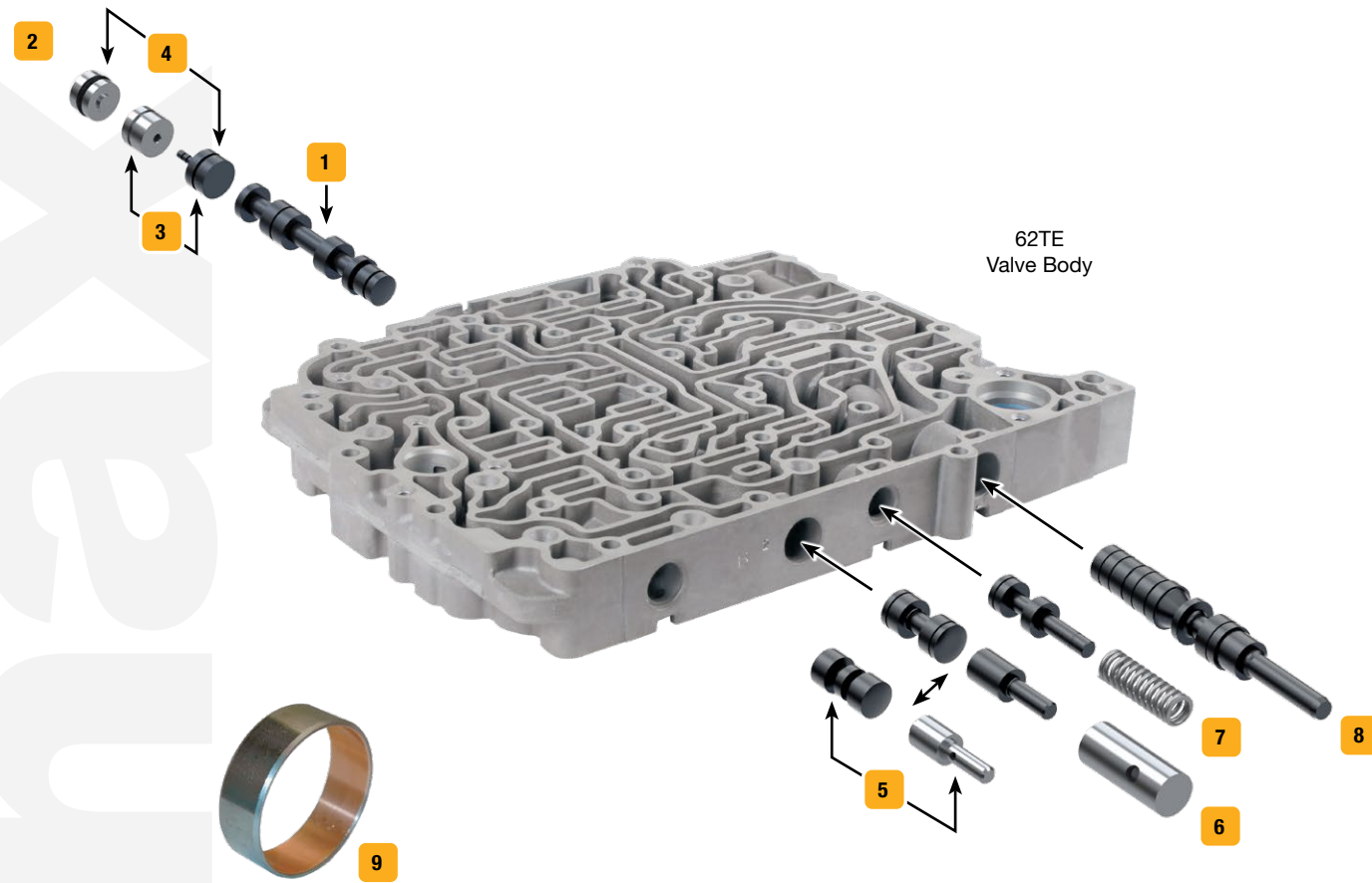

Symptoms/Part Type	Product Name	Part No.	Details	Tooling
<b>TCC/Lockup Symptoms</b>				
4th Clutch burned, Bind-up, Codes 841, 868, 871, 988, 1775, 1776, Failsafe mode	Oversized Solenoid Switch Valve	1 92835-21	Fits bores containing OE switch valve with .420" dia. large spool only	F-92835-TL*
Codes 841, 868, 871, 988, 1775, 1776, OD clutch burned, Failsafe mode, Bind-up	Oversized Solenoid Switch Valve & Plug Kit	2 92835-32K	Fits bores containing OE switch valve w/ .420" dia. large spool only	F-92835-TL32*, 92835-BST †
	Solenoid Switch Valve Plug Kit	3 92835-02K	ZIP Fits bores containing OE switch valve with .420" dia. large spool only	
	Solenoid Switch Valve Plug Kit	3 92835-39K	ZIP Fits bores containing OE switch valve with .453" dia. large spool with I.D. groove	
Low/Reverse switch code, 2nd Gear starts, Erratic TCC apply, No lockup	Oversized Solenoid Switch Valve Plug Kit	4 92835-18K	Fits bores containing OE switch valve w/ .420" dia. large spool only, tool kit F-92835-TL18 required.	92835-RM, F-92835-TL18*
Converter shudder & failure, TCC lockup surge, TCC deflection & lining failure	TCC Control & Plunger Kit	5 92835-03K	ZIP	
Excess TCC slip, TCC shudder, TCC codes, Overheated fluid & TCC lining, Loss of fuel economy	Oversized TCC Control & Plunger Valve Kit	6 92835-33K		F-92835-TL33*
Damaged converter, TCC codes, No TCC release, Excess converter pressure	Oversized TCC Regulator Valve Kit	7 92835-37K		F-92835-TL37*
<b>Pressure Problems</b>				
Shift concerns, Low line pressure, High line pressure, Erratic TCC apply	Oversized Pressure Regulator Valve	8 92835-29		F-92835-TL29*
Pump seal leakage, Pump noise, Loss of prime, Low pump volume, Low cooler flow, TCC codes	Pump Bushing	9 12502-01	Precision, 5/bag	

\* VB-FIX Required

† Recommended Tool